

Socket

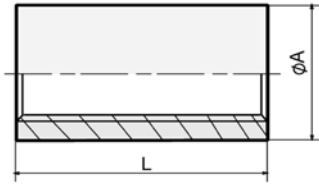

ISO 228-1G
EN ISO 4144



Inch	DN	L mm	ØA mm	Art. no.	4308 (304)	4408 (316)
1/8"	6	18,0	16,0	TB01	○	●
1/4"	8	26,0	19,5	TB01	●	●
3/8"	10	27,0	22,3	TB01	●	●
1/2"	15	34,0	27,7	TB01	●	●
3/4"	20	36,0	33,6	TB01	●	●
1"	25	43,0	39,5	TB01	●	●
1.1/4"	32	48,0	48,3	TB01	●	●
1.1/2"	40	48,0	54,6	TB01	●	●
2"	50	56,0	66,3	TB01	●	●
2.1/2"	65	65,0	82,0	TB01	○	○
3"	80	71,0	100,5	TB01	○	○
4"	100	83,0	122,0	TB01	○	○

Socket from pipe

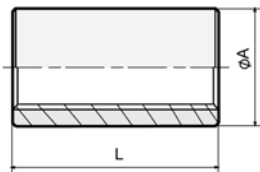

ISO 228-1G



Inch	DN	L mm	ØA mm	Art. no.	304L	316L
1/8"	6	18	14	TB03	○	●
1/4"	8	25	18,52	TB03	●	●
3/8"	10	26	21,3	TB03	●	●
1/2"	15	34	26,4	TB03	●	●
3/4"	20	36	31,8	TB03	●	●
1"	25	43	39,5	TB03	●	●
1.1/4"	32	48	48,3	TB03	●	●
1.1/2"	40	48	54,5	TB03	●	●
2"	50	56	66,3	TB03	●	●
2.1/2"	65	65	82	TB03	○	●
3"	80	81	95	TB03	○	●
4"	100	83	122	TB03	○	●

- = stock
- = ex works

Half socket

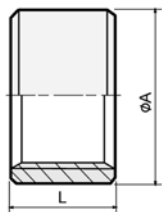

ISO 228-1G
EN ISO 4144



Inch	DN	L mm	ØA mm	Art. no.	4308 (304)	4408 (316)
1/8"	6	18	14	TB02	○	●
1/4"	8	25	18,52	TB02	●	●
3/8"	10	26	21,3	TB02	●	●
1/2"	15	34	26,4	TB02	●	●
3/4"	20	36	31,8	TB02	●	●
1"	25	43	39,5	TB02	●	●
1.1/4"	32	48	48,3	TB02	●	●
1.1/2"	40	48	54,5	TB02	●	●
2"	50	56	66,3	TB02	●	●
2.1/2"	65	65	82	TB02	○	○
3"	80	81	95	TB02	○	○
4"	100	83	122	TB02	○	○

Half socket from pipe

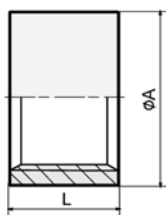

ISO 228-1G



Inch	DN	L mm	ØA mm	Art. no.	304L	316L
1/8"	6	10	14	TB04	○	●
1/4"	8	11	18,52	TB04	●	●
3/8"	10	12	21,3	TB04	●	●
1/2"	15	15	26,4	TB04	●	●
3/4"	20	18	31,8	TB04	●	●
1"	25	20	39,5	TB04	●	●
1.1/4"	32	22	48,3	TB04	●	●
1.1/2"	40	22	54,5	TB04	●	●
2"	50	26	66,3	TB04	●	●
2.1/2"	65	31	82	TB04	○	●
3"	80	34	95	TB04	○	●
4"	100	39	122	TB04	○	●

- = stock
- = ex works

Welding nipple from pipe

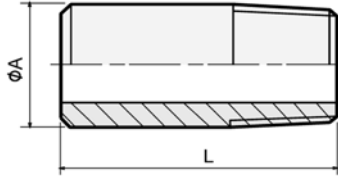

ISO 7-1R



Inch	1/8"	1/4"	3/8"	1/2"	3/4"	1"	1.1/4"	1.1/2"	2"	2.1/2"	3"	4"	5"	6"
DN	6	8	10	15	20	25	32	40	50	65	80	100	125	150
ØA	10	13,5	17,2	21,3	26,9	33,7	42,4	48,3	60,3	76	89	114	140	168
tp	316L	316L	316L	316L	316L	316L	316L	316L	316L	316L	316L	316L	316L	316L
L = 30mm	●	● + 304L	● + 304L	●	○	○	○							
L = 35mm	○	○	○	● + 304L	○	○	○							
L = 40mm	○	●	●	●	● + 304L	● + 304L	○	○						
L = 50mm	○	●	●	●	●	●	● + 304L	● + 304L	● + 304L	○				
L = 60mm	○	●	●	●	●	●	●	●	●	●	○			
L = 70mm	○	●	●	●	●	●	●	●	●	○	○	○		
L = 80mm	○	●	●	●	●	●	●	●	●	○	○	○	○	
L = 90mm	○	●	●	●	●	●	●	●	●	○	○	○	○	○
L = 100mm	○	●	●	●	●	●	●	●	●	○	○	○	○	○
L = 110mm	○	●	●	●	●	●	●	●	●	○	○	○	○	○
L = 120mm	○	●	●	●	●	●	●	●	●	○	○	○	○	○
L = 130mm	○	●	●	●	●	●	●	●	●	○	○	○	○	○
L = 140mm	○	●	●	●	●	●	●	●	●	○	○	○	○	○
L = 150mm	○	●	●	●	●	●	●	●	●	○	○	○	○	○
L = 160mm	○	●	●	●	●	●	●	●	●	○	○	○	○	○
L = 170mm	○	●	●	●	●	●	●	●	●	○	○	○	○	○
L = 180mm	○	●	●	●	●	●	●	●	●	○	○	○	○	○
L = 190mm	○	●	●	●	●	●	●	●	●	○	○	○	○	○
L = 200mm	○	●	●	●	●	●	●	●	●	○	○	○	○	○
L = 210mm	○	●	●	●	●	●	●	●	●	○	○	○	○	○
L = 220mm	○	●	●	●	●	●	●	●	●	○	○	○	○	○
L = 230mm	○	●	●	●	●	●	●	●	●	○	○	○	○	○
L = 240mm	○	●	●	●	●	●	●	●	●	○	○	○	○	○
L = 250mm	○	●	●	●	●	●	●	●	●	○	○	○	○	○
L = 260mm	○	●	●	●	●	●	●	●	●	○	○	○	○	○
L = 270mm	○	●	●	●	●	●	●	●	●	○	○	○	○	○
L = 280mm	○	●	●	●	●	●	●	●	●	○	○	○	○	○
L = 290mm	○	●	●	●	●	●	●	●	●	○	○	○	○	○
L = 300mm	○	●	●	●	●	●	●	●	●	○	○	○	○	○

● = stock
○ = ex works

Barrel nipple from tube

ISO 7-1R

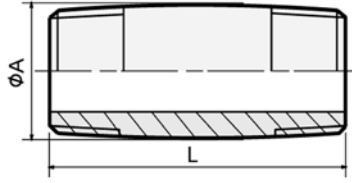

inch	1/8"	1/4"	3/8"	1/2"	3/4"	1"	1.1/4"	1.1/2"	2"	2.1/2"	3"	4"	5"	6"
DN	6	8	10	15	20	25	32	40	50	65	80	100	125	150
øA	10,2	13,5	17,2	21,3	26,9	33,7	42,4	48,3	60,3	76,1	89	114	140	168
tp	316L	316L	316L	316L	316L	316L	316L	316L	316L	316L	316L	316L	316L	316L
L = 30mm	○	●	○	●	○	○								
L = 35mm	○	○	○	○	○	○								
L = 40mm	●	●+304L	●+304L	●	●	●	○	○						
L = 50mm	○	●	●	●	●	●	●	●	○					
L = 60mm	○	●	●	●+304L	●+304L	●+304L	●	●	●	○				
L = 70mm	○	●	●	●	●	●	●	●	●	○	○			
L = 80mm	○	●	●	●	●	●	●+304L	●+304L	●	○	○	○		
L = 90mm	○	●	●	●	●	●	●	●	●	○	○	○		
L = 100mm	○	●	●	●	●	●	●	●	●+304L	●	○	○		
L = 110mm	○	●	●	●	●	●	●	●	●	○	○	○		
L = 120mm	○	●	●	●	●	●	●	●	●	○	●	●	○	○
L = 130mm	○	●	●	●	●	●	●	●	●	○	○	○	○	○
L = 140mm	○	●	●	●	●	●	●	●	●	○	○	○	○	○
L = 150mm	○	●	●	●	●	●	●	●	●	○	○	○	○	○
L = 160mm	○	●	●	●	●	●	●	●	●	○	○	○	○	○
L = 170mm	○	●	●	●	●	●	●	●	●	○	○	○	○	○
L = 180mm	○	●	●	●	●	●	●	●	●	○	○	○	○	○
L = 190mm	○	●	●	●	●	●	●	●	●	○	○	○	○	○
L = 200mm	○	●	●	●	●	●	●	●	●	○	○	○	○	○
L = 210mm	○	●	●	●	●	●	●	●	●	○	○	○	○	○
L = 220mm	○	●	●	●	●	●	●	●	●	○	○	○	○	○
L = 230mm	○	●	●	●	●	●	●	●	●	○	○	○	○	○
L = 240mm	○	●	●	●	●	●	●	●	●	○	○	○	○	○
L = 250mm	○	●	●	●	●	●	●	●	●	○	○	○	○	○
L = 260mm	○	●	●	●	●	●	●	●	●	○	○	○	○	○
L = 270mm	○	●	●	●	●	●	●	●	●	○	○	○	○	○
L = 280mm	○	●	●	●	●	●	●	●	●	○	○	○	○	○
L = 290mm	○	●	●	●	●	●	●	●	●	○	○	○	○	○
L = 300mm	○	●	●	●	●	●	●	●	●	○	○	○	○	○

● = stock
○ = ex works

Parallel nipple from tube

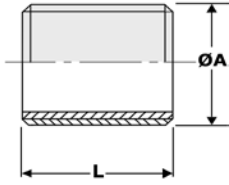

ISO 228



Inch	DN	L mm	ØA mm	Art. no.	304L	316L
1/8"	6	16	10,2	TB08	○	●
1/4"	8	18	13,5	TB08	○	●
3/8"	10	22	18,2	TB08	○	●
1/2"	15	25	21,3	TB08	○	●
3/4"	20	30	26,9	TB08	○	●
1"	25	35	33,8	TB08	○	●
1.1/4"	32	38	42,4	TB08	○	●
1.1/2"	40	38	48,3	TB08	○	●
2"	50	45	60,3	TB08	○	●
2.1/2"	65	55	86,1	TB08	○	○
3"	80	60	88,9	TB08	○	○
4"	100	80	114,3	TB08	○	○

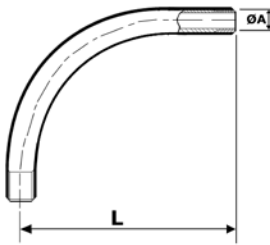

Bend M / M from tube

ISO 228



Inch	DN	L mm	ØA mm	Art. no.	304L	316L
1/8"	6	50	10,2	TB10	○	●
1/4"	8	60	13,5	TB10	○	●
3/8"	10	80	18,2	TB10	○	●
1/2"	15	80	21,3	TB10	○	●
3/4"	20	100	26,9	TB10	○	●
1"	25	120	33,8	TB10	○	●
1.1/4"	32	140	42,4	TB10	○	●
1.1/2"	40	160	48,3	TB10	○	●
2"	50	190	60,3	TB10	○	●
2.1/2"	65	240	86,1	TB10	○	○
3"	80	290	88,9	TB10	○	○

- = stock
- = ex works

Hexagon nipple

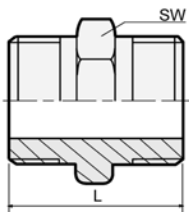

ISO 7-1R
EN ISO 4144



Inch	DN	L mm	SW mm	Art. no.	4308 (304)	4408 (316)
1/8"	6	23,6	12,0	TB11	○	●
1/4"	8	27,8	16,0	TB11	●	●
3/8"	10	28,0	19,0	TB11	●	●
1/2"	15	34,0	21,6	TB11	●	●
3/4"	20	40,0	30,0	TB11	●	●
1"	25	46,0	36,0	TB11	●	●
1.1/4"	32	52,5	46,0	TB11	●	●
1.1/2"	40	54,0	50,0	TB11	●	●
2"	50	62,0	64,5	TB11	●	●
2.1/2"	65	70,0	79,5	TB11	○	●
3"	80	78,4	90,0	TB11	○	●
4"	100	94,0	120,0	TB11	○	●

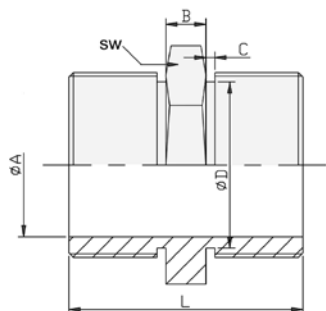

Hexagon nipple parallel thread

ISO 228
EN ISO 4144



Inch	DN	L mm	SW mm	A mm	B mm	ØC mm	ØD mm	Art. no.	4308 (304)	4408 (316)
1/8"	6	23,6	12,0	4,3	8,5	2,0	8,5	TB12	○	●
1/4"	8	27,8	16,0	7,0	11,4	3,0	11,4	TB12	○	●
3/8"	10	26	19,0	9,4	14,0	3,0	14,0	TB12	○	●
1/2"	15	35	21,6	13,7	18,0	4,0	18,0	TB12	○	●
3/4"	20	40	30,0	19,0	24,0	4,0	24,0	TB12	○	●
1"	25	46	36,0	25,5	30,0	4,0	30,0	TB12	○	●
1.1/4"	32	52,5	46,0	32,0	39,0	4,0	39,0	TB12	○	●
1.1/2"	40	54	50,0	38,5	45,0	4,0	45,0	TB12	○	●
2"	50	62	64,5	50,2	56,5	4,0	56,5	TB12	○	●
2.1/2"	65	70	79,5	63,8	72,0	4,0	72,0	TB12	○	○
3"	80	78,4	90,0	77,0	85,0	4,0	85,0	TB12	○	○
4"	100	94	120,0	102,0	110,0	4,0	110,0	TB12	○	○

- = stock
- = ex works

Elbow 45° F / F

ISO 228-1G
EN ISO 4144

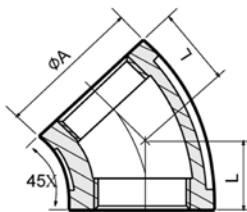

Inch	DN	ØA mm	L mm	Art. no.	4308 (304)	4408 (316)
1/8"	6	18,0	18,0	TB13	○	●
1/4"	8	21,0	19,4	TB13	○	●
3/8"	10	25,0	20,0	TB13	○	●
1/2"	15	29,5	22,0	TB13	○	●
3/4"	20	35,6	25,0	TB13	○	●
1"	25	43,0	28,0	TB13	○	●
1.1/4"	32	52,4	33,0	TB13	○	●
1.1/2"	40	58,0	36,0	TB13	○	●
2"	50	72,0	43,0	TB13	○	●
2.1/2"	65	87,0	50,0	TB13	○	●
3"	80	100,0	55,0	TB13	○	●
4"	100	125,5	64,0	TB13	○	●

Elbow 90° F / F

ISO 228-1G
EN ISO 4144

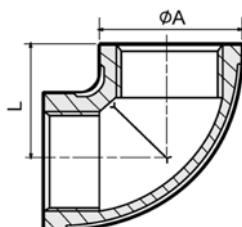

Inch	DN	ØA mm	L mm	Art. no.	4308 (304)	4408 (316)
1/8"	6	17,0	19,0	TB14	○	●
1/4"	8	21,3	21,0	TB14	●	●
3/8"	10	23,5	21,3	TB14	●	●
1/2"	15	29,0	27,0	TB14	●	●
3/4"	20	36,0	33,0	TB14	●	●
1"	25	43,0	38,0	TB14	●	●
1.1/4"	32	52,0	45,0	TB14	●	●
1.1/2"	40	58,5	50,0	TB14	●	●
2"	50	71,5	57,0	TB14	●	●
2.1/2"	65	87,0	69,7	TB14	○	●
3"	80	99,5	77,0	TB14	○	●
4"	100	126,0	98,2	TB14	○	●

- = stock
- = ex works

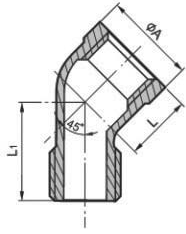

Elbow 90° M / F

ISO 7-1R / ISO 228-1G

EN ISO 4144



Inch	DN	ØA mm	L mm	L1 mm	Art. no.	4308 (304)	4408 (316)
1/8"	6	17	16	21	TB19	○	●
1/4"	8	21	17	23	TB19	○	●
3/8"	10	25	19	27	TB19	○	●
1/2"	15	29	21	31	TB19	○	●
3/4"	20	35	25	36	TB19	○	●
1"	25	43	29	42	TB19	○	●
1.1/4"	32	52	34	49	TB19	○	●
1.1/2"	40	58	37	51	TB19	○	●
2"	50	71	42	59	TB19	○	●
2.1/2"	65	88	49	71	TB19	○	●
3"	80	101	54	79	TB19	○	●
4"	100	129	65	96	TB19	○	●

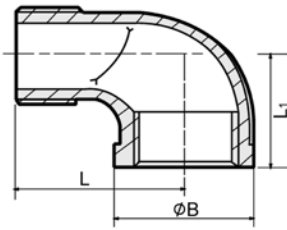

Elbow 90° M / F

ISO 7-1R / ISO 228-1G

EN ISO 4144



Inch	DN	ØB mm	L mm	L1 mm	Art. no.	4308 (304)	4408 (316)
1/8"	6	17,0	25,0	19,0	TB20	○	●
1/4"	8	21,0	28,3	21,0	TB20	●	●
3/8"	10	25,0	32,0	25,0	TB20	●	●
1/2"	15	29,0	42,0	28,0	TB20	●	●
3/4"	20	35,0	50,5	33,0	TB20	●	●
1"	25	43,0	52,0	39,0	TB20	●	●
1.1/4"	32	52,0	60,0	45,0	TB20	●	●
1.1/2"	40	58,8	65,0	50,0	TB20	●	●
2"	50	71,7	74,0	58,0	TB20	●	●
2.1/2"	65	88,2	99,0	69,0	TB20	○	●
3"	80	100,0	114,5	78,0	TB20	○	●
4"	100	126,5	146,5	97,0	TB20	○	●

- = stock
- = ex works

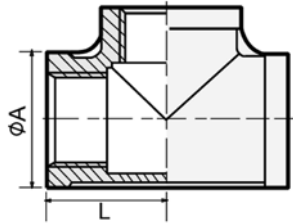

Equal tee

ISO 228-1G
EN ISO 4144



Inch	DN	ØA mm	L mm	Art. no.	4308 (304)	4408 (316)
1/8"	6	17,0	19,0	TB22	○	●
1/4"	8	21,3	21,0	TB22	●	●
3/8"	10	23,5	23,6	TB22	●	●
1/2"	15	30,0	28,0	TB22	●	●
3/4"	20	35,0	33,0	TB22	●	●
1"	25	43,0	38,0	TB22	●	●
1.1/4"	32	52,0	45,0	TB22	●	●
1.1/2"	40	58,5	50,0	TB22	●	●
2"	50	71,5	58,0	TB22	●	●
2.1/2"	65	87,0	70,0	TB22	○	●
3"	80	100,0	78,5	TB22	○	●
4"	100	125,0	97,0	TB22	○	●

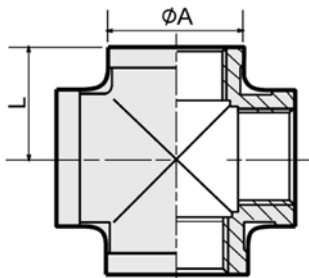

Cross

ISO 228-1G
EN ISO 4144



Inch	DN	ØA mm	L mm	Art. no.	4308 (304)	4408 (316)
1/8"	6	15,2	17,0	TB25	○	●
1/4"	8	19,7	18,5	TB25	○	●
3/8"	10	23,3	22,9	TB25	○	●
1/2"	15	28,0	26,8	TB25	○	●
3/4"	20	34,6	32,0	TB25	○	●
1"	25	43,6	37,5	TB25	○	●
1.1/4"	32	53,0	45,9	TB25	○	●
1.1/2"	40	58,0	47,6	TB25	○	●
2"	50	71,0	58,0	TB25	○	●
2.1/2"	65	87,0	70,0	TB25	○	●
3"	80	100,0	77,0	TB25	○	●
4"	100	126,0	97,0	TB25	○	●

- = stock
- = ex works

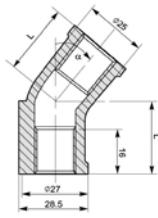

Elbow with bar F / F

ISO 228- 1G



Inch	DN	α	L mm	Art.no	4308 (304)	4408 (316)
1/2"	15	45°	22,8	TB15	●	●
1/2"	15	60°	25,6	TB16	●	●
1/2"	15	75°	28,5	TB17	●	●
1/2"	15	90°	27,7	TB18	●	●

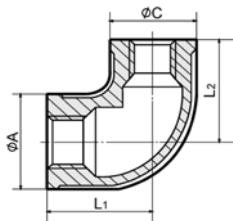

Reducing elbow 90° F / F

ISO 228- 1G

EN ISO 4144



Inch	inch	DN	DN	$\varnothing A$ mm	$\varnothing C$ mm	L1 mm	L2 mm	Art. no.	4308 (304)	4408 (316)
1/4"	1/8"	8	6	19,0	15,5	18,5	18,5	TB21	○	●
3/8"	1/8"	10	6	22,5	15,5	19,5	20,5	TB21	○	●
3/8"	1/4"	8	8	22,5	19,0	20,5	22,5	TB21	○	●
1/2"	1/8"	15	6	27,5	15,5	22,5	23,5	TB21	○	●
1/2"	1/4"	15	8	27,5	19,0	24,5	24,5	TB21	○	●
1/2"	3/8"	15	10	27,5	22,5	26,5	25,5	TB21	○	●
3/4"	1/4"	20	8	33,0	19,0	27,5	26,5	TB21	○	●
3/4"	3/8"	20	10	33,0	22,5	28,5	28,5	TB21	○	●
3/4"	1/2"	20	15	33,0	27,5	29,5	30,5	TB21	○	●
1"	1/4"	25	8	40,5	19,0	28,5	30,5	TB21	○	●
1"	3/8"	25	10	40,5	22,5	30,5	32,0	TB21	○	●
1"	1/2"	25	15	40,5	27,5	32,5	33,5	TB21	○	●
1"	3/4"	25	20	40,5	33,0	34,5	35,5	TB21	○	●
1.1/4"	3/8"	32	10	50,0	22,5	34,0	36,5	TB21	○	●
1.1/4"	1/2"	32	15	50,0	27,5	36,5	38,5	TB21	○	●
1.1/4"	3/4"	32	20	50,0	33,0	38,5	40,5	TB21	○	●
1.1/4"	1"	32	25	50,0	40,5	40,5	42,5	TB21	○	●
1.1/2"	3/8"	40	10	56,5	22,5	34,0	40,0	TB21	○	●
1.1/2"	1/2"	40	15	56,5	27,5	36,0	41,5	TB21	○	●
1.1/2"	3/4"	40	20	56,5	33,0	38,5	43,5	TB21	○	●
1.1/2"	1"	40	25	56,5	40,5	41,5	45,5	TB21	○	●
1.1/2"	1.1/4"	40	32	56,5	50,0	45,5	48,5	TB21	○	●
2"	1/2"	50	15	70,0	27,5	42,0	51,5	TB21	○	●
2"	3/4"	50	20	70,0	33,0	44,0	52,5	TB21	○	●
2"	1"	50	25	70,0	40,5	46,5	53,5	TB21	○	●
2"	1.1/4"	50	32	70,0	50,0	48,5	54,5	TB21	○	●
2"	1.1/2"	50	40	70,0	56,5	52,5	55,5	TB21	○	●

- = stock
- = ex works

Reducing tee F / F / F

ISO 228-1G

EN ISO 4144

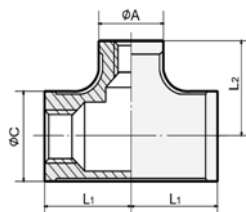

Inch	inch	DN	DN	ØA mm	ØC mm	L1 mm	L2 mm	Art. no.	4308 (304)	4408 (316)
1/4"	1/8"	8	6	17.0	21.0	18.0	19.0	TB24	○	●
3/8"	1/8"	10	6	17.0	23.0	19.0	21.0	TB24	○	●
3/8"	1/4"	8	8	21.0	23.0	20.0	22.0	TB24	○	●
1/2"	1/8"	15	6	17.0	29.0	22.0	23.0	TB24	○	●
1/2"	1/4"	15	8	20.8	29.0	24.0	24.0	TB24	○	●
1/2"	3/8"	15	10	23.5	29.0	26.0	25.0	TB24	○	●
3/4"	1/4"	20	8	20.8	36.0	25.0	28.0	TB24	○	●
3/4"	3/8"	20	10	23.3	36.0	28.0	28.0	TB24	○	●
3/4"	1/2"	20	15	30.0	37.0	30.0	32.0	TB24	○	●
1"	1/4"	25	8	20.8	44.0	30.0	31.0	TB24	○	●
1"	3/8"	25	10	23.3	44.0	30.0	31.0	TB24	○	●
1"	1/2"	25	15	30.5	44.0	32.0	33.4	TB24	○	●
1"	3/4"	25	20	35.8	44.0	35.0	35.0	TB24	○	●
1.1/4"	3/8"	32	10	23.3	51.4	32.0	36.0	TB24	○	●
1.1/4"	1/2"	32	15	28.8	51.4	34.0	38.0	TB24	○	●
1.1/4"	3/4"	32	20	35.8	51.4	38.0	40.0	TB24	○	●
1.1/4"	1"	32	25	43.3	51.4	40.0	42.0	TB24	○	●
1.1/2"	3/8"	40	10	23.3	57.9	34.0	40.0	TB24	○	●
1.1/2"	1/2"	40	15	28.8	57.9	35.0	42.0	TB24	○	●
1.1/2"	3/4"	40	20	35.8	57.9	38.0	43.0	TB24	○	●
1.1/2"	1"	40	25	43.3	57.9	41.0	45.0	TB24	○	●
1.1/2"	1.1/4"	40	32	51.4	57.9	45.0	48.0	TB24	○	●
2"	1/2"	50	15	28.8	71.0	38.0	48.0	TB24	○	●
2"	3/4"	50	20	35.8	71.0	41.0	49.0	TB24	○	●
2"	1"	50	25	43.3	71.0	44.0	51.0	TB24	○	●
2"	1.1/4"	50	32	51.4	71.0	48.0	54.0	TB24	○	●
2"	1.1/2"	50	40	57.9	71.0	52.0	55.0	TB24	○	●

- = stock
- = ex works

Union conical F / F

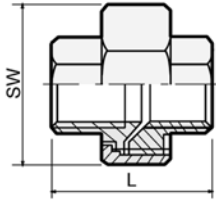

ISO 228-1G
EN ISO 4144



Inch	DN	L mm	SW mm	Art. no.	4308 (304)	4408 (316)
1/8"	6	29,0	25,0	TB26	○	●
1/4"	8	37,5	30,0	TB26	●	●
3/8"	10	38,0	35,0	TB26	●	●
1/2"	15	42,0	42,0	TB26	●	●
3/4"	20	50,4	47,0	TB26	●	●
1"	25	48,0	53,0	TB26	●	●
1.1/4"	32	59,0	71,0	TB26	●	●
1.1/2"	40	65,0	78,0	TB26	●	●
2"	50	69,0	92,0	TB26	●	●
2.1/2"	65	80,0	112,0	TB26	○	●
3"	80	88,0	127,0	TB26	○	●
4"	100	108,0	157,0	TB26	○	●

Union conical M / F

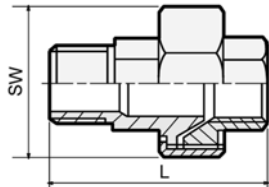

ISO 7-1R / ISO 228-1G
EN ISO 4144



Inch	DN	L mm	SW mm	Art. no.	4308 (304)	4408 (316)
1/8"	6	40,0	25,0	TB28	○	●
1/4"	8	50,0	30,0	TB28	●	●
3/8"	10	50,0	35,0	TB28	●	●
1/2"	15	58,0	42,0	TB28	●	●
3/4"	20	67,0	47,0	TB28	●	●
1"	25	68,3	53,0	TB28	●	●
1.1/4"	32	83,0	71,0	TB28	●	●
1.1/2"	40	86,3	78,0	TB28	●	●
2"	50	94,0	92,0	TB28	●	●
2.1/2"	65	113,3	112,0	TB28	○	●
3"	80	127,0	126,0	TB28	○	●
4"	100	154,5	157,0	TB28	○	●

- = stock
- = ex works

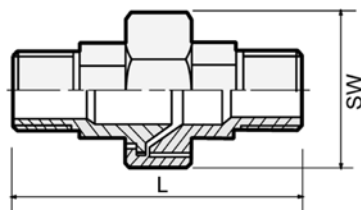

Union conical M / M

ISO 7-1R
EN ISO 4144



Inch	DN	L mm	SW mm	Art. no.	4308 (304)	4408 (316)
1/8"	6	52,0	25,0	TB28	○	●
1/4"	8	61,0	30,0	TB28	○	●
3/8"	10	62,5	35,0	TB28	○	●
1/2"	15	73,0	42,0	TB28	○	●
3/4"	20	82,0	47,0	TB28	○	●
1"	25	90,0	53,0	TB28	○	●
1.1/4"	32	104,0	71,0	TB28	○	●
1.1/2"	40	109,6	78,0	TB28	○	●
2"	50	118,0	92,0	TB28	○	●
2.1/2"	65	145,0	112,0	TB28	○	●
3"	80	164,0	126,0	TB28	○	●
4"	100	205,0	157,0	TB28	○	●

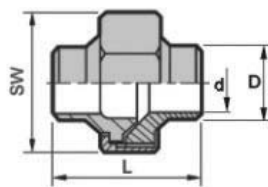

Union conical BW / BW

ANSI B16.25



Inch	DN	L mm	SW mm	D mm	d mm	Art. no.	4308 (304)	4408 (316)
1/8"	6	29,0	25,0	10,2	8,1	TB29	○	●
1/4"	8	35,5	30,0	13,5	10,0	TB29	●	●
3/8"	10	38,0	35,0	17,2	12,7	TB29	●	●
1/2"	15	42,0	42,0	21,3	16,7	TB29	●	●
3/4"	20	50,4	47,0	26,9	21,5	TB29	●	●
1"	25	48,0	53,0	33,7	26,5	TB29	●	●
1.1/4"	32	59,0	71,0	42,4	35,8	TB29	●	●
1.1/2"	40	64,0	78,0	48,3	42,0	TB29	●	●
2"	50	69,0	92,0	60,3	53,3	TB29	●	●
2.1/2"	65	80,0	112,0	76,1	66,5	TB29	○	●
3"	80	88,0	126,0	88,9	78,5	TB29	○	●
4"	100	108,0	157,0	114,3	104,0	TB29	○	●

- = stock
- = ex works

Union flat F / F

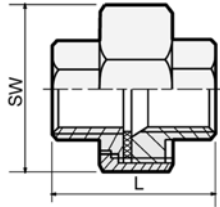

ISO 228-1G
EN ISO 4144



Inch	DN	L mm	SW mm	Art. no.	4308 (304)	4408 (316)
1/8"	6	29,0	25,0	TB32	○	●
1/4"	8	37,5	30,0	TB32	●	●
3/8"	10	38,0	35,0	TB32	●	●
1/2"	15	42,0	42,0	TB32	●	●
3/4"	20	50,4	47,0	TB32	●	●
1"	25	48,0	53,0	TB32	●	●
1.1/4"	32	59,0	71,0	TB32	●	●
1.1/2"	40	65,0	78,0	TB32	●	●
2"	50	69,0	92,0	TB32	●	●
2.1/2"	65	80,0	112,0	TB32	○	●
3"	80	88,0	127,0	TB32	○	●
4"	100	108,0	157,0	TB32	○	●

Union flat M / F

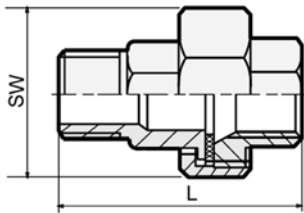

ISO 7-1R / ISO 228-1G
EN ISO 4144



Inch	DN	L mm	SW mm	Art. no.	4308 (304)	4408 (316)
1/8"	6	40,0	25,0	TB33	○	●
1/4"	8	50,0	30,0	TB33	●	●
3/8"	10	50,0	35,0	TB33	●	●
1/2"	15	58,0	42,0	TB33	●	●
3/4"	20	67,0	47,0	TB33	●	●
1"	25	68,3	53,0	TB33	●	●
1.1/4"	32	83,0	71,0	TB33	●	●
1.1/2"	40	86,3	78,0	TB33	●	●
2"	50	94,0	92,0	TB33	●	●
2.1/2"	65	113,3	112,0	TB33	○	●
3"	80	127,0	126,0	TB33	○	●
4"	100	154,5	157,0	TB33	○	●

- = stock
- = ex works

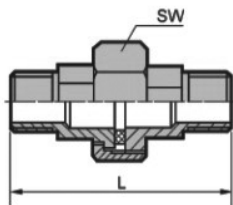

Union flat M / M

ISO 7-1R
EN ISO 4144



Inch	DN	L mm	SW mm	Art. no.	4308 (304)	4408 (316)
1/8"	6	52,0	25,0	TB34	○	●
1/4"	8	61,0	30,0	TB34	○	●
3/8"	10	62,5	35,0	TB34	○	●
1/2"	15	73,0	42,0	TB34	○	●
3/4"	20	82,0	47,0	TB34	○	●
1"	25	90,0	53,0	TB34	○	●
1.1/4"	32	104,0	71,0	TB34	○	●
1.1/2"	40	109,6	78,0	TB34	○	●
2"	50	118,0	92,0	TB34	○	●
2.1/2"	65	145,0	112,0	TB34	○	●
3"	80	164,0	126,0	TB34	○	●
4"	100	205,0	157,0	TB34	○	●

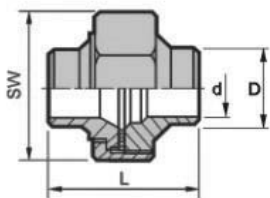

Union flat BW / BW

ANSI B16.25



Inch	DN	L mm	SW mm	D mm	d mm	Art. no.	4308 (304)	4408 (316)
1/8"	6	29,0	25,0	10,2	8,1	TB35	○	●
1/4"	8	35,0	30,0	13,5	10,0	TB35	●	●
3/8"	10	38,0	35,0	17,2	12,7	TB35	●	●
1/2"	15	42,0	42,0	21,3	16,7	TB35	●	●
3/4"	20	50,4	47,0	26,9	21,5	TB35	●	●
1"	25	48,0	53,0	33,7	26,5	TB35	●	●
1.1/4"	32	59,0	71,0	42,4	35,8	TB35	●	●
1.1/2"	40	64,0	78,0	48,3	42,0	TB35	●	●
2"	50	69,0	92,0	60,3	53,3	TB35	●	●
2.1/2"	65	80,0	112,0	76,1	66,5	TB35	○	●
3"	80	88,0	126,0	88,9	78,5	TB35	○	●
4"	100	108,0	157,0	114,3	104,0	TB35	○	●

- = stock
- = ex works

Elbow union conical F / F

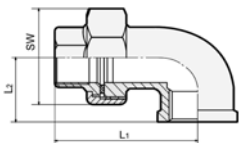

ISO 228-1G



Inch	DN	L1 mm	L2 mm	SW mm	Art. no.	4308 (304)	4408 (316)
1/8"	6	39,0	19,0	25,0	TB38	●	●
1/4"	8	46,2	21,0	30,0	TB38	●	●
3/8"	10	49,0	25,0	35,0	TB38	●	●
1/2"	15	56,0	28,0	42,0	TB38	●	●
3/4"	20	62,7	33,0	47,0	TB38	●	●
1"	25	68,0	38,0	53,0	TB38	●	●
1.1/4"	32	79,5	45,0	71,0	TB38	●	●
1.1/2"	40	88,0	50,0	78,0	TB38	●	●
2"	50	93,8	58,0	92,0	TB38	●	●

Elbow union conical M / F

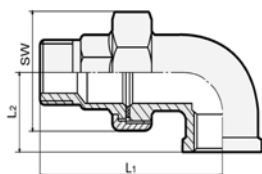

ISO 7-1R / ISO 228-1G



Inch	DN	L1 mm	L2 mm	SW mm	Art. no.	4308 (304)	4408 (316)
1/8"	6	50,7	19,0	25,0	TB39	●	●
1/4"	8	58,6	21,0	30,0	TB39	●	●
3/8"	10	61,0	25,0	35,0	TB39	●	●
1/2"	15	71,0	28,0	42,0	TB39	●	●
3/4"	20	78,7	33,0	47,0	TB39	●	●
1"	25	88,4	38,0	53,0	TB39	●	●
1.1/4"	32	102,9	45,0	71,0	TB39	●	●
1.1/2"	40	110,3	50,0	78,0	TB39	●	●
2"	50	119,4	58,0	92,0	TB39	●	●

Kniekoppeling vlak BI / BI

Elbow union flat F / F

ISO 228-1G

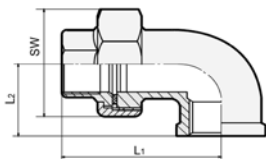

Inch	DN	L1 mm	L2 mm	SW mm	Art. no.	4308 (304)	4408 (316)
1/8"	6	39,0	19,0	25,0	TB44	●	●
1/4"	8	46,2	21,0	30,0	TB44	●	●
3/8"	10	49,0	25,0	35,0	TB44	●	●
1/2"	15	56,0	28,0	42,0	TB44	●	●
3/4"	20	62,7	33,0	47,0	TB44	●	●
1"	25	68,0	38,0	53,0	TB44	●	●
1.1/4"	32	79,5	45,0	71,0	TB44	●	●
1.1/2"	40	88,0	50,0	78,0	TB44	●	●
2"	50	93,8	58,0	92,0	TB44	●	●

- = stock
- = ex works

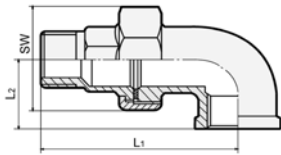

Elbow union flat M / F



ISO 7-1R / ISO 228-1G

Inch	DN	L1 mm	L2 mm	SW mm	Art. no.	4308 (304)	4408 (316)
1/8"	6	50,7	19,0	25,0	TB45	○	○
1/4"	8	58,6	21,0	30,0	TB45	○	○
3/8"	10	61,0	25,0	35,0	TB45	○	○
1/2"	15	71,0	28,0	42,0	TB45	○	○
3/4"	20	78,7	33,0	47,0	TB45	○	○
1"	25	88,4	38,0	53,0	TB45	○	○
1.1/4"	32	102,9	45,0	71,0	TB45	○	○
1.1/2"	40	110,3	50,0	78,0	TB45	○	○
2"	50	119,4	58,0	92,0	TB45	○	○

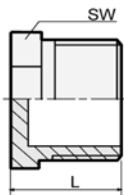

Hexagon head plug tapered



ISO 7-1R
EN ISO 4144

Inch	DN	L mm	SW mm	Art. no.	4308 (304)	4408 (316)
1/8"	6	17,0	12,0	TB50	○	●
1/4"	8	17,5	16,0	TB50	●	●
3/8"	10	18,0	20,0	TB50	●	●
1/2"	15	25,0	24,0	TB50	●	●
3/4"	20	26,0	30,0	TB50	●	●
1"	25	29,0	38,0	TB50	●	●
1.1/4"	32	35,0	46,0	TB50	●	●
1.1/2"	40	38,0	52,0	TB50	●	●
2"	50	39,0	65,0	TB50	●	●
2.1/2"	65	44,0	81,0	TB50	○	●
3"	80	54,0	94,0	TB50	○	●
4"	100	55,0	119,0	TB50	○	●

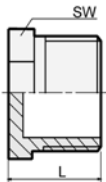

Hexagon head plug parallel

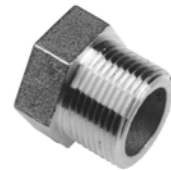

ISO 228
EN ISO 4144

Inch	DN	L mm	SW mm	Art. no.	4308 (304)	4408 (316)
1/8"	6	17,0	12,0	TB51	○	●
1/4"	8	17,5	16,0	TB51	○	●
3/8"	10	18,0	20,0	TB51	○	●
1/2"	15	25,0	24,0	TB51	○	●
3/4"	20	26,0	30,0	TB51	○	●
1"	25	29,0	38,0	TB51	○	●
1.1/4"	32	35,0	46,0	TB51	○	●
1.1/2"	40	38,0	52,0	TB51	○	●
2"	50	39,0	65,0	TB51	○	●
2.1/2"	65	44,0	81,0	TB51	○	●
3"	80	54,0	94,0	TB51	○	●
4"	100	55,0	119,0	TB51	○	●

- = stock
- = ex works

Square head plug

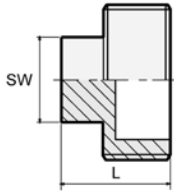

ISO 7-1R
EN ISO 4144



Inch	DN	L mm	SW mm	Art. no.	4308 (304)	4408 (316)
1/8"	6	16,5	6,0	TB52	○	●
1/4"	8	20,0	9,0	TB52	●	●
3/8"	10	24,0	11,0	TB52	●	●
1/2"	15	25,0	13,0	TB52	●	●
3/4"	20	27,0	16,0	TB52	●	●
1"	25	32,0	20,0	TB52	●	●
1.1/4"	32	35,0	24,0	TB52	●	●
1.1/2"	40	36,0	25,0	TB52	●	●
2"	50	38,0	32,0	TB52	●	●
2.1/2"	65	48,0	42,0	TB52	○	●
3"	80	52,0	46,0	TB52	○	●
4"	100	62,0	58,0	TB52	○	●

Round cap

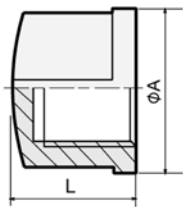

ISO 228-1G
EN ISO 4144



Inch	DN	ØA mm	L mm	Art. no.	4308 (304)	4408 (316)
1/8"	6	18,0	15,0	TB53	○	●
1/4"	8	21,0	17,0	TB53	●	●
3/8"	10	24,0	17,0	TB53	●	●
1/2"	15	27,3	19,0	TB53	●	●
3/4"	20	35,0	24,0	TB53	●	●
1"	25	42,0	29,0	TB53	●	●
1.1/4"	32	52,0	33,0	TB53	●	●
1.1/2"	40	57,5	34,0	TB53	●	●
2"	50	69,3	38,0	TB53	●	●
2.1/2"	65	92,0	41,0	TB53	○	●
3"	80	106,0	47,0	TB53	○	●
4"	100	134,0	53,0	TB53	○	●

- = stock
- = ex works

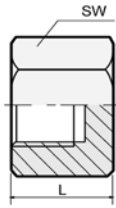

Hexagon cap

ISO 228-1G
EN ISO 4144



Inch	DN	L mm	SW mm	Art. no.	4308 (304)	4408 (316)
1/8"	6	13	15	TB54	○	●
1/4"	8	17	18	TB54	●	●
3/8"	10	19	21	TB54	●	●
1/2"	15	20	27	TB54	●	●
3/4"	20	24	30	TB54	●	●
1"	25	25	38	TB54	●	●
1.1/4"	32	28	50	TB54	●	●
1.1/2"	40	28	55	TB54	●	●
2"	50	34	70	TB54	●	●
2.1/2"	65	40	92	TB54	○	●
3"	80	45	109	TB54	○	●
4"	100	50	132	TB54	○	●

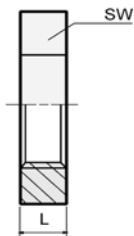

Hexagon nut

ISO 228-1g



Inch	DN	L mm	SW mm	Art. no.	4308 (304)	4408 (316)
1/8"	6	6,2	14,6	TB58	○	●
1/4"	8	7,0	23,0	TB58	○	●
3/8"	10	8,0	26,0	TB58	○	●
1/2"	15	10,0	31,0	TB58	○	●
3/4"	20	11,0	37,0	TB58	○	●
1"	25	10,0	46,0	TB58	○	●
1.1/4"	32	11,0	55,0	TB58	○	●
1.1/2"	40	12,0	63,0	TB58	○	●
2"	50	13,0	76,0	TB58	○	●
2.1/2"	65	16,0	95,0	TB58	○	●
3"	80	19,0	105,0	TB58	○	●
4"	100	20,0	131,0	TB58	○	●

- = stock
- = ex works

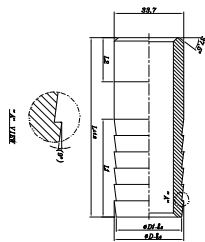

Hose nipple HOSE / M

ISO 7-1R



Inch	DN	D mm	D1 mm	L mm	L1 mm	L2 mm	A inch	Art. no.	304L	316L
1/8"	6	10,2	8,62	70	30,0	12	1/8"	TB56	○	●
1/4"	8	13,5	11,92	70	30,0	12	1/4"	TB56	○	●
3/8"	10	17,2	15,62	70	30,0	15	3/8"	TB56	○	●
1/2"	15	21,3	19,45	75	35,0	20	1/2"	TB56	○	●
3/4"	20	26,7	25,05	75	35,0	20	3/4"	TB56	○	●
1"	25	33,4	31,59	80	37,5	20	1"	TB56	○	●
1.1/4"	32	42,2	39,76	90	40,0	25	1.1/4"	TB56	○	●
1.1/2"	40	48,3	45,67	90	40,0	25	1.1/2"	TB56	○	●
2"	50	60,3	57,39	95	40,0	25	2"	TB56	○	●
2.1/2"	65	76,1	72,67	105	60,0	30	2.1/2"	TB56	○	●
3"	80	88,9	85,23	110	60,0	30	3"	TB56	○	●
4"	100	114,3	110,34	115	60,0	35	4"	TB56	○	●

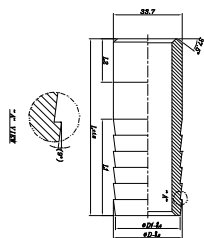

Hose nipple HOSE / BW

ISO 7-1R



Inch	DN	D mm	D1 mm	L mm	L1 mm	L2 mm	Art. no.	304L	316L
1/8"	6	10,2	8,62	70	30,0	12	TB58	○	●
1/4"	8	13,5	11,92	70	30,0	12	TB58	○	●
3/8"	10	17,2	15,62	70	30,0	15	TB58	○	●
1/2"	15	21,3	19,45	75	35,0	20	TB58	○	●
3/4"	20	26,7	25,05	75	35,0	20	TB58	○	●
1"	25	33,4	31,59	80	37,5	20	TB58	○	●
1.1/4"	32	42,2	39,76	90	40,0	25	TB58	○	●
1.1/2"	40	48,3	45,67	90	40,0	25	TB58	○	●
2"	50	60,3	57,39	95	40,0	25	TB58	○	●
2.1/2"	65	76,1	72,67	105	60,0	30	TB58	○	●
3"	80	88,9	85,23	110	60,0	30	TB58	○	●
4"	100	114,3	110,34	115	60,0	35	TB58	○	●

- = stock
- = ex works

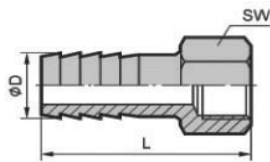

Hose nipple F

ISO 228-1G

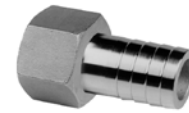

Inch	DN	ØD mm	L mm	SW mm	Art. no.	4308 (304)	4408 (316)
1/8"	6	6,50	39,0	15,00	TB58	○	●
1/4"	8	6,35	42,0	19,00	TB58	○	●
1/4"	8	7,94	42,0	19,00	TB58	○	●
3/8"	10	9,50	53,0	22,00	TB58	○	●
3/8"	10	11,00	53,0	22,00	TB58	○	●
1/2"	15	12,70	62,0	27,00	TB58	○	●
1/2"	15	14,00	62,0	27,00	TB58	○	●
3/4"	20	19,05	63,5	32,00	TB58	○	●
3/4"	20	20,50	63,5	32,00	TB58	○	●
1"	25	25,40	66,0	38,00	TB58	○	●
1"	25	27,00	66,0	38,00	TB58	○	●
1.1/4"	32	31,80	74,0	50,00	TB58	○	●
1.1/4"	32	33,00	74,0	50,00	TB58	○	●
1.1/2"	40	38,10	87,5	55,50	TB58	○	●
1.1/2"	40	39,50	87,5	55,50	TB58	○	●
2"	50	50,80	94,5	67,50	TB58	○	●
2"	50	52,00	94,5	67,50	TB58	○	●

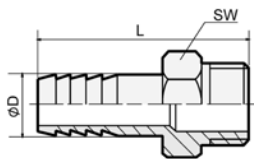

Hose nipple M

ISO 7-1R



Inch	DN	ØD mm	L mm	SW mm	Art. no.	4308 (304)	4408 (316)
1/8"	6	4,5	45,0	13,00	TB59	○	●
1/4"	8	6,3	47,0	16,50	TB59	○	●
1/4"	8	7,0	47,0	16,50	TB59	○	●
1/4"	8	9,0	47,0	16,50	TB59	○	●
1/4"	8	10,0	47,0	16,50	TB59	○	●
1/4"	8	11,0	47,0	16,50	TB59	○	●
1/4"	8	12,7	47,0	16,50	TB59	○	●
3/8"	10	6,4	55,0	20,00	TB59	○	●
3/8"	10	8,0	55,0	20,00	TB59	○	●
3/8"	10	9,5	55,0	20,00	TB59	○	●
3/8"	10	10,0	55,0	20,00	TB59	○	●
3/8"	10	11,0	55,0	20,00	TB59	○	●
3/8"	10	12,7	55,0	20,00	TB59	○	●
1/2"	15	6,3	64,0	23,50	TB59	○	●
1/2"	15	9,5	64,0	23,50	TB59	○	●
1/2"	15	10,0	64,0	23,50	TB59	○	●
1/2"	15	11,0	64,0	23,50	TB59	○	●
1/2"	15	12,7	64,0	23,50	TB59	○	●
1/2"	15	14,0	64,0	23,50	TB59	○	●
1/2"	15	19,0	64,0	23,50	TB59	○	●
3/4"	20	12,7	68,0	31,00	TB59	○	●
3/4"	20	19,1	68,0	31,00	TB59	○	●
3/4"	20	20,5	68,0	31,00	TB59	○	●

- = stock
- = ex works

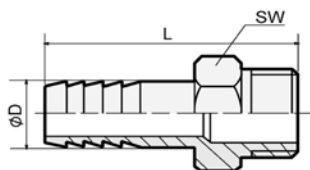

Hose nipple M

ISO 7-1R



Inch	DN	ØD mm	L mm	SW mm	Art. no.	4308 (304)	4408 (316)
1"	25	12,7	71,0	38,5	TB59	○	●
1"	25	19,0	71,0	38,5	TB59	○	●
1"	25	25,4	71,0	38,5	TB59	○	●
1"	25	27,0	71,0	38,5	TB59	○	●
1.1/4"	32	31,8	80,0	46,0	TB59	○	●
1.1/4"	32	33,0	80,0	46,0	TB59	○	●
1.1/2"	40	38,1	95,0	52,0	TB59	○	●
1.1/2"	40	39,5	95,0	52,0	TB59	○	●
2"	50	50,8	105,0	62,0	TB59	○	●
2"	50	52,0	105,0	62,0	TB59	○	●
2.1/2"	65	63,5	107,0	80,0	TB59	○	●
2.1/2"	65	67,0	107,0	80,0	TB59	○	●
3"	80	76,2	112,0	91,0	TB59	○	●
3"	80	80,0	112,0	91,0	TB59	○	●
4"	100	101,6	130,0	116,5	TB59	○	●
4"	100	105,0	130,0	116,5	TB59	○	●

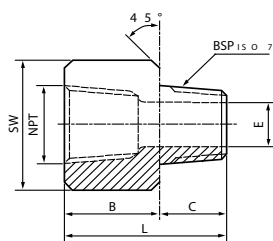

Hexagon adaptor F NPT / M BSP

ISO 228-1G / ISO 7-1R



Inch	Inch	DN	DN	B mm	C mm	E mm	L mm	SW mm	Art. no.	4308 (304)	4408 (316)
1/4"	1/4"	8	8	16,5	12,0	8,0	28,5	17,0	TB64	○	●
3/8"	3/8"	10	10	18,5	12,5	10,0	31,0	21,0	TB64	○	●
1/2"	1/2"	15	15	22,0	15,5	13,5	37,5	26,0	TB64	○	●
3/4"	3/4"	20	20	23,0	18,0	20,0	41,0	32,0	TB64	○	●
1"	1"	25	25	26,0	20,0	26,0	46,0	38,0	TB64	○	●
1.1/4"	1.1/4"	32	32	27,0	22,0	33,0	49,0	46,0	TB64	○	●
1.1/2"	1.1/2"	40	40	28,0	23,0	39,0	51,0	54,0	TB64	○	●
2"	2"	50	50	30,0	25,5	52,0	55,5	63,0	TB64	○	●

- = stock
- = ex works

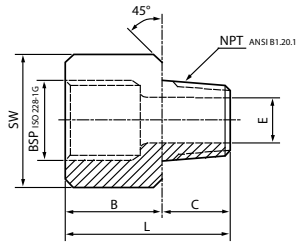

Hexagon adaptor F NPT / M BSP

ISO 228-1G / ISO 7-1R



Inch	Inch	DN	DN	B mm	C mm	E mm	L mm	SW mm	Art. no.	4308 (304)	4408 (316)
1/4"	1/4"	8	8	16,5	12	8,0	28,5	17,0	TB64	○	●
3/8"	3/8"	10	10	18,5	12,5	10,0	31	21,0	TB64	○	●
1/2"	1/2"	15	15	22,0	15,5	13,5	37,5	26,0	TB64	○	●
3/4"	3/4"	20	20	23,0	18	20,0	41	32,0	TB64	○	●
1"	1"	25	25	26,0	20	26,0	46	38,0	TB64	○	●
1.1/4"	1.1/4"	32	32	27,0	22	33,0	49	46,0	TB64	○	●
1.1/2"	1.1/2"	40	40	28,0	23	39,0	51	54,0	TB64	○	●
2"	2"	50	50	30,0	25,5	52,0	55,5	63,0	TB64	○	●

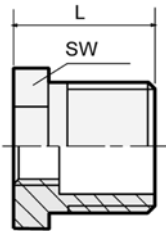

Hexagon bushing M / F

ISO 7-1R / ISO 228-1G

EN ISO 4144



Inch	Inch	DN	DN	L mm	SW mm	Art. no.	4308 (304)	4408 (316)
1/4"	1/8"	8	6	15,2	16	TB60	●	●
3/8"	1/8"	10	6	16,5	18	TB60	●	●
3/8"	1/4"	10	8	16,5	18	TB60	●	●
1/2"	1/8"	15	6	21,0	26	TB60	○	●
1/2"	1/4"	15	8	21,0	26	TB60	●	●
1/2"	3/8"	15	10	21,0	26	TB60	●	●
3/4"	1/8"	20	6	24,0	30	TB60	○	●
3/4"	1/4"	20	8	24,0	30	TB60	●	●
3/4"	3/8"	20	10	24,0	30	TB60	●	●
3/4"	1/2"	20	15	24,0	30	TB60	●	●
1"	1/4"	25	8	27,0	35	TB60	○	●
1"	3/8"	25	10	27,0	35	TB60	●	●
1"	1/2"	25	15	27,0	35	TB60	●	●
1"	3/4"	25	20	27,0	35	TB60	●	●
1.1/4"	1/2"	32	15	30,0	45	TB60	○	●
1.1/4"	3/4"	32	20	30,0	45	TB60	●	●
1.1/4"	1"	32	25	30,0	45	TB60	●	●
1.1/2"	1/2"	40	15	38,0	52	TB60	○	●
1.1/2"	3/4"	40	20	38,0	52	TB60	○	●
1.1/2"	1"	40	25	38,0	52	TB60	●	●
1.1/2"	1.1/4"	40	32	38,0	52	TB60	●	●
2"	1/2"	50	15	36,0	63	TB60	○	●
2"	3/4"	50	20	36,0	63	TB60	○	●
2"	1"	50	25	36,0	63	TB60	●	●
2"	1.1/4"	50	32	36,0	63	TB60	●	●
2"	1.1/2"	50	40	36,0	63	TB60	●	●

- = stock
- = ex works

Hexagon bushing M / F

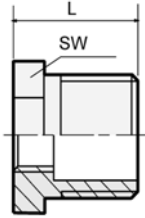

ISO 7-1R / ISO 228-1G

EN ISO 4144



Inch	Inch	DN	DN	L mm	SW mm	Art. no.	4308 (304)	4408 (316)
2.1/2"	1"	65	25	45,0	81	TB60	○	●
2.1/2"	1.1/2"	65	40	45,0	81	TB60	○	●
2.1/2"	2"	65	50	45,0	81	TB60	○	●
3"	1.1/2"	80	40	47,0	95	TB60	○	●
3"	2"	80	50	47,0	95	TB60	○	●
3"	2.1/2"	80	65	47,0	95	TB60	○	●
4"	2"	100	50	52,0	120	TB60	○	●
4"	2.1/2"	100	65	52,0	120	TB60	○	●
4"	3"	100	80	52,0	120	TB60	○	●

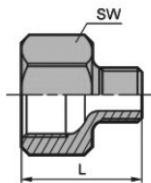

Hexagon negative bushing M / F

ISO 228-1G / ISO 7-1R



Inch	Inch	DN	DN	L mm	SW mm	Art. no.	4308 (304)	4408 (316)
1/4"	1/8"	8	6	27,0	17	TB61	○	●
3/8"	1/8"	10	6	29,0	21	TB61	○	●
3/8"	1/4"	10	8	30,5	21	TB61	○	●
1/2"	1/8"	15	6	32,5	26	TB61	○	●
1/2"	1/4"	15	8	34,0	26	TB61	○	●
1/2"	3/8"	15	10	34,5	26	TB61	○	●
3/4"	1/8"	20	6	33,5	32	TB61	○	●
3/4"	1/4"	20	8	35,0	32	TB61	○	●
3/4"	3/8"	20	10	35,5	32	TB61	○	●
3/4"	1/2"	20	15	38,5	32	TB61	○	●
1"	1/8"	25	6	36,5	38	TB61	○	●
1"	1/4"	25	8	38,0	38	TB61	○	●
1"	3/8"	25	10	38,5	38	TB61	○	●
1"	1/2"	25	15	41,0	38	TB61	○	●
1"	3/4"	25	20	44,0	38	TB61	○	●
1.1/4"	1/4"	32	8	40,0	50	TB61	○	●
1.1/4"	3/8"	32	10	40,0	50	TB61	○	●
1.1/4"	1/2"	32	15	42,5	50	TB61	○	●
1.1/4"	3/4"	32	20	45,0	50	TB61	○	●
1.1/4"	1"	32	25	47,0	50	TB61	○	●
1.1/2"	1/4"	40	8	41,0	54	TB61	○	●
1.1/2"	3/8"	40	10	42,0	54	TB61	○	●
1.1/2"	1/2"	40	15	45,0	54	TB61	○	●
1.1/2"	3/4"	40	20	46,0	54	TB61	○	●
1.1/2"	1"	40	25	48,0	54	TB61	○	●
1.1/2"	1.1/4"	40	32	50,0	54	TB61	○	●

- = stock
- = ex works

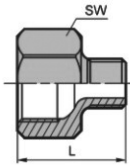

Hexagon negative bushing M / F

ISO 228-1G / ISO 7-1R



Inch	Inch	DN	DN	L mm	SW mm	Art. no.	4308 (304)	4408 (316)
2"	1/4"	50	8	44,5	68	TB61	○	●
2"	3/8"	50	10	31,0	68	TB61	○	●
2"	1/2"	50	15	49,0	68	TB61	○	●
2"	3/4"	50	20	51,0	68	TB61	○	●
2"	1"	50	25	51,0	68	TB61	○	●
2"	1.1/4"	50	32	53,0	68	TB61	○	●
2"	1.1/2"	50	40	54,0	68	TB61	○	●

Hexagon red nipple M / M

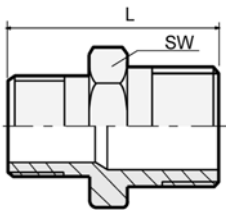

ISO 7-1R

EN ISO 4144



Inch	Inch	DN	DN	L mm	SW mm	Art. no.	4308 (304)	4408 (316)
1/4"	1/8"	8	6	34,0	18,0	TB62	●	●
3/8"	1/8"	10	6	35,0	21,0	TB62	○	●
3/8"	1/4"	10	8	34,0	21,0	TB62	●	●
1/2"	1/8"	15	6	34,0	26,0	TB62	○	●
1/2"	1/4"	15	8	34,0	26,0	TB62	●	●
1/2"	3/8"	15	10	41,0	26,0	TB62	●	●
3/4"	1/8"	20	6	37,0	30,0	TB62	○	●
3/4"	1/4"	20	8	37,0	30,0	TB62	●	●
3/4"	3/8"	20	10	37,0	30,0	TB62	●	●
3/4"	1/2"	20	15	45,0	30,0	TB62	●	●
1"	1/8"	25	6	39,0	35,0	TB62	○	●
1"	1/4"	25	8	39,0	35,0	TB62	○	●
1"	3/8"	25	10	40,0	35,0	TB62	○	●
1"	1/2"	25	15	43,2	35,0	TB62	●	●
1"	3/4"	25	20	50,0	37,0	TB62	●	●
1.1/4"	1/2"	32	15	48,0	46,0	TB62	○	●
1.1/4"	3/4"	32	20	52,0	46,0	TB62	○	●
1.1/4"	1"	32	25	54,0	46,0	TB62	●	●
1.1/2"	1/2"	40	15	49,0	50,0	TB62	○	●
1.1/2"	3/4"	40	20	53,0	50,0	TB62	○	●
1.1/2"	1"	40	25	53,0	50,0	TB62	●	●
1.1/2"	1.1/4"	40	32	59,0	50,0	TB62	●	●
2"	1/2"	50	15	52,0	63,0	TB62	○	●
2"	3/4"	50	20	56,0	63,0	TB62	○	●
2"	1"	50	25	57,0	63,0	TB62	●	●
2"	1.1/4"	50	32	58,0	63,0	TB62	●	●
2"	1.1/2"	50	40	65,4	64,0	TB62	●	●
2.1/2"	1"	65	25	63,0	80,0	TB62	○	●
2.1/2"	1.1/2"	65	40	66,0	80,0	TB62	○	●
2.1/2"	2"	65	50	77,0	76,3	TB62	○	●

- = stock
- = ex works

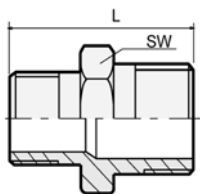

Hexagon red nipple M / M

ISO 7-1R
EN ISO 4144



Inch	Inch	DN	DN	L mm	SW mm	Art. no.	4308 (304)	4408 (316)
3"	1.1/2"	80	40	72,0	95,0	TB62	●	●
3"	2"	80	50	74,0	95,0	TB62	●	●
3"	2.1/2"	80	65	84,0	95,0	TB62	●	●
4"	2"	100	50	82,0	125,0	TB62	●	●
4"	2.1/2"	100	65	82,0	125,0	TB62	●	●
4"	3"	100	80	94,0	117,4	TB62	●	●

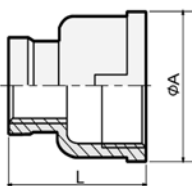

Reducing socket F / F

ISO 228-1G
EN ISO 4144



Inch	Inch	DN	DN	L mm	ØA	Art. no.	4308 (304)	4408 (316)
1/4"	1/8"	8	6	26,0	21,5	TB63	●	●
3/8"	1/8"	10	6	28,3	22,6	TB63	●	●
3/8"	1/4"	10	8	29,0	26,0	TB63	●	●
1/2"	1/8"	15	6	34,0	29,0	TB63	●	●
1/2"	1/4"	15	8	34,0	29,0	TB63	●	●
1/2"	3/8"	15	10	34,0	29,0	TB63	●	●
3/4"	1/4"	20	8	38,0	36,7	TB63	●	●
3/4"	3/8"	20	10	38,0	36,7	TB63	●	●
3/4"	1/2"	20	15	37,0	37,0	TB63	●	●
1"	1/4"	25	8	42,0	43,0	TB63	●	●
1"	3/8"	25	10	42,0	43,0	TB63	●	●
1"	1/2"	25	15	42,0	43,0	TB63	●	●
1"	3/4"	25	20	42,0	43,0	TB63	●	●
1.1/4"	1/2"	32	15	48,0	52,0	TB63	●	●
1.1/4"	3/4"	32	20	48,0	52,0	TB63	●	●
1.1/4"	1"	32	25	52,0	52,5	TB63	●	●
1.1/2"	1/2"	40	15	51,0	59,0	TB63	●	●
1.1/2"	3/4"	40	20	49,0	59,0	TB63	●	●
1.1/2"	1"	40	25	53,0	59,0	TB63	●	●
1.1/2"	1.1/4"	40	32	53,0	59,0	TB63	●	●
2"	1/2"	50	15	50,5	72,0	TB63	●	●
2"	3/4"	50	20	50,5	72,0	TB63	●	●
2"	1"	50	25	56,0	72,0	TB63	●	●
2"	1.1/4"	50	32	56,0	72,0	TB63	●	●
2"	1.1/2"	50	40	57,0	72,0	TB63	●	●
2.1/2"	1"	65	25	60,0	87,0	TB63	●	●
2.1/2"	1.1/2"	65	40	60,0	85,0	TB63	●	●
2.1/2"	2"	65	50	61,0	85,0	TB63	●	●
3"	1.1/2"	80	40	62,0	100,0	TB63	●	●
3"	2"	80	50	62,0	100,0	TB63	●	●
3"	2.1/2"	80	65	62,0	100,0	TB63	●	●
4"	2"	100	50	65,0	129,0	TB63	●	●
4"	2.1/2"	100	65	65,0	128,0	TB63	●	●
4"	3"	100	80	65,0	128,0	TB63	●	●

● = stock
○ = ex works

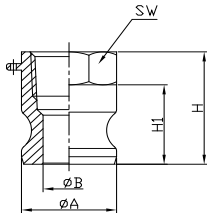

A Adapter female thread

ISO 228-1G

MIL-C-27487 ASTM-F1122



Inch	DN	ØA mm	ØB mm	H mm	H1 mm	SW	Art. no.	CF8 (304)	316 (316)
1/2"	15	24,3	14,4	38,0	25,0	25,5	TQ10	○	●
3/4"	20	32,0	21,2	38,0	28,0	33,0	TQ10	○	●
1"	25	36,7	23,8	46,5	33,5	41,0	TQ10	○	●
1.1/4"	32	45,5	28,6	55,0	40,0	48,0	TQ10	○	●
1.1/2"	40	53,4	36,0	58,5	42,5	56,0	TQ10	○	●
2"	50	63,0	45,5	62,3	47,5	67,5	TQ10	○	●
2.1/2"	65	75,7	56,4	68,0	50,0	83,0	TQ10	○	●
3"	80	91,5	73,5	70,0	51,0	96,5	TQ10	○	●
4"	100	119,5	100,0	76,0	53,0	124,0	TQ10	○	●

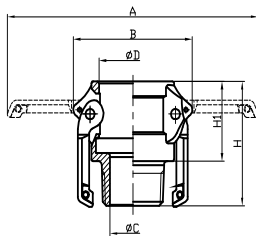

B Coupler male thread

ISO 7-1R

MIL-C-27487 ASTM-F1122



Inch	DN	A mm	B mm	ØC mm	ØD mm	H1 mm	H mm	Art. no.	CF8 (304)	316 (316)
1/2"	15	107	48,7	14,8	25,1	31,0	48	TQ11	○	●
3/4"	20	115	57,0	21,2	32,4	30,0	49	TQ11	○	●
1"	25	137	65,6	25,0	37,3	39,0	61	TQ11	○	●
1.1/4"	32	183	77,0	28,0	46	46,0	68	TQ11	○	●
1.1/2"	40	191	85,0	39,0	54	48,0	70,5	TQ11	○	●
2"	50	201	96,0	50,0	63,7	53,0	78,7	TQ11	○	●
2.1/2"	65	213	110,4	58,0	76,5	58,0	86	TQ11	○	●
3"	80	267	133,0	73,2	92,2	58,0	89	TQ11	○	●
4"	100	296	166,0	97,0	120,2	63,0	97	TQ11	○	●

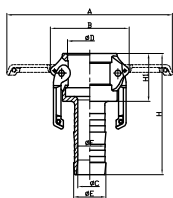

C Coupler hose shank

MIL-C-27487 ASTM-F1122



Inch	DN	A mm	B mm	ØC mm	ØD mm	ØE mm	ØF mm	H1 mm	H mm	Art. no.	CF8 (304)	316 (316)
1/2"	15	107	48,7	8,0	25,1	15,0	13	31	72,0	TQ12	○	●
3/4"	20	115	57,0	13,6	32,4	20,7	19,4	30	80,0	TQ12	○	●
1"	25	137	65,6	20,0	37,3	27,0	25,8	39	99,0	TQ12	○	●
1.1/4"	32	183	77,0	25,8	46	33,9	32,9	46	110,0	TQ12	○	●
1.1/2"	40	191	85,0	31,3	54	40,5	38,6	48	114,0	TQ12	○	●
2"	50	201	96,0	43,8	63,7	52,0	51	53	129,0	TQ12	○	●
2.1/2"	65	213	110,4	55,7	76,5	66,8	-	58	151,0	TQ12	○	●
3"	80	267	133,0	68,0	92,2	79,0	-	58	160,0	TQ12	○	●
4"	100	296	166,0	92,0	120,2	104,8	-	63	176,0	TQ12	○	●

- = stock
- = ex works

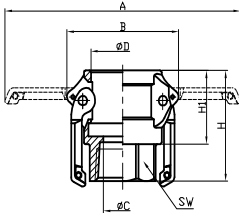

D Coupler female thread

ISO 228-1G

MIL-C-27487 ASTM-F1122



Inch	DN	A mm	B mm	ØC mm	ØD mm	H1 mm	H mm	SW	Art. no.	CF8 (304)	316 (316)
1/2"	15	107	48,7	17,4	25,1	31,0	49	25,5	TQ13	○	●
3/4"	20	115	57,0	20,0	32,4	30,0	50	32,0	TQ13	○	●
1"	25	137	65,6	26,0	37,3	39,0	60	38,5	TQ13	○	●
1.1/4"	32	183	77,0	34,5	46	46,0	66	48,0	TQ13	○	●
1.1/2"	40	191	85,0	40,0	54	48,0	70,5	55,5	TQ13	○	●
2"	50	201	96,0	50,0	63,7	53,0	76	67,0	TQ13	○	●
2.1/2"	65	213	110,4	61,0	76,5	58,0	82	82,0	TQ13	○	●
3"	80	267	133,0	75,0	92,2	58,0	86	94,2	TQ13	○	●
4"	100	296	166,0	100,0	120,2	63,0	92	127,0	TQ13	○	●

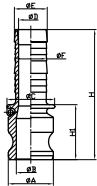

E Adapter hose shank

MIL-C-27487 ASTM-F1122



Inch	DN	ØA mm	ØB mm	ØC mm	ØD mm	ØE mm	ØF mm	H1	H mm	Art. no.	CF8 (304)	316 (316)
1/2"	15	24,3	14,4	30,0	8,0	15,0	13	35	76,0	TQ14	○	●
3/4"	20	32,0	21,2	33,0	13,6	20,7	19,4	37	87,0	TQ14	○	●
1"	25	36,7	23,8	39,0	20,0	27,0	25,8	44	104,0	TQ14	○	●
1.1/4"	32	45,5	28,6	48,0	25,8	33,9	32,9	51	115,0	TQ14	○	●
1.1/2"	40	53,4	36,0	56,0	31,3	40,5	38,6	52	118,0	TQ14	○	●
2"	50	63,0	45,5	66,0	43,8	52,0	51	56	132,0	TQ14	○	●
2.1/2"	65	75,7	55,7	80,0	55,7	66,8	-	64	156,0	TQ14	○	●
3"	80	91,5	73,2	101,0	68,0	79,0	-	66	169,0	TQ14	○	●
4"	100	119,5	91,0	130,0	92,0	104,8	-	68	180,0	TQ14	○	●

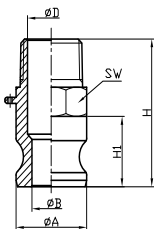

F Adapter male thread

ISO 7-1R

MIL-C-27487 ASTM-F1122



Inch	DN	ØA mm	ØB mm	ØD mm	H1 mm	H mm	SW	Art. no.	CF8 (304)	316 (316)
1/2"	15	24,3	14,4	14,4	25	56	25,5	TQ15	○	●
3/4"	20	32,0	21,2	21,2	28	56	33,0	TQ15	○	●
1"	25	36,7	23,8	23,8	33,5	69	41,0	TQ15	○	●
1.1/4"	32	45,5	28,6	33,0	40	77	48,0	TQ15	○	●
1.1/2"	40	53,4	36,0	39,6	42,5	80	56,0	TQ15	○	●
2"	50	63,0	45,5	50,0	47,5	89	65,0	TQ15	○	●
2.1/2"	65	75,7	56,4	56,4	50	98	82,5	TQ15	○	●
3"	80	91,5	73,2	77,5	51	101	95,8	TQ15	○	●
4"	100	119,5	100,0	100,0	53	114	124,0	TQ15	○	●

- = stock
- = ex works

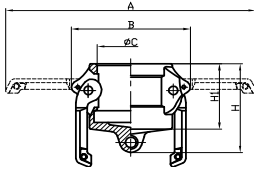

DC Dust cap

MIL-C-27487 ASTM-F1122



Inch	DN	A mm	B mm	ØC mm	H1 mm	H mm	Art. no.	CF8 (304)	316 (316)
1/2"	15	107,0	48,7	25,1	30	40	TQ16	○	●
3/4"	20	115,0	57,0	32,4	30	40	TQ16	○	●
1"	25	137,0	65,6	37,3	39	53	TQ16	○	●
1.1/4"	32	183,0	77,0	46,0	46	61	TQ16	○	●
1.1/2"	40	191,0	85,0	54,0	48	64	TQ16	○	●
2"	50	201,0	96,0	63,7	53	68	TQ16	○	●
2.1/2"	65	213,0	110,4	76,5	58	82	TQ16	○	●
3"	80	267,0	133,0	92,2	58	83	TQ16	○	●
4"	100	296,0	166,0	120,2	63	93	TQ16	○	●

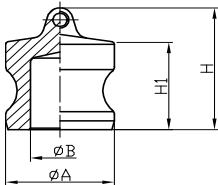

DP Dust Plug

MIL-C-27487 ASTM-F1122



Inch	DN	ØA mm	ØB mm	H1	H	Art. no.	CF8 (304)	316 (316)
1/2"	15	24,3	14,4	26,0	35,0	TQ17	○	●
3/4"	20	32,0	21,2	25,0	36,0	TQ17	○	●
1"	25	36,7	23,8	30,5	44,5	TQ17	○	●
1.1/4"	32	45,5	28,6	37,7	52,7	TQ17	○	●
1.1/2"	40	53,4	36,0	38,7	53,7	TQ17	○	●
2"	50	63,0	45,5	42,8	57,8	TQ17	○	●
2.1/2"	65	75,7	56,4	46,0	71,0	TQ17	○	●
3"	80	91,5	73,2	46,0	76,0	TQ17	○	●
4"	100	119,5	100,0	50,0	120,0	TQ17	○	●

- = stock
- = ex works