

Lasbocht 90° gelast

Elbow 90° welded

EN 10253-4 type A 3D / 1.5d / 1.5ID / ID+100

EN 10204 3.1



OD mm	Wall mm	R	Type	Art. no.	Kg / pc	4301 4307	4404	4571
13,50	1,60	21,0	1.5d	EB15	0,02	●	●	○
13,50	2,30	21,0	1.5d	EB15	0,02	●	●	○
15,00	1,50	22,0	1.5d	EB15	0,02	●	●	
17,20	1,60	28,0	1.5d	EB15	0,03	●	●	○
17,20	2,30	28,0	1.5d	EB15	0,04	●	●	○
18,00	1,50	30,0	1.5d	EB15	0,03	●	●	
20,00	1,50	23,0	1.5d	EB15	0,03	●	●	○
20,00	1,50	30,0	1.5d	EB15	0,03	●	●	○
20,00	2,00	30,0	1.5d	EB15	0,04	●	●	○
21,30	1,60	28,0	3D	EB10	0,04	●	●	○
21,30	1,60	38,0	1.5d	EB15	0,04	●	●	○
21,30	2,00	28,0	3D	EB10	0,04	●	●	●
21,30	2,00	38,0	1.5d	EB15	0,04	●	●	○
21,30	2,00	45,0	5D	EB11	0,07	○	○	○
21,30	2,60	28,0	3D	EB10	0,05	●	●	●
21,30	2,60	38,0	1.5d	EB15	0,05	●	●	○
25,00	1,50	33,0	1.5d	EB15	0,05	●	●	○
25,00	2,00	33,0	1.5d	EB15	0,06	●	●	○
26,90	1,60	29,0	3D	EB10	0,04	●	●	○
26,90	2,00	29,0	3D	EB10	0,06	●	●	●
26,90	2,00	57,0	5D	EB11	0,11	○	○	○
26,90	2,60	29,0	3D	EB10	0,07	●	●	●
28,00	1,50	31,8	1.5d	EB15	0,05	●	●	
28,00	1,50	42,0	1.5d	EB15	0,06	●	●	
28,00	2,00	31,8	1.5d	EB15	0,06	●	●	
28,00	2,00	42,0	1.5d	EB15	0,07	●	●	
30,00	1,50	45,0	1.5d	EB15	0,06	●	●	
30,00	2,00	38,0	1.5d	EB15	0,06	●	●	○
30,00	2,00	45,0	1.5d	EB15	0,07	●	●	
32,00	1,50	48,0	1.5d	EB15	0,09	●	●	
32,00	2,00	48,0	1.5d	EB15	0,11	●	●	
33,70	1,60	38,0	3D	EB10	0,08	●	●	○
33,70	2,00	38,0	3D	EB10	0,10	●	●	●
33,70	2,00	72,0	5D	EB11	0,18	○	○	○
33,70	2,60	38,0	3D	EB10	0,12	●	●	●
33,70	3,20	38,0	3D	EB10	0,17	●	●	●
35,00	1,50	45,0	1.5d	EB15	0,08	●	○	○
35,00	1,50	52,5	1.5d	EB15	0,10	●	○	
35,00	2,00	45,0	1.5d	EB15	0,11	●	○	○
35,00	2,00	52,5	1.5d	EB15	0,14	●	○	
38,00	2,00	50,0	1.5d	EB15	0,13	●	○	○
38,00	2,00	57,0	1.5d	EB15	0,16	●	○	
38,10	1,50	50,0	1.5d	EB15	0,10	●	○	○
38,10	1,50	57,0	1.5d	EB15	0,12	●	○	

*) EN 10253-3 eller/or EN 10254-4 type A

● = voorraad
○ = af fabriek

● = stock
○ = ex works

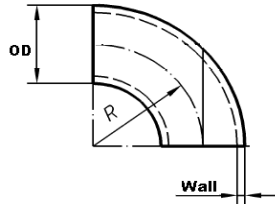

Lasbocht 90° gelast

Elbow 90° welded

EN 10253-4 type A 3D / 1.5d / 1.5ID / ID+100

EN 10204 3.1



OD mm	Wall mm	R	Type	Art. no.	Kg / pc	4301 4307	4404	4571
38,10	1,50	50,0	1.5d	EB15	0,10	●	○	○
38,10	1,50	57,0	1.5d	EB15	0,12	●	○	
40,00	1,50	60,0	1.5d	EB15	0,14	●	●	
40,00	2,00	60,0	1.5d	EB15	0,18	●	●	
42,40	1,60	48,0	3D	EB10	0,12	●	●	○
42,40	2,00	48,0	3D	EB10	0,15	●	●	●
42,40	2,00	93,0	5D	EB11	0,29	○	○	○
42,40	2,60	48,0	3D	EB10	0,19	●	●	●
42,40	3,20	48,0	3D	EB10	0,24	●	●	●
44,50	2,00	60,0	1.5ID	EB20	0,19	●	●	○
48,30	1,60	57,0	3D	EB10	0,16	●	●	○
48,30	2,00	57,0	3D	EB10	0,21	●	●	●
48,30	2,00	108,0	5D	EB11	0,39	○	○	○
48,30	2,60	57,0	3D	EB10	0,27	●	●	●
48,30	3,20	57,0	3D	EB10	0,32	●	●	●
50,00	1,50	75,0	1.5d	EB15	0,22	●	●	
50,00	2,00	75,0	1.5d	EB15	0,28	●	●	
50,80	2,00	75,0	1.5d	EB15	0,22	●	●	
50,80	2,50	75,0	1.5d	EB15	0,28	●	○	
53,00	1,50	75,0	1.5ID	EB20	0,16	●	○	
54,00	2,00	75,0	1.5ID	EB20	0,21	●	●	○
57,00	2,00	77,0	1.5d	EB15	0,33	●	●	○
57,00	3,00	77,0	1.5d	EB15	0,49	●	●	○
60,30	1,60	76,0	3D	EB10	0,27	●	●	○
60,30	2,00	76,0	3D	EB10	0,35	●	●	●
60,30	2,00	135,0	5D	EB11	0,61	○	○	○
60,30	2,60	76,0	3D	EB10	0,45	●	●	●
60,30	3,00	76,0	3D	EB10	0,50	●	●	●
60,30	3,60	76,0	3D	EB10	0,61	●	●	●
63,50	2,00	94,5	1.5d	EB15	0,46	●	○	
70,00	2,00	92,5	1.5d	EB15	0,49	●	●	
70,00	3,00	92,5	1.5d	EB15	0,78	●	○	
76,10	2,00	95,0	3D	EB10	0,55	●	●	●
76,10	2,00	175,0	5D	EB11	1,00	○	○	○
76,10	2,60	95,0	3D	EB10	0,71	●	●	●
76,10	3,00	95,0	3D	EB10	0,79	●	●	●
76,10	3,60	95,0	3D	EB10	0,99	●	●	●
84,00	2,00	120,0	1.5ID	EB20	0,77	●	●	○
84,00	2,00	180,0	ID+100	EB25	1,20	○	○	
88,90	2,00	114,0	3D	EB10	0,79	●	●	●
88,90	2,00	205,0	5D	EB11	1,20	○	○	○
88,90	2,60	114,0	3D	EB10	1,01	●	●	●
88,90	3,00	114,0	3D	EB10	1,17	●	●	●
88,90	4,00	114,0	3D	EB10	1,53	●	●	○

*) EN 10253-3 eller/or EN 10254-4 type A

● = voorraad
○ = af fabriek

● = stock
○ = ex works

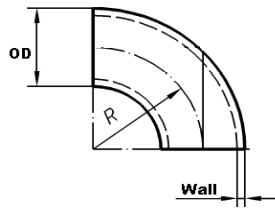

Lasbocht 90° gelast

Elbow 90° welded

EN 10253-4 type A 3D / 1.5d / 1.5ID / ID+100

EN 10204 3.1



OD mm	Wall mm	R	Type	Art. no.	Kg / pc	4301 4307	4404	4571
101,60	2,00	133,0	1.5d	EB15	1,04	●	●	
101,60	3,00	133,0	1.5d	EB15	1,55	●	●	
104,00	2,00	150,0	ID+100	EB25	1,20	●	●	○
106,00	3,00	150,0	1.5ID	EB20	1,80	○	○	
106,00	3,00	200,0	ID+100	EB25	2,40	○	○	
108,00	2,00	142,0	1.5d	EB15	1,18	●	●	
108,00	3,00	142,0	1.5d	EB15	1,76	●	●	
108,00	4,00	142,0	1.5d	EB15	2,35	●	●	
114,30	2,00	152,0	3D	EB10	1,35	●	●	●
114,30	2,00	270,0	5D	EB11	2,30	○	○	○
114,30	2,60	152,0	3D	EB10	1,75	●	●	●
114,30	3,00	152,0	3D	EB10	2,01	●	●	●
114,30	4,00	152,0	3D	EB10	2,65	●	●	○
129,00	2,00	188,0	1.5ID	EB20	1,90	●	●	○
129,00	2,00	225,0	ID+100	EB25	2,40	○	○	
131,00	3,00	225,0	ID+100	EB25	3,00	○	○	
139,70	2,00	190,0	3D	EB10	0,50	●	●	●
139,70	2,60	190,0	3D	EB10	2,68	●	○	●
139,70	3,00	190,0	3D	EB10	3,08	●	●	●
139,70	4,00	190,0	3D	EB10	4,08	●	●	○
154,00	2,00	225,0	1.5ID	EB20	2,70	●	●	○
154,00	2,00	250,0	ID+100	EB25	3,10	○	○	
156,00	3,00	225,0	1.5ID	EB20	4,10	●	●	
156,00	3,00	250,0	ID+100	EB25	4,60	○	○	
168,30	2,00	229,0	3D	EB10	3,00	●	●	●
168,30	2,60	229,0	3D	EB10	3,88	●	○	●
168,30	3,00	229,0	3D	EB10	4,47	●	●	●
168,30	4,00	229,0	3D	EB10	5,90	●	●	○
204,00	2,00	300,0	1.5ID	EB20	4,80	●	●	○
206,00	3,00	300,0	1.5ID	EB20	7,20	●	●	
219,10	2,00	305,0	3D	EB10	5,21	●	●	●
219,10	2,60	305,0	3D	EB10	6,75	●	○	●
219,10	3,00	305,0	3D	EB10	7,78	●	●	●
219,10	4,00	305,0	3D	EB10	10,30	●	●	○
254,00	2,00	*)	350,0	ID+100	EB28	6,94	●	●
254,00	2,00	*)	375,0	1.5ID	EB20	7,40	●	○
256,00	3,00	*)	350,0	ID+100	EB28	10,45	●	●
256,00	3,00	*)	375,0	1.5ID	EB20	11,00	●	●
273,00	2,00	*)	381,0	3D	EB30	8,10	●	●
273,00	2,60	*)	381,0	3D	EB10	10,13	●	○
273,00	3,00	*)	381,0	3D	EB10	12,14	●	●
273,00	4,00	*)	381,0	3D	EB10	16,12	●	○
304,00	2,00	*)	400,0	ID+100	EB28	9,52	●	●
304,00	2,00	*)	450,0	1.5ID	EB20	10,70	●	●
306,00	3,00	*)	400,0	ID+100	EB28	14,30	●	●

*) EN 10253-3 eller/or EN 10254-4 type A

● = voorraad
○ = af fabriek

● = stock
○ = ex works

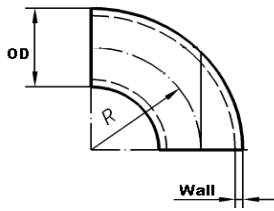

Lasbocht 90° gelast

Elbow 90° welded

EN 10253-4 type A 3D / 1.5d / 1.5ID / ID+100

EN 10204 3.1



OD mm	Wall mm		R	Type	Art. no.	Kg / pc	4301 4307	4404	4571
323,90	2,00	*)	457,0	3D	EB30	11,54	●	●	○
323,90	3,00		457,0	3D	EB10	17,30	●	●	●
323,90	4,00		457,0	3D	EB10	23,00	●	○	●
355,60	3,00		533,0	3D	EB10	22,22	●	●	○
355,60	4,00		533,0	3D	EB10	29,54	●	●	○
356,00	3,00	*)	450,0	ID+100	EB28	18,74	●	●	
406,00	3,00	*)	500,0	ID+100	EB28	23,78	●	●	
406,40	3,00	*)	610,0	3D	EB30	29,04	●	●	○
406,40	4,00	*)	610,0	3D	EB30	38,62	●	●	○
456,00	3,00	*)	550,0	ID+100	EB28	29,40	●	●	
457,20	3,00	*)	686,0	3D	EB30	36,76	●	●	○
457,20	4,00	*)	686,0	3D	EB30	48,90	○	○	○
458,00	4,00	*)	550,0	ID+100	EB28	40,00	○	○	
506,00	3,00	*)	600,0	ID+100	EB28	35,61	●	●	
508,00	3,00	*)	762,0	3D	EB30	45,40	●	●	○
508,00	4,00	*)	600,0	ID+100	EB28	48,00	○	○	
508,00	4,00	*)	762,0	3D	EB30	60,40	○	○	○
606,00	3,00	*)	700,0	ID+100	EB28	48,00	●	●	
608,00	4,00	*)	700,0	ID+100	EB28	66,00	○	○	
609,60	3,00	*)	914,0	3D	EB30	65,40	●	●	●
609,60	4,00	*)	914,0	3D	EB30	87,10	○	○	○

*) EN 10253-3 eller/or EN 10254-4 type A

- = voorraad
- = af fabriek

- = stock
- = ex works

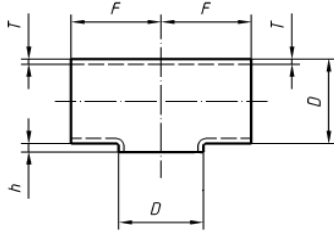

T-stuk, gelast

T-piece welded

EN 10253-4 ISO + pulled(TBT)

EN 10204 3.1

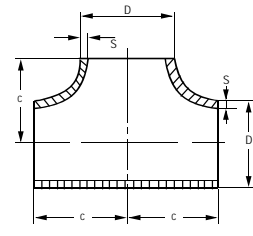

D mm	T mm	Type	F	h	Art. no.	Kg / pc	4301 4307	4404
20,00	2,00	TBT	25,0	10	ET15	0,04	○	●
21,30	2,00	TBT	25,0	12	ET10	0,04	●	●
21,30	2,00	ISO	25,0		ET30	0,07	●	●
21,30	2,60	ISO	25,0		ET30	0,08	●	●
25,00	2,00	TBT	29,0	14	ET15	0,05	○	●
26,90	2,00	TBT	29,0	15	ET10	0,06	●	●
26,90	2,00	ISO	29,0		ET30	0,09	●	●
26,90	2,60	ISO	29,0		ET30	0,10	●	●
30,00	2,00	TBT	38,0	17	ET15	0,06	○	○
33,70	2,00	TBT	38,0	19	ET10	0,11	●	●
33,70	2,00	ISO	38,0		ET30	0,15	●	●
33,70	2,60	ISO	38,0		ET30	0,20	●	●
33,70	3,20	ISO	38,0		ET30	0,24	●	●
38,00	2,00	TBT	48,0	21	ET15	0,13	○	○
42,40	2,00	TBT	48,0	24	ET10	0,18	●	●
42,40	2,00	ISO	48,0		ET30	0,24	●	●
42,40	2,60	ISO	48,0		ET30	0,31	●	●
42,40	3,20	ISO	48,0		ET30	0,37	●	●
44,50	2,00	TBT	57,0	26	ET15	0,15	○	●
48,30	2,00	TBT	57,0	26	ET10	0,24	●	●
48,30	2,00	ISO	57,0		ET30	0,34	●	●
48,30	2,60	ISO	57,0		ET30	0,44	●	●
48,30	3,20	ISO	57,0		ET30	0,52	●	●
54,00	2,00	TBT	64,0	30	ET15	0,22	●	●
57,00	2,00	TBT	64,0	32	ET15	0,35	○	○
60,30	2,00	TBT	64,0	34	ET10	0,35	●	●
60,30	2,00	ISO	64,0		ET30	0,50	●	●
60,30	2,60	ISO	64,0		ET30	0,65	●	●
60,30	3,00	TBT	64,0	34	ET10	0,51	●	●
60,30	3,00	ISO	64,0		ET30	0,75	●	●
60,30	3,60	ISO	64,0		ET30	1,00	●	●
70,00	2,00	TBT	76,0	38	ET15	0,37	○	●
76,10	2,00	TBT	76,0		ET10	0,56	●	●
76,10	3,00	TBT	76,0	42	ET10	0,75	●	●
76,10	3,00	ISO	76,0		ET30	1,05	●	●
84,00	2,00	TBT	86,0	47	ET15	0,63	●	●
88,90	2,00	TBT	86,0	49	ET10	0,68	●	●
88,90	3,00	TBT	86,0	49	ET10	0,97	●	●
88,90	3,00	ISO	86,0		ET30	1,35	●	●
104,00	2,00	TBT	105,0	56	ET15	0,95	●	●
114,30	2,00	TBT	105,0	63	ET10	1,10	●	●
114,30	3,00	TBT	105,0	63	ET10	1,46	●	●
114,30	3,00	ISO	105,0		ET30	2,10	●	●
129,00	2,00	TBT	124,0	70	ET15	1,42	●	●

● = voorraad
○ = af fabriek

● = stock
○ = ex works



T-stuk, gelast

T-piece welded

EN 10253-4 ISO + pulled(TBT)

EN 10204 3.1



D mm	S mm	Type	F	H	Art. no.	Kg / pc	4301 4307	4404
139,70	2,00	TBT	124,0	76	ET10	1,51	●	●
139,70	3,00	TBT	124,0	76	ET10	2,25	●	●
139,70	3,00	ISO	124,0		ER30	3,80	●	●
154,00	2,00	TBT	143,0	84	ET15	2,03	●	●
156,00	3,00	TBT	143,0	85	ET15	3,12	●	●
168,30	2,00	TBT	143,0	92	ET10	2,13	●	●
168,30	3,00	TBT	143,0	92	ET10	3,13	●	●
168,30	3,00	ISO	143,0		ET30	4,80	●	●
204,00	2,00	TBT	178,0	110	ET15	3,79	●	●
206,00	3,00	TBT	178,0	110	ET15	4,69	●	●
219,00	2,00	TBT	178,0	179	ET10	3,37	●	●
219,00	3,00	TBT	178,0	179	ET10	4,91	●	●
219,00	3,00	ISO	178,0		ET30	7,60	●	●
256,00	3,00	TBT	250,0	8	ET15	9,35	●	●
273,00	3,00	TBT	250,0	8	ET10	9,36	●	●
306,00	3,00	TBT	300,0	10	ET15	13,40	●	●
323,90	3,00	TBT	300,0	10	ET10	14,20	●	●
355,60	3,00	TBT	350,0	12	ET10	18,20	●	●
406,40	3,00	TBT	400,0	13	ET10	25,30	●	●
457,20	3,00		450,0			34,70	○	○
508,00	3,00		500,0			42,80	○	○
609,60	4,00		600,0			81,80	○	○

● = voorraad
○ = af fabriek

● = stock
○ = ex works

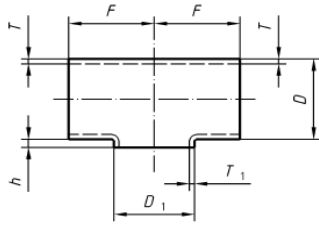

Verloop T-stuk, gelast

Reducing tee welded

EN 10253-4 figure 5 (ISO) + pulled figure 6 (TBT)

EN 10204 3.1

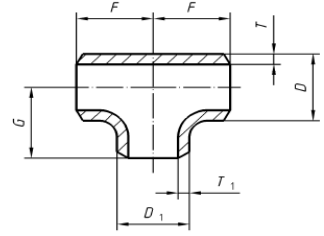

D mm	D 1 mm	T mm	T 1 mm	Type	F	h	Art. no.	Kg / pc	4301 4307	4404
25,00	20,00	2,00	2,00	TBT	29	14	ET45	0,05	○	●
26,90	21,30	2,00	2,00	TBT	29	15	ET40	0,06	○	●
26,90	21,30	2,00	2,00	ISO	29	29	ET20	0,34	●	●
26,90	21,30	2,60	2,60	ISO	29	29	ET20	0,34	●	●
30,00	20,00	2,00	2,00	TBT	38	17	ET45	0,06	○	●
30,00	25,00	2,00	2,00	TBT	38	17	ET45	0,06	○	●
33,70	21,30	2,00	2,00	TBT	38	19	ET40	0,11	○	●
33,70	21,30	2,00	2,00	ISO	38	38	ET20	0,25	●	●
33,70	21,30	2,60	2,60	ISO	38	38	ET20	0,33	●	●
33,70	26,90	2,00	2,00	TBT	38	19	ET40	0,11	○	●
33,70	26,90	2,00	2,00	ISO	38	38	ET20	0,25	●	●
33,70	26,90	2,60	2,60	ISO	38	38	ET20	0,34	●	●
38,00	20,00	2,00	2,00	TBT	48	21	ET45	0,14	○	●
38,00	25,00	2,00	2,00	TBT	48	21	ET45	0,13	○	●
42,40	21,30	2,00	2,00	TBT	48	24	ET40	0,18	○	●
42,40	21,30	2,00	2,00	ISO	48	48	ET20	0,79	●	●
42,40	21,30	2,60	2,60	ISO	48	48	ET20	1,03	●	●
42,40	26,90	2,00	2,00	TBT	48	24	ET40	0,18	○	●
42,40	26,90	2,00	2,00	ISO	48	48	ET20	0,79	●	●
42,40	26,90	2,60	2,60	ISO	48	48	ET20	1,03	●	●
42,40	33,70	2,00	2,00	TBT	48	24	ET40	0,18	○	●
42,40	33,70	2,00	2,00	ISO	48	48	ET20	0,60	●	●
42,40	33,70	2,60	2,60	ISO	48	48	ET20	0,80	●	●
42,40	33,70	3,20	3,20	ISO	48	48	ET20	1,10	●	●
44,50	20,00	2,00	2,00	TBT	57	48	ET45	0,14	○	●
44,50	25,00	2,00	2,00	TBT	57	48	ET45	0,14	○	●
44,50	30,00	2,00	2,00	TBT	57	48	ET45	0,14	○	●
48,30	21,30	2,00	2,00	TBT	57	26	ET40	0,24	○	●
48,30	21,30	2,00	2,00	ISO	57	57	ET20	1,10	●	●
48,30	21,30	2,60	2,60	ISO	57	57	ET20	1,40	●	●
48,30	26,90	2,00	2,00	TBT	57	26	ET40	0,24	○	●
48,30	26,90	2,00	2,00	ISO	57	57	ET20	1,00	●	●
48,30	26,90	2,60	2,60	ISO	57	57	ET20	1,30	●	●
48,30	33,70	2,00	2,00	TBT	57	26	ET40	0,24	○	●
48,30	33,70	2,00	2,00	ISO	57	57	ET20	0,80	●	●
48,30	33,70	2,60	2,60	ISO	57	57	ET20	1,10	●	●
48,30	33,70	3,20	3,20	ISO	57	57	ET20	1,40	●	●
48,30	42,40	2,00	2,00	TBT	57	26	ET40	0,24	○	●
48,30	42,40	2,00	2,00	ISO	57	57	ET20	0,80	●	●
48,30	42,40	2,60	2,60	ISO	57	57	ET20	1,00	●	●
48,30	42,40	3,20	3,20	ISO	57	57	ET20	1,30	●	●
54,00	30,00	2,00	2,00	TBT	64	30	ET45	0,34	○	●
54,00	44,50	2,00	2,00	TBT	64	30	ET45	0,34	○	●

● = voorraad
○ = af fabriek

● = stock
○ = ex works



Verloop T-stuk, gelast

Reducing tee welded

EN 10253-4 figure 5 (ISO) + pulled figure 6 (TBT)

EN 10204 3.1



D mm	D 1 mm	T mm	T 1 mm	Type	F	h	Art. no.	Kg / pc	4301 4307	4404
60,30	21,30	2,00	2,00	TBT	64	34	ET40	0,35	○	○
60,30	21,30	2,00	2,00	ISO	64	51	ET20	1,30	●	●
60,30	21,30	2,60	2,60	ISO	64	51	ET20	1,60	●	●
60,30	26,90	2,00	2,00	TBT	64	51	ET40	1,30	○	○
60,30	26,90	2,00	2,00	ISO	64	51	ET20	1,20	●	●
60,30	26,90	2,60	2,60	ISO	64	41	ET20	1,50	●	●
60,30	33,70	2,00	2,00	TBT	64	41	ET40	1,50	○	●
60,30	33,70	2,00	2,00	ISO	64	51	ET20	1,10	●	●
60,30	33,70	2,60	2,60	ISO	64	51	ET20	1,40	●	●
60,30	42,40	2,00	2,00	TBT	64	51	ET40	1,30	○	●
60,30	42,40	2,00	2,00	ISO	64	57	ET20	1,10	●	●
60,30	42,40	2,60	2,60	ISO	64	57	ET20	1,40	●	●
60,30	48,30	2,00	2,00	TBT	64	41	ET40	1,50	○	●
60,30	48,30	2,00	2,00	ISO	64	60	ET20	1,10	●	●
60,30	48,30	2,60	2,60	ISO	64	60	ET20	1,40	●	●
70,00	44,50	2,00	2,00	TBT	76	38	ET45	0,37	○	●
70,00	54,00	2,00	2,00	TBT	76	38	ET45	0,37	○	●
76,10	33,70	2,00	2,00	TBT	76	42	ET40	0,53	○	○
76,10	42,40	2,00	2,00	TBT	76	42	ET40	0,53	○	●
76,10	48,30	2,00	2,00	TBT	76	42	ET40	0,53	○	●
76,10	60,30	2,00	2,00	TBT	76	42	ET40	0,53	○	●
76,10	60,30	3,00	3,00	TBT	76	42	ET40	0,75	○	●
76,10	60,30	3,00	3,00	ISO	76	70	ET20	3,20	●	●
84,00	44,50	2,00	2,00	TBT	86	47	ET45	0,63	○	●
84,00	54,00	2,00	2,00	TBT	86	47	ET45	0,63	○	●
88,90	48,30	2,00	2,00	TBT	86	49	ET40	0,68	○	○
88,90	60,30	2,00	2,00	TBT	86	49	ET40	0,68	○	●
88,90	60,30	3,00	3,00	TBT	86	49	ET40	0,97	○	●
88,90	60,30	3,00	3,00	ISO	86	76	ET20	2,10	●	●
88,90	76,10	2,00	2,00	TBT	86	49	ET40	0,68	○	●
88,90	76,10	3,00	3,00	TBT	86	49	ET40	0,97	○	●
88,90	76,10	3,00	3,00	ISO	86	83	ET20	2,40	●	●
104,00	54,00	2,00	2,00	TBT	105	57	ET45	0,95	○	●
104,00	84,00	2,00	2,00	TBT	105	57	ET45	0,95	○	●
114,30	60,30	2,00	2,00	TBT	105	63	ET40	1,10	○	●
114,30	60,30	3,00	3,00	TBT	105	63	ET40	1,64	○	●
114,30	60,30	3,00	3,00	ISO	105	89	ET20	3,80	●	●
114,30	76,10	2,00	2,00	TBT	105	63	ET40	1,10	○	●
114,30	76,10	3,00	3,00	TBT	105	63	ET40	1,64	○	●
114,30	76,10	3,00	3,00	ISO	105	95	ET20	3,70	●	●
114,30	88,90	2,00	2,00	TBT	105	63	ET40	1,10	○	●
114,30	88,90	3,00	3,00	TBT	105	63	ET40	1,64	○	●
114,30	88,90	3,00	3,00	ISO	105	98	ET20	3,60	●	●
129,00	84,00	2,00	2,00	TBT	124	70	ET45	1,42	○	●
129,00	104,00	2,00	2,00	TBT	124	70	ET45	1,42	○	●

● = voorraad
○ = af fabriek

● = stock
○ = ex works

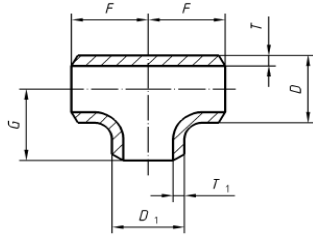

Verloop T-stuk, gelast

Reducing tee welded

EN 10253-4 figure 5 (ISO) + pulled figure 6 (TBT)

EN 10204 3.1

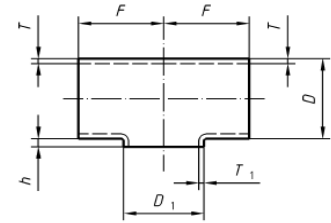

D mm	D 1 mm	T mm	T 1 mm	Type	F	h	Art. no.	Kg / pc	4301 4307	4404
139,70	76,10	2,00	2,00	TBT	124	76	ET40	1,51	○	●
139,70	76,10	3,00	3,00	TBT	124	76	ET40	2,25	○	●
139,70	76,10	3,00	3,00	ISO	124	108	ET20	2,90	●	●
139,70	88,90	2,00	2,00	TBT	124	76	ET40	1,51	○	●
139,70	88,90	3,00	3,00	TBT	124	76	ET40	2,25	○	●
139,70	88,90	3,00	3,00	ISO	124	111	ET20	2,70	●	●
139,70	114,30	2,00	2,00	TBT	124	76	ET40	1,51	○	●
139,70	114,30	3,00	3,00	TBT	124	76	ET40	2,25	○	●
139,70	114,30	3,00	3,00	ISO	124	117	ET20	2,60	●	●
154,00	84,00	2,00	2,00	TBT	143	84	ET45	2,00	○	●
154,00	104,00	2,00	2,00	TBT	143	84	ET45	2,00	○	●
154,00	129,00	2,00	2,00	TBT	143	84	ET45	2,00	○	●
168,30	76,10	2,00	2,00	TBT	143	92	ET40	2,13	○	●
168,30	76,10	3,00	3,00	TBT	143	92	ET40	3,13	○	●
168,30	88,90	2,00	2,00	TBT	143	92	ET40	2,13	○	●
168,30	88,90	3,00	3,00	TBT	143	92	ET40	3,13	○	●
168,30	88,90	3,00	3,00	ISO	143	124	ET20	6,60	●	●
168,30	114,30	2,00	2,00	TBT	143	92	ET40	2,13	○	●
168,30	114,30	3,00	3,00	TBT	143	92	ET40	3,13	○	●
168,30	114,30	3,00	3,00	ISO	143	130	ET20	6,50	●	●
168,30	139,70	2,00	2,00	TBT	143	92	ET40	2,13	○	●
168,30	139,70	3,00	3,00	TBT	143	92	ET40	3,13	○	●
168,30	139,70	3,00	3,00	ISO	143	137	ET20	6,30	●	●
204,00	104,00	2,00	2,00	TBT	178	110	ET45	3,80	○	●
204,00	129,00	2,00	2,00	TBT	178	110	ET45	3,80	○	●
204,00	154,00	2,00	2,00	TBT	178	110	ET45	3,80	○	●
206,00	156,00	3,00	3,00	TBT	178	110	ET45	4,70	○	●
219,10	114,30	2,00	2,00	TBT	178	122	RT40	3,37	○	●
219,10	114,30	3,00	3,00	TBT	178	122	ET40	4,91	○	●
219,10	114,30	3,00	3,00	ISO	178	156	ET20	7,50	●	●
219,10	139,70	2,00	2,00	TBT	178	122	ET40	3,37	○	●
219,10	139,70	3,00	3,00	TBT	178	122	ET40	4,91	○	●
219,10	139,70	3,00	3,00	ISO	178	162	ET20	7,50	●	●
219,10	168,30	2,00	2,00	TBT	178	122	ET40	3,37	○	●
219,10	168,30	3,00	3,00	TBT	178	122	ET40	4,91	○	●
219,10	168,30	3,00	3,00	ISO	178	168	ET20	7,50	●	●

● = voorraad
○ = af fabriek

● = stock
○ = ex works

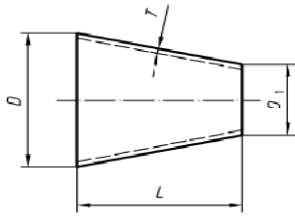

Lasverloop (concentrisch), gelast

Reducer (concentric), welded

EN 10254-4 type A ISO + 3x(D-d)

EN 10204 3.1

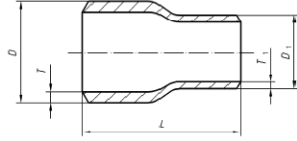

D mm	d	S	S	Type ISO 3(D-d)	l	Art. no.	Kg / pc	4301 4307	4404
17,20	13,50	2,00	2,00	3(D-d)	11,10	ER10	0,007	○	●
21,30	13,50	2,00	2,00	3(D-d)	23,40	ER10	0,018	○	●
21,30	17,20	2,00	2,00	3(D-d)	12,30	ER10	0,011	○	●
25,00	20,00	2,00	2,00	3(D-d)	15,00	ER11	0,015	○	●
26,90	13,50	2,00	2,00	3(D-d)	40,20	ER10	0,037	○	●
26,90	17,20	2,00	2,00	3(D-d)	29,10	ER10	0,029	○	●
26,90	21,30	2,00	2,00	3(D-d)	16,80	ER10	0,019	●	●
26,90	21,30	2,00	2,00	ISO	38,00	ER30	0,042	●	●
30,00	20,00	2,00	2,00	3(D-d)	30,00	ER11	0,035	○	●
30,00	25,00	2,00	2,00	3(D-d)	38,00	ER11	0,049	○	●
33,70	13,50	2,00	2,00	3(D-d)	60,60	ER10	0,066	○	●
33,70	17,20	2,00	2,00	3(D-d)	38,00	ER10	0,045	○	●
33,70	21,30	2,00	2,00	3(D-d)	37,20	ER10	0,051	●	●
33,70	21,30	2,00	2,00	ISO	51,00	ER30	0,065	●	●
33,70	21,30	2,60	2,60	ISO	51,00	ER30	0,083	●	●
33,70	26,90	2,00	2,00	3(D-d)	20,40	ER10	0,029	●	●
33,70	26,90	2,00	2,00	ISO	51,00	ER30	0,072	●	●
33,70	26,90	2,60	2,60	ISO	51,00	ER30	0,092	●	●
38,00	20,00	2,00	2,00	3(D-d)	54,00	ER11	0,073	○	●
38,00	25,00	2,00	2,00	3(D-d)	39,00	ER11	0,058	○	●
42,40	13,50	2,00	2,00	3(D-d)	86,70	ER10	0,113	○	●
42,40	17,20	2,00	2,00	3(D-d)	38,00	ER10	0,053	○	●
42,40	21,30	2,00	2,00	3(D-d)	63,30	ER10	0,095	●	●
42,40	21,30	2,00	2,00	ISO	51,00	ER30	0,076	●	●
42,40	21,30	2,60	2,60	ISO	51,00	ER30	0,051	●	●
42,40	26,90	2,00	2,00	3(D-d)	46,50	ER10	0,076	●	●
42,40	26,90	2,00	2,00	ISO	51,00	ER30	0,083	●	●
42,40	26,90	2,60	2,60	ISO	51,00	ER30	0,106	●	●
42,40	33,70	2,00	2,00	3(D-d)	26,10	ER10	0,047	●	●
42,40	33,70	2,00	2,00	ISO	51,00	ER30	0,092	●	●
42,40	33,70	2,60	2,60	ISO	51,00	ER30	0,118	●	●
42,40	33,70	3,20	3,20	ISO	51,00	ER30	0,142	●	●
44,50	20,00	2,00	2,00	3(D-d)	73,50	ER10	0,111	○	●
44,50	25,00	2,00	2,00	3(D-d)	58,50	ER10	0,096	○	●
44,50	30,00	2,00	2,00	3(D-d)	43,50	ER11	0,077	○	●

● = voorraad
○ = af fabriek

● = stock
○ = ex works



Lasverloop (concentrisch), gelast

Reducer (concentric), welded

EN 10254-4 type A ISO + 3x(D-d)

EN 10204 3.1



D mm	D 1	T	T	Type ISO 3(D-d)	L	Art. no.	Kg / pc	4301 4307	4404
48,30	17,20	2,00	2,00	3(D-d)	38,00	ER10	0,059	○	○
48,30	21,30	2,00	2,00	3(D-d)	81,00	ER10	0,051	●	●
48,30	21,30	2,00	2,00	ISO	64,00	ER30	0,105	●	●
48,30	21,30	2,60	2,60	ISO	64,00	ER30	0,134	●	●
48,30	26,90	2,00	2,00	3(D-d)	64,20	ER10	0,114	●	●
48,30	26,90	2,00	2,00	ISO	64,00	ER30	0,114	●	●
48,30	26,90	2,60	2,60	ISO	64,00	ER30	0,146	●	●
48,30	33,70	2,00	2,00	3(D-d)	43,80	ER10	0,086	●	●
48,30	33,70	2,00	2,00	ISO	64,00	ER30	0,125	●	●
48,30	33,70	2,60	2,60	ISO	64,00	ER30	0,160	●	●
48,30	33,70	3,20	3,20	ISO	64,00	ER30	0,194	●	●
48,30	42,40	2,00	2,00	3(D-d)	17,70	ER10	0,038	●	●
48,30	42,40	2,00	2,00	ISO	64,00	ER30	0,139	●	●
48,30	42,40	2,60	2,60	ISO	64,00	ER30	0,051	●	●
48,30	42,40	3,20	3,20	ISO	64,00	ER30	0,216	●	●
54,00	30,00	2,00	2,00	3(D-d)	72,00	ER11	0,144	○	●
54,00	44,50	2,00	2,00	3(D-d)	28,50	ER11	0,067	○	●
60,30	21,30	2,00	2,00	3(D-d)	117,00	ER10	0,227	○	●
60,30	21,30	2,00	2,00	ISO	76,00	ER30	0,148	●	●
60,30	21,30	2,60	2,60	ISO	76,00	ER30	0,189	●	●
60,30	26,90	2,00	2,00	3(D-d)	100,20	ER10	0,209	○	●
60,30	26,90	2,00	2,00	ISO	76,00	ER30	0,158	●	●
60,30	26,90	2,60	2,60	ISO	76,00	ER30	0,203	●	●
60,30	33,70	2,00	2,00	3(D-d)	79,80	ER10	0,180	●	●
60,30	33,70	2,00	2,00	ISO	76,00	ER30	0,171	●	●
60,30	33,70	2,60	2,60	ISO	76,00	ER30	0,051	●	●
60,30	42,40	2,00	2,00	3(D-d)	53,70	ER10	0,133	●	●
60,30	42,40	2,00	2,00	ISO	76,00	ER30	0,188	●	●
60,30	42,40	2,60	2,60	ISO	76,00	ER30	0,241	●	●
60,30	48,30	2,00	2,00	3(D-d)	36,00	ER10	0,094	●	●
60,30	48,30	2,00	2,00	ISO	76,00	ER30	0,199	●	●
60,30	48,30	2,60	2,60	ISO	76,00	ER30	0,256	●	●
70,00	44,50	2,00	2,00	3(D-d)	76,50	ER11	0,212	○	●
70,00	54,00	2,00	2,00	3(D-d)	48,00	ER11	0,144	○	●
76,10	33,70	2,00	2,00	3(D-d)	127,20	ER10	0,337	○	●
76,10	42,40	2,00	2,00	3(D-d)	101,10	ER10	0,290	○	●
76,10	48,30	2,00	2,00	3(D-d)	83,40	ER10	0,251	●	●
76,10	60,30	2,00	2,00	3(D-d)	47,40	ER10	0,051	●	●
76,10	60,30	3,00	3,00	3(D-d)	47,40	ER10	0,232	●	●
76,10	60,30	3,00	3,00	ISO	89,00	ER30	0,436	●	●
84,00	44,50	2,00	2,00	3(D-d)	118,50	ER11	0,369	○	●
84,00	54,00	2,00	2,00	3(D-d)	90,00	ER11	0,302	●	●
84,00	70,00	2,00	2,00	3(D-d)	42,00	ER11	0,158	○	●

● = voorraad
○ = af fabriek

● = stock
○ = ex works

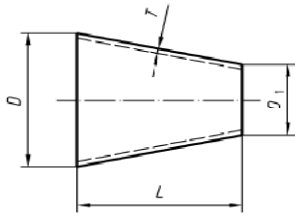

Lasverloop (concentrisch), gelast

Reducer (concentric), welded

EN 10254-4 type A ISO + 3x(D-d)

EN 10204 3.1

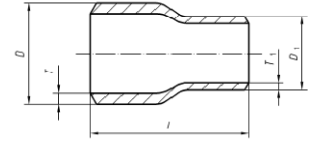

D mm	D1	T	T	Type ISO 3(D-d)	L	Art. no.	Kg / pc	4301 4307	4404
88,90	33,70	2,00	2,00	3(D-d)	165,60	ER10	0,492	○	●
88,90	42,40	2,00	2,00	3(D-d)	139,50	ER10	0,445	○	●
88,90	48,30	2,00	2,00	3(D-d)	121,80	ER10	0,406	●	●
88,90	60,30	2,00	2,00	3(D-d)	85,80	ER10	0,312	●	●
88,90	60,30	3,00	3,00	3(D-d)	85,80	ER10	0,461	●	●
88,90	60,30	3,00	3,00	ISO	89,00	ER30	0,479	●	●
88,90	76,10	2,00	2,00	3(D-d)	38,40	ER10	0,051	●	●
88,90	76,10	3,00	3,00	3(D-d)	38,40	ER10	0,229	●	●
88,90	76,10	3,00	3,00	ISO	89,00	ER30	0,532	●	●
104,00	54,00	2,00	2,00	3(D-d)	150,00	ER11	0,578	●	●
104,00	70,00	2,00	2,00	3(D-d)	102,00	ER11	0,434	○	●
104,00	76,10	2,00	2,00	3(D-d)	83,70	ER11	0,369	●	●
104,00	84,00	2,00	2,00	3(D-d)	60,00	ER11	0,276	●	●
114,30	33,70	2,00	2,00	3(D-d)	241,80	ER10	0,872	○	●
114,30	42,40	2,00	2,00	3(D-d)	215,70	ER10	0,825	○	●
114,30	48,30	2,00	2,00	3(D-d)	198,00	ER10	0,786	○	●
114,30	60,30	2,00	2,00	3(D-d)	162,00	ER10	0,692	●	●
114,30	60,30	3,00	3,00	3(D-d)	162,00	ER10	1,026	●	●
114,30	60,30	3,00	3,00	ISO	102,00	ER30	0,051	●	●
114,30	76,10	2,00	2,00	3(D-d)	114,60	ER10	0,535	●	●
114,30	76,10	3,00	3,00	3(D-d)	114,60	ER10	0,794	●	●
114,30	76,10	3,00	3,00	ISO	102,00	ER30	0,706	●	●
114,30	88,90	2,00	2,00	3(D-d)	76,20	ER10	0,380	●	●
114,30	88,90	3,00	3,00	3(D-d)	76,20	ER10	0,564	●	●
114,30	88,90	3,00	3,00	ISO	102,00	ER30	0,755	●	●
129,00	70,00	2,00	2,00	3(D-d)	177,00	ER11	0,864	○	○
129,00	76,10	2,00	2,00	3(D-d)	158,70	ER11	0,799	●	●
129,00	84,00	2,00	2,00	3(D-d)	135,00	ER11	0,707	●	●
129,00	104,00	2,00	2,00	3(D-d)	75,00	ER11	0,430	●	●
139,70	60,30	2,00	2,00	3(D-d)	238,20	ER10	1,169	○	●
139,70	60,30	3,00	3,00	3(D-d)	238,20	ER10	0,051	○	●
139,70	76,10	2,00	2,00	3(D-d)	190,80	ER10	1,012	○	●
139,70	76,10	3,00	3,00	3(D-d)	190,80	ER10	1,504	○	●
139,70	76,10	3,00	3,00	ISO	127,00	ER30	1,001	●	●
139,70	88,90	2,00	2,00	3(D-d)	152,40	ER10	0,857	●	●
139,70	88,90	3,00	3,00	3(D-d)	152,40	ER10	1,274	●	●
139,70	88,90	3,00	3,00	ISO	127,00	ER30	1,062	●	●
139,70	114,30	2,00	2,00	3(D-d)	76,20	ER10	0,477	●	●
139,70	114,30	3,00	3,00	3(D-d)	76,20	ER10	0,710	●	●
139,70	114,30	3,00	3,00	ISO	127,00	ER30	1,183	●	●
154,00	84,00	2,00	2,00	3(D-d)	210,00	ER11	1,230	○	●
154,00	104,00	2,00	2,00	3(D-d)	150,00	ER11	0,954	●	●
154,00	129,00	2,00	2,00	3(D-d)	75,00	ER11	0,051	●	●

● = voorraad
○ = af fabriek

● = stock
○ = ex works



Lasverloop (concentrisch), gelast

Reducer (concentric), welded

EN 10254-4 type A ISO + 3x(D-d)

EN 10204 3.1



D mm	D1	T	T	Type ISO 3(D-d)	L	Art. no.	Kg / pc	4301 4307	4404
168,30	60,30	2,00	2,00	3(D-d)	324,00	ER10	1,822	○	●
168,30	60,30	3,00	3,00	3(D-d)	324,00	ER10	2,709	○	●
168,30	76,10	2,00	2,00	3(D-d)	276,60	ER10	1,665	○	●
168,30	76,10	3,00	3,00	3(D-d)	276,60	ER10	2,477	○	●
168,30	76,10	3,00	3,00	ISO	140,00	ER30	1,254	●	●
168,30	88,90	2,00	2,00	3(D-d)	238,20	ER10	1,510	●	●
168,30	88,90	3,00	3,00	3(D-d)	140,00	ER10	1,321	●	●
168,30	88,90	3,00	3,00	ISO	127,00	ER30	1,198	●	●
168,30	114,30	2,00	2,00	3(D-d)	162,00	ER10	1,130	●	●
168,30	114,30	3,00	3,00	3(D-d)	162,00	ER10	1,683	●	●
168,30	114,30	3,00	3,00	ISO	140,00	ER30	1,454	●	●
168,30	139,70	2,00	2,00	3(D-d)	85,80	ER10	0,051	●	●
168,30	139,70	3,00	3,00	3(D-d)	85,80	ER10	0,973	●	●
168,30	139,70	3,00	3,00	ISO	140,00	ER30	1,588	●	●
204,00	84,00	2,00	2,00	3(D-d)	360,00	ER11	2,560	○	●
204,00	104,00	2,00	2,00	3(D-d)	300,00	ER11	2,284	●	●
204,00	129,00	2,00	2,00	3(D-d)	225,00	ER11	1,854	●	●
204,00	154,00	2,00	2,00	3(D-d)	150,00	ER11	1,330	●	●
206,00	156,00	3,00	3,00	3(D-d)	150,00	ER11	2,006	●	●
219,10	114,30	2,00	2,00	3(D-d)	314,40	ER10	2,593	●	●
219,10	114,30	3,00	3,00	3(D-d)	314,40	ER10	3,866	●	●
219,10	114,30	3,00	3,00	ISO	178,00	ER30	2,189	●	●
219,10	139,70	2,00	2,00	3(D-d)	238,20	ER10	2,116	●	●
219,10	139,70	3,00	3,00	3(D-d)	238,20	ER10	0,051	●	●
219,10	139,70	3,00	3,00	ISO	178,00	ER30	2,359	●	●
219,10	168,30	2,00	2,00	3(D-d)	152,40	ER10	1,463	●	●
219,10	168,30	3,00	3,00	3(D-d)	152,40	ER10	2,183	●	●
219,10	168,30	3,00	3,00	ISO	178,00	ER30	2,550	●	●
219,10	168,30	4,00	4,00	3(D-d)	152,40	ER10	2,896	●	●
254,00	154,00	2,00	2,00	3(D-d)	300,00	ER11	3,035	●	●
254,00	204,00	2,00	2,00	3(D-d)	150,00	ER11	1,705	●	●
256,00	156,00	3,00	3,00	3(D-d)	300,00	ER11	4,575	●	●
256,00	206,00	3,00	3,00	3(D-d)	150,00	ER11	2,569	●	●
273,00	168,30	2,00	2,00	3(D-d)	314,10	ER10	3,439	●	●
273,00	168,30	3,00	3,00	3(D-d)	314,10	ER10	5,135	●	●
273,00	168,30	4,00	2,00	3(D-d)	314,10	ER10	0,051	●	●
273,00	219,10	2,00	2,00	3(D-d)	161,70	ER10	1,976	●	●
273,00	219,10	3,00	3,00	3(D-d)	161,70	ER10	2,952	●	●
273,00	219,10	4,00	4,00	3(D-d)	161,70	ER10	3,920	●	●
304,00	204,00	2,00	2,00	3(D-d)	300,00	ER11	3,786	●	●
304,00	254,00	2,00	2,00	3(D-d)	150,00	ER11	2,081	●	●
306,00	206,00	3,00	3,00	3(D-d)	300,00	ER11	5,702	●	●

● = voorraad
○ = af fabriek

● = stock
○ = ex works

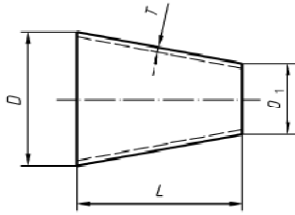

Lasverloop (concentrisch), gelast

Reducer (concentric), welded

EN 10254-4 type A ISO + 3x(D-d)

EN 10204 3.1

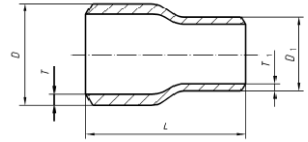

D mm	D1	T	T	Type ISO 3(D-d)	L	Art. no.	Kg / pc	4301 4307	4404
323,90	219,10	2,00	2,00	3(D-d)	314,40	ER10	4,243	●	●
323,90	219,10	3,00	3,00	3(D-d)	314,40	ER10	6,341	●	●
323,90	219,10	4,00	4,00	3(D-d)	314,40	ER10	8,424	●	●
323,90	273,00	2,00	2,00	3(D-d)	152,70	ER10	2,267	●	●
323,90	273,00	3,00	3,00	3(D-d)	152,70	ER10	3,389	●	●
323,90	273,00	4,00	4,00	3(D-d)	152,70	ER10	0,051	●	●
356,00	256,00	3,00	3,00	3(D-d)	300,00	ER11	6,828	○	○
356,00	306,00	3,00	3,00	3(D-d)	150,00	ER11	3,696	○	○
406,00	306,00	3,00	3,00	3(D-d)	300,00	ER11	7,955	○	○
406,00	356,00	3,00	3,00	3(D-d)	150,00	ER11	4,259	○	○
406,40	323,90	3,00	3,00	3(D-d)	247,50	ER10	6,733	●	●
406,40	323,90	4,00	4,00	3(D-d)	247,50	ER10	8,953	●	●
406,40	355,60	3,00	3,00	3(D-d)	152,40	ER10	4,327	●	●
406,40	355,60	4,00	4,00	3(D-d)	152,40	ER10	5,755	●	●
456,00	356,00	3,00	3,00	3(D-d)	300,00	ER11	9,082	○	○
456,00	406,00	3,00	3,00	3(D-d)	150,00	ER11	4,823	○	○
457,20	406,40	3,00	3,00	3(D-d)	152,40	ER10	4,909	●	●
506,00	306,00	3,00	3,00	3(D-d)	600,00	ER11	18,164	○	○
506,00	406,00	3,00	3,00	3(D-d)	300,00	ER11	10,209	○	○
508,00	406,40	3,00	3,00	3(D-d)	304,80	ER10	10,400	●	●
508,00	457,20	3,00	3,00	3(D-d)	152,40	ER10	5,491	●	●
609,60	406,40	3,00	3,00	3(D-d)	609,60	ER10	23,126	●	●
609,60	457,20	3,00	3,00	3(D-d)	457,20	ER10	18,217	●	●
609,60	508,00	3,00	3,00	3(D-d)	304,80	ER10	12,726	●	●

● = voorraad
○ = af fabriek

● = stock
○ = ex works

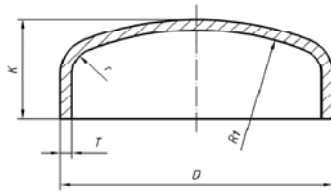

Laskap

End cap

ISO, Metric, EN 10254-4 tp A

EN 10204 3.1



D mm	T mm	K	r	R 1	Type	Art. no.	Kg / pc	4301 4307	4404
17,20	2,00	11,5	1,3	13,2	ISO	EE10	0,090	●	●
20,00	2,00	12,0	1,6	16,0	Metric	EE15	0,011	○	●
21,30	2,00	14,5	1,7	17,3	ISO	EE10	0,015	●	●
21,30	2,00	25,0	3,2	17,0	EN 10254-4	EE30	0,050	●	●
21,30	2,60	25,0	3,2	17,0	EN 10254-4	EE30	0,080	●	●
21,30	3,00	15,5	1,5	15,3	ISO	EE10	0,023	●	●
25,00	2,00	12,0	2,1	21,0	Metric	EE15	0,016	○	●
26,90	2,00	10,5	2,3	22,9	ISO	EE10	0,015	●	●
26,90	2,00	25,0	4,0	21,5	EN 10254-4	EE30	0,060	●	●
26,90	2,60	25,0	4,0	21,5	EN 10254-4	EE30	0,080	●	●
26,90	3,00	12,0	2,1	20,9	ISO	EE10	0,023	●	●
28,00	2,00	12,0	2,4	24,0	Metric	EE15	0,022	○	●
30,00	2,00	12,0	2,6	26,0	Metric	EE15	0,024	○	●
33,70	2,00	12,5	3,0	29,7	ISO	EE10	0,023	●	●
33,70	2,00	38,0	5,1	27,0	EN 10254-4	EE30	0,058	●	●
33,70	2,60	38,0	5,1	27,0	EN 10254-4	EE30	0,075	●	●
33,70	3,00	14,5	2,8	27,7	ISO	EE10	0,035	●	●
33,70	3,20	38,0	5,1	27,0	EN 10254-4	EE30	0,090	●	●
38,00	2,00	15,0	3,4	34,0	Metric	EE15	0,034	○	●
40,00	2,00	14,0	3,6	36,0	Metric	EE15	0,033	○	●
42,40	2,00	17,0	3,8	38,4	ISO	EE10	0,042	●	●
42,40	2,00	38,0	6,4	33,9	EN 10254-4	EE30	0,077	●	●
42,40	2,60	38,0	6,4	33,9	EN 10254-4	EE30	0,100	●	●
42,40	3,00	18,0	3,6	36,4	ISO	EE10	0,063	●	●
42,40	3,20	38,0	6,4	33,9	EN 10254-4	EE30	0,120	●	●
44,50	2,00	16,0	4,1	40,5	Metric	EE15	0,042	○	●
48,30	2,00	17,0	4,4	44,3	ISO	EE10	0,050	●	●
48,30	2,00	38,0	7,2	38,6	EN 10254-4	EE30	0,100	●	●
48,30	2,60	38,0	7,2	38,6	EN 10254-4	EE30	0,130	●	●
48,30	3,00	23,0	4,2	42,3	ISO	EE10	0,115	●	●
48,30	3,20	38,0	7,2	38,6	EN 10254-4	EE30	0,150	●	●
50,80	2,00	19,0	4,7	46,8	Metric	EE15	0,055	●	●
54,00	2,00	19,0	5,0	50,0	Metric	EE15	0,058	●	●
56,00	3,00	19,0	5,0	50,0	Metric	EE16	0,115	○	○
57,00	2,00	22,0	5,3	53,0	Metric	EE16	0,076	●	●
57,00	3,00	22,0	5,1	51,0	Metric	EE16	0,110	●	●
60,30	2,00	20,0	5,6	56,3	ISO	EE10	0,076	●	●
60,30	2,00	38,0	9,0	48,2	EN 10254-4	EE30	0,146	●	●
60,30	2,60	38,0	9,0	48,2	EN 10254-4	EE30	0,190	●	●
60,30	3,00	22,0	5,4	54,3	ISO	EE10	0,115	●	●
60,30	3,00	38,0	9,0	48,2	EN 10254-4	EE30	0,217	●	●
60,30	3,60	38,0	9,0	48,2	EN 10254-4	EE30	0,260	●	●
60,30	4,00	22,0	5,2	52,3	ISO	EE10	0,153	●	●
63,50	2,00	19,0	6,0	59,5	Metric	EE15	0,078	●	●
70,00	2,00	21,0	6,6	66,0	Metric	EE15	0,097	●	●
70,00	3,00	21,0	6,4	64,0	Metric	EE15	0,099	●	○
71,00	3,00	21,0	6,5	65,0	Metric	EE16	0,099	○	○

● = voorraad

● = stock

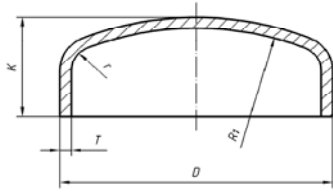

Laskap

End cap

ISO, Metric, EN 10254-4 tp A

EN 10204 3.1



D mm	T mm	K	r	R 1	Type	Art. no.	Kg / pc	4301 4307	4404
76,10	2,00	27,0	7,2	72,1	ISO	EE10	0,131	●	●
76,10	3,00	29,0	7,0	70,1	ISO	EE10	0,196	●	●
76,10	3,00	38,0	11,4	60,9	EN 10254-4	EE30	0,240	●	●
76,10	4,00	29,0	6,8	68,1	ISO	EE10	0,261	●	●
84,00	2,00	23,0	8,0	80,0	Metric	EE15	0,131	●	●
86,00	3,00	23,0	8,0	80,0	Metric	EE16	0,200	○	○
88,90	2,00	29,0	8,5	84,9	ISO	EE10	0,166	●	●
88,90	3,00	29,0	8,3	82,9	ISO	EE10	0,249	●	●
88,90	3,00	51,0	13,3	71,1	EN 10254-4	EE30	0,370	●	●
88,90	4,00	29,0	8,1	80,9	ISO	EE10	0,332	●	●
104,00	2,00	24,0	10,0	100,0	Metric	EE15	0,187	●	●
106,00	3,00	25,0	10,0	100,0	Metric	EE16	0,280	●	●
108,00	2,00	32,0	10,4	104,0	Metric	EE16	0,246	●	●
108,00	3,00	34,0	10,2	102,0	Metric	EE16	0,370	●	●
108,00	4,00	34,0	10,0	100,0	Metric	EE16	0,492	●	●
114,30	2,00	32,0	11,0	110,3	ISO	EE10	0,246	●	●
114,30	3,00	32,0	10,8	108,3	ISO	EE10	0,369	●	●
114,30	3,00	64,0	17,1	91,4	EN 10254-4	EE30	0,570	●	●
114,30	4,00	32,0	10,6	106,3	ISO	EE10	0,492	●	●
129,00	2,00	34,0	12,5	125,0	Metric	EE15	0,314	●	●
131,00	3,00	35,0	12,5	125,0	Metric	EE16	0,470	○	○
133,00	2,00	34,0	12,9	129,0	Metric	EE16	0,314	○	○
133,00	3,00	34,0	12,7	127,0	Metric	EE16	0,470	○	○
133,00	4,00	34,0	12,5	125,0	Metric	EE16	0,709	●	●
139,70	2,00	35,0	13,6	135,7	ISO	EE10	0,372	●	●
139,70	3,00	36,0	13,4	133,7	ISO	EE10	0,565	●	●
139,70	3,00	76,0	21,0	111,8	EN 10254-4	EE30	1,000	●	●
139,70	4,00	36,0	13,2	131,7	ISO	EE10	0,709	●	●
154,00	2,00	41,0	15,0	150,0	Metric	EE15	0,444	●	●
156,00	3,00	42,0	15,0	150,0	Metric	EE15	0,820	●	●
159,00	2,00	42,0	15,5	155,0	Metric	EE16	0,444	○	○
159,00	3,00	42,0	15,3	153,0	Metric	EE16	0,670	○	○
159,00	4,00	42,0	15,1	151,0	Metric	EE16	1,150	●	●
168,30	2,00	40,0	16,4	164,3	ISO	EE10	0,518	●	●
168,30	3,00	43,0	16,2	162,3	ISO	EE10	0,776	●	●
168,30	3,00	89,0	25,2	134,6	EN 10254-4	EE30	1,130	●	●
168,30	4,00	43,0	16,0	160,3	ISO	EE10	1,150	●	●
204,00	2,00	50,0	20,0	200,0	Metric	EE15	0,754	●	●
206,00	3,00	50,0	20,0	200,0	Metric	EE15	1,130	●	●
219,10	2,00	50,0	21,5	215,1	ISO	EE10	0,849	●	●
219,10	3,00	51,0	21,3	213,1	ISO	EE10	1,274	●	●
219,10	3,00	102,0	32,9	175,3	EN 10254-4	EE30	1,971	●	●
219,10	4,00	51,0	21,1	211,1	ISO	EE10	1,872	●	●
254,00	2,00	55,0	25,0	250,0	Metric	EE15	1,078	●	●
256,00	3,00	55,0	25,0	250,0	Metric	EE15	1,620	●	●

● = voorraad
○ = af fabriek

● = stock
○ = ex works

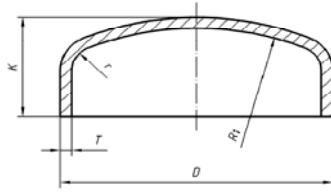

Laskap

End cap

ISO, Metric, EN 10254-4 tp A

EN 10204 3.1



D mm	T mm	K	r	R 1	Type	Art. no.	Kg / pc	4301 4307	4404
273,00	2,00	63,0	26,9	269,0	ISO	EE10	1,310	●	●
273,00	3,00	62,0	26,7	267,0	ISO	EE10	1,966	●	●
273,00	4,00	62,0	26,5	265,0	ISO	EE10	3,621	●	●
304,00	2,00	68,0	30,0	300,0	Metric	EE15	1,646	●	●
306,00	3,00	70,0	30,0	300,0	Metric	EE15	2,470	●	●
323,90	2,00	72,0	32,0	319,9	ISO	EE10	1,814	●	●
323,90	3,00	72,0	31,8	317,9	ISO	EE10	2,720	●	●
323,90	4,00	72,0	31,6	315,9	ISO	EE10	3,627	●	●
355,60	3,00	89,0	35,0	349,6	ISO	EE10	3,516	●	●
355,60	4,00	89,0	34,8	347,6	ISO	EE10	5,315	●	●
406,40	3,00	98,0	40,0	400,4	ISO	EE10	4,523	●	●
406,40	4,00	98,0	39,8	398,4	ISO	EE10	6,534	●	●
457,20	3,00	107,0	45,1	451,2	ISO	EE10	5,494	●	●
457,20	4,00	107,0	44,9	449,2	ISO	EE10	5,494	○	○
508,00	3,00	120,0	50,2	502,0	ISO	EE10	6,558	●	●
508,00	4,00	120,0	50,0	500,0	ISO	EE10	10,289	○	○
609,60	3,00	140,0	60,4	603,6	ISO	EE10	9,232	●	●
609,60	4,00	140,0	60,2	601,6	ISO	EE10	14,130	○	○

● = voorraad
○ = af fabriek

● = stock
○ = ex works

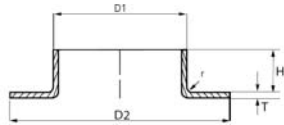

Boordring aansluitmaten DIN 2642

Welding collar connecting dimensions DIN 2642

ISO, Metric

EN 10204 3.1



D1 mm	T mm	D2	H	r	type	Art. no.	Kg / pc	4301 4307	4404
17,20	2,00	42	6,0	3,00	ISO	EC11	0,021	●	●
20,00	2,00	47	6,0	3,00	Metric	EC15	0,020	●	●
21,30	2,00	47	6,0	3,00	ISO	EC11	0,026	●	●
21,30	3,00	47	6,0	3,00	ISO	EC11	0,032	●	●
25,00	2,00	58	7,0	3,00	Metric	EC15	0,034	●	●
26,90	2,00	58	8,0	3,00	ISO	EC11	0,039	●	●
26,90	3,00	58	8,0	3,00	ISO	EC11	0,058	●	●
28,00	2,00	68	8,0	3,00	Metric	EC15	0,048	●	●
30,00	2,00	68	8,0	3,00	Metric	EC15	0,054	●	●
32,00	2,00	68	9,0	3,00	Metric	EC15	0,061	●	●
33,70	2,00	68	9,0	3,00	ISO	EC11	0,051	●	●
33,70	3,00	68	9,0	3,00	ISO	EC11	0,077	●	●
38,00	2,00	78	10,0	3,00	Metric	EC15	0,067	●	●
42,40	2,00	78	10,0	3,00	ISO	EC11	0,101	●	●
42,40	3,00	78	10,0	3,00	ISO	EC11	0,090	●	●
44,50	2,00	90	10,0	3,00	Metric	EC15	0,087	●	●
48,30	2,00	88	10,0	3,00	ISO	EC11	0,082	●	●
48,30	3,00	88	10,0	3,00	ISO	EC11	0,123	●	●
50,80	2,00	102	11,0	3,00	Metric	EC15	0,100	●	●
54,00	2,00	102	12,0	3,00	Metric	EC15	0,114	●	●
56,00	3,00	102	15,0	3,00	Metric	EC15	0,172	●	●
57,00	2,00	102	13,0	3,00	Metric	EC16	0,114	●	●
57,00	3,00	102	13,0	3,00	Metric	EC16	0,172	●	●
60,30	2,00	102	12,0	3,00	ISO	EC11	0,107	●	●
60,30	3,00	102	12,0	3,00	ISO	EC11	0,161	●	●
60,30	4,00	102	12,0	3,00	ISO	EC11	0,215	●	●
63,50	2,00	115	13,0	3,00	Metric	EC15	0,123	●	●
70,00	2,00	122	12,0	2,00	Metric	EC15	0,154	●	●
70,00	3,00	122	12,0	3,00	Metric	EC15	0,231	●	●
71,00	3,00	122	12,0	3,00	Metric	EC15	0,231	●	●
76,10	2,00	122	12,0	3,00	ISO	EC11	0,145	●	●
76,10	3,00	122	12,0	3,00	ISO	EC11	0,217	●	●
76,10	4,00	122	12,0	3,00	ISO	EC11	0,289	●	●
80,00	2,00	122	13,0	3,00	Metric	EC16	0,145	○	○
84,00	2,00	138	13,0	3,00	Metric	EC15	0,186	●	●
86,00	3,00	138	15,0	3,00	Metric	EC15	0,279	●	●
88,90	2,00	133	13,0	3,00	ISO	EC11	0,164	●	●
88,90	3,00	133	13,0	3,00	ISO	EC11	0,277	●	●
88,90	4,00	139	12,0	3,00	ISO	EC11	0,369	●	●
101,60	2,00	150	14,0	3,00	Metric	EC16	0,206	●	●
101,60	3,00	150	14,0	3,00	Metric	EC16	0,309	●	●
104,00	2,00	158	16,0	3,00	Metric	EC15	0,237	●	●
106,00	3,00	158	16,0	3,00	Metric	EC15	0,356	●	●
108,00	2,00	158	14,0	3,00	Metric	EC16	0,216	●	●
108,00	3,00	158	14,0	3,00	Metric	EC16	0,356	●	●
108,00	4,00	158	14,0	4,00	Metric	RC16	0,428	●	●

● = voorraad
○ = af fabriek

● = stock
○ = ex works

Boordring aansluitmaten DIN 2642

Welding collar connecting dimensions DIN 2642

ISO, Metric

EN 10204 3.1

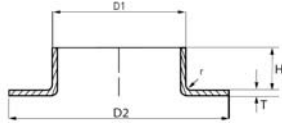

D1 mm	T mm	D2	H	r	type	Art. no.	Kg / pc	4301 4307	4404
114,30	2,00	158	14,0	3,00	ISO	EC11	0,214	●	●
114,30	3,00	158	14,0	4,00	ISO	EC11	0,321	●	●
114,30	4,00	158	14,0	4,00	ISO	EC11	0,428	●	●
129,00	2,00	188	15,0	3,00	Metric	EC15	0,313	●	●
131,00	3,00	188	20,0	4,00	Metric	EC15	0,470	●	●
133,00	2,00	188	19,0	3,00	Metric	EC16	0,313	○	○
133,00	3,00	188	19,0	4,00	Metric	EC16	0,470	○	○
133,00	4,00	188	19,0	4,00	Metric	EC16	0,556	●	●
139,70	2,00	184	15,0	4,00	ISO	EC11	0,259	●	●
139,70	3,00	184	15,0	4,00	ISO	EC11	0,417	●	●
139,70	4,00	184	15,0	4,00	ISO	EC11	0,556	●	●
154,00	2,00	212	19,0	3,00	Metric	EC15	0,378	●	●
156,00	3,00	212	20,0	4,00	Metric	EC15	0,566	●	●
159,00	2,00	212	17,0	3,00	Metric	EC16	0,342	○	○
159,00	3,00	212	18,0	4,00	Metric	EC16	0,513	○	○
159,00	4,00	212	18,0	4,00	Metric	EC16	0,637	●	●
168,30	2,00	212	18,0	4,00	ISO	EC11	0,318	●	●
168,30	3,00	212	48,0	4,00	ISO	EC11	0,477	●	●
168,30	4,00	212	17,0	4,00	ISO	EC11	0,637	●	●
204,00	2,00	268	21,0	4,00	Metric	EC15	0,543	●	●
206,00	3,00	268	25,0	4,00	Metric	EC15	0,815	●	●
219,10	2,00	268	22,0	5,00	ISO	EC11	0,458	●	●
219,10	3,00	268	22,0	5,00	ISO	EC11	0,708	●	●
219,10	4,00	270	18,0	5,00	ISO	EC11	0,973	●	●
254,00	2,00	320	24,0	5,00	Metric	EC15	0,711	●	●
256,00	3,00	320	25,0	5,00	Metric	EC15	1,066	●	●
273,00	2,00	320	23,0	5,00	ISO	EC11	0,532	●	●
273,00	3,00	320	23,0	5,00	ISO	EC11	0,835	●	●
273,00	4,00	320	23,0	5,00	ISO	EC11	1,113	●	●
304,00	2,00	370	19,0	5,00	Metric	EC15	0,804	●	●
306,00	3,00	370	21,0	5,00	Metric	EC15	1,206	●	●
323,90	2,00	370	19,0	5,00	ISO	EC11	0,650	●	●
323,90	3,00	370	19,0	5,00	ISO	EC11	0,962	●	●
323,90	4,00	370	19,0	5,00	ISO	EC11	1,282	●	●
355,60	3,00	430	21,0	5,00	ISO	EC11	1,518	●	●
355,60	4,00	430	21,0	5,00	ISO	EC11	2,024	●	●
406,40	3,00	482	21,0	5,00	ISO	EC11	1,770	●	●
406,40	4,00	482	21,0	5,00	ISO	EC11	2,360	●	●
457,20	3,00	532	25,0	5,00	ISO	EC11	2,087	●	●
457,20	4,00	532	25,0	5,00	ISO	EC11	2,873	○	○
508,00	3,00	587	27,0	5,00	ISO	EC11	2,286	●	●
508,00	4,00	587	27,0	5,00	ISO	EC11	3,048	○	○
609,60	3,00	685	26,0	5,00	ISO	EC11	2,719	●	●
609,60	4,00	685	26,0	5,00	ISO	EC11	3,625	○	○

● = voorraad
○ = af fabriek

● = stock
○ = ex works

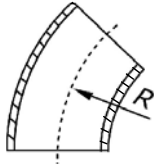

Lasbocht 45° LR

Elbows 45° LR

ASTM-A 403 ASME B16.9

EN 10204 3.1



OD mm	Wall	INCH-GAS-SCH	R	Art. no. Welded / Seamless	Kg / pc	304/L		316/L	
						Welded	Seamless	Welded	Seamless
21,34	2,11	1/2" SCH 10S	38,1	AB30 / AB40	0,055	○	●	○	●
21,34	2,77	1/2" SCH 40S	38,1	AB30 / AB40	0,070	○	●	○	●
21,34	3,73	1/2" SCH 80S	38,1	AB40	0,090		○		○
26,67	2,11	3/4" SCH 10S	28,6	AB30 / AB40	0,035	○	●	○	●
26,67	2,87	3/4" SCH 40S	28,6	AB30 / AB40	0,040	○	●	○	●
26,67	3,91	3/4" SCH 80S	28,6	AB40	0,050		○		○
33,40	2,77	1" SCH 10S	25,4	AB30 / AB40	0,070	○	●	○	●
33,40	3,38	1" SCH 40S	38,1	AB30 / AB40	0,075	○	●	○	●
33,40	4,55	1" SCH 80S	38,1	AB40	0,100		○		○
42,16	2,77	1.1/4" SCH 10S	47,6	AB30 / AB40	0,080	○	●	○	●
42,16	3,56	1.1/4" SCH 40S	47,6	AB30 / AB40	0,130	○	●	○	●
42,16	4,85	1.1/4" SCH 80S	47,6	AB40	0,170		○		○
48,26	2,77	1.1/2" SCH 10S	56,2	AB30 / AB40	0,150	○	●	○	●
48,26	3,68	1.1/2" SCH 40S	56,2	AB30 / AB40	0,200	○	●	○	●
48,26	5,08	1.1/2" SCH 80S	56,2	AB40	0,240		○		○
60,30	2,77	2" SCH 10S	76,2	AB30 / AB40	0,250	○	●	○	●
60,30	3,91	2" SCH 40S	76,2	AB30 / AB40	0,350	○	●	○	●
60,30	5,54	2" SCH 80S	76,2	AB40	0,440		○		○
73,03	3,05	2.1/2" SCH 10S	94,5	AB30 / AB40	0,395	○	●	○	●
73,03	5,16	2.1/2" SCH 40S	94,5	AB30 / AB40	0,645	○	●	○	●
73,03	7,01	2.1/2" SCH 80S	94,5	AB40	0,850		○		○
88,90	3,05	3" SCH 10S	114,2	AB30 / AB40	0,590	○	●	○	●
88,90	5,49	3" SCH 40S	114,2	AB30 / AB40	1,070	○	●	○	●
88,90	7,62	3" SCH 80S	114,2	AB40	1,370		○		○
114,30	3,05	4" SCH 10S	152,4	AB30 / AB40	1,020	○	●	○	●
114,30	6,02	4" SCH 40S	152,4	AB30 / AB40	2,015	○	●	○	●
114,30	8,56	4" SCH 80S	152,4	AB40	2,670		○		○
141,30	3,40	5" SCH 10S	127,0	AB30 / AB40	1,730	○	○	○	○
141,30	6,55	5" SCH 40S	152,4	AB30 / AB40	3,255	○	○	○	○
168,28	3,40	6" SCH 10S	228,6	AB30 / AB40	2,515	●	○	●	○
168,28	7,11	6" SCH 40S	228,6	AB30 / AB40	5,450	●	○	●	○
168,28	10,97	6" SCH 80S	228,6	AB40	7,650		○		○
219,08	3,76	8" SCH 10S	304,8	AB30 / AB40	4,250	●	○	●	○
219,08	8,18	8" SCH 40S	304,8	AB30 / AB40	7,000	●	○	●	○
219,08	12,70	8" SCH 80S	304,8	AB40	10,750		○		○
273,05	4,19	10" SCH 10S	381,0	AB30 / AB40	8,450	●	○	●	○
273,05	9,27	10" SCH 40S	381,0	AB30 / AB40	19,300	●	○	●	○
323,85	4,57	12" SCH 10S	457,0	AB30 / AB40	13,150	●	○	●	○
323,85	9,53	12" SCH 40S	457,0	AB30 / AB40	29,200	●	○	●	○
355,60	4,78	14" SCH 10S	533,5	AB31 / AB40	17,550	●	○	●	○
355,60	9,53	14" SCH 40S	533,5	AB31 / AB40	35,150	●	○	●	○
406,40	4,78	16" SCH 10S	609,5	AB31 / AB40	23,000	●	○	●	○
406,40	9,53	16" SCH 40S	609,5	AB31 / AB40	45,800	●	○	●	○
457,20	4,78	18" SCH 10S	686,0	AB31	28,650	○		○	
457,20	9,53	18" SCH 40S	686,0	AB31	56,500	○		○	
508,00	5,54	20" SCH 10S	762,0	AB31	41,000	○		○	
508,00	9,52	20" SCH 40S	762,0	AB31	70,000	○		○	
609,60	6,35	24" SCH 10S	914,4	AB31	69,000	○		○	
609,60	9,52	24" SCH 40S	914,4	AB31	103,900	○		○	

● = voorraad
○ = af fabriek

● = stock
○ = ex works

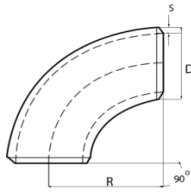

Lasbocht 90° LR

Elbows 90° LR

ASTM-A 403 ASME B16.9

EN 10204 3.1



D mm	S mm	INCH-GAS-SCH	R	Art. no.	Kg / pc	304/L		316/L	
						Welded	Seamless	Welded	Seamless
21,34	2,11	1/2" SCH 10S	38,1	AB35 / AB45	0,11	●	●	●	●
21,34	2,77	1/2" SCH 40S	38,1	AB35 / AB45	0,14	●	●	●	●
21,34	3,73	1/2" SCH 80S	38,1	AB45	0,18		●		●
26,67	2,11	3/4" SCH 10S	38,1	AB35 / AB45	0,07	●	●	●	●
26,67	2,87	3/4" SCH 40S	38,1	AB35 / AB45	0,08	●	●	●	●
26,67	3,91	3/4" SCH 80S	38,1	AB45	0,10		●		●
33,40	2,77	1" SCH 10S	38,1	AB35 / AB45	0,14	●	●	●	●
33,40	3,38	1" SCH 40S	38,1	AB35 / AB45	0,15	○	●	○	●
33,40	4,55	1" SCH 80S	38,1	AB45	0,19		●		●
42,16	2,77	1.1/4" SCH 10S	47,6	AB35 / AB45	0,23	●	●	●	●
42,16	3,56	1.1/4" SCH 40S	47,6	AB35 / AB45	0,26	●	●	●	●
42,16	4,85	1.1/4" SCH 80S	47,6	AB45	0,35		●		●
48,26	2,77	1.1/2" SCH 10S	57,2	AB35 / AB45	0,30	●	●	●	●
48,26	3,68	1.1/2" SCH 40S	57,2	AB35 / AB45	0,40	●	●	●	●
48,26	5,08	1.1/2" SCH 80S	57,2	AB45	0,49		●		●
60,33	2,77	2" SCH 10S	76,2	AB35 / AB45	0,50	●	●	●	●
60,33	3,91	2" SCH 40S	76,2	AB35 / AB45	0,70	●	●	●	●
60,33	5,54	2" SCH 80S	76,2	AB45	0,89		●		●
73,03	3,05	2.1/2" SCH 10S	95,0	AB35 / AB45	0,79	●	●	●	●
73,03	5,16	2.1/2" SCH 40S	95,0	AB35 / AB45	1,29	●	●	●	●
73,03	7,01	2.1/2" SCH 80S	95,0	AB45	1,70		○		●
88,90	3,05	3" SCH 10S	114,3	AB35 / AB45	1,18	●	●	●	●
88,90	5,49	3" SCH 40S	114,3	AB35 / AB45	2,14	●	●	●	●
88,90	7,62	3" SCH 80S	114,3	AB45	2,74		●		●
114,30	3,05	4" SCH 10S	152,4	AB35 / AB45	2,03	●	●	●	●
114,30	6,02	4" SCH 40S	152,4	AB35 / AB45	4,03	●	●	●	●
114,30	8,56	4" SCH 80S	152,4	AB45	5,34		●		●
141,30	3,40	5" SCH 10S	190,5	AB35 / AB45	3,46	●	●	●	●
141,30	6,55	5" SCH 40S	190,5	AB35 / AB45	6,51	●	○	●	○
141,30	9,53	5" SCH 80S	190,5	AB45	9,25		○		○
168,28	3,40	6" SCH 10S	228,6	AB35 / AB45	5,03	●	●	●	●
168,28	7,11	6" SCH 40S	228,6	AB35 / AB45	10,90	●	●	●	●
168,28	10,97	6" SCH 80S	228,6	AB45	15,30		●		●
219,08	3,76	8" SCH 10S	304,8	AB35 / AB45	9,73	●	●	●	●
219,08	8,18	8" SCH 40S	304,8	AB35 / AB45	21,50	●	●	●	●
219,08	12,70	8" SCH 80S	304,8	AB45	30,90		●		●
273,05	4,19	10" SCH 10S	381,0	AB35 / AB45	16,90	●	○	●	○
273,05	9,27	10" SCH 40S	381,0	AB35 / AB45	38,60	●	○	●	○
323,85	4,57	12" SCH 10S	457,0	AB35 / AB45	26,30	●	○	●	○
323,85	9,53	12" SCH 40S	457,0	AB35 / AB45	59,40	●	○	●	○
355,60	4,78	14" SCH 10S	533,5	AB36 / AB45	35,10	●	○	●	○
355,60	9,53	14" SCH 40S	533,5	AB36 / AB45	70,30	●	○	●	○
406,40	4,78	16" SCH 10S	609,5	AB36 / AB45	46,00	●	○	●	○
406,40	9,53	16" SCH 40S	609,5	AB36 / AB45	91,60	●	○	●	○
457,20	4,78	18" SCH 10S	686,0	AB36	57,30	○		○	
457,20	9,53	18" SCH 40S	686,0	AB36	113,00	○		○	
508,00	5,54	20" SCH 10S	762,0	AB36	82,00	○		○	
508,00	9,52	20" SCH 40S	762,0	AB36	140,00	○		○	
609,60	6,35	24" SCH 10S	914,4	AB36	138,00	○		○	
609,60	9,52	24" SCH 40S	914,4	AB36	207,80	○		○	

● = voorraad
○ = af fabriek

● = stock
○ = ex works

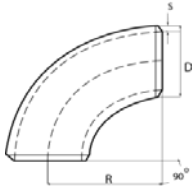

Lasbocht 90° SR

Elbows 90° SR

ASTM-A 403 ASME B16.9

EN 10204 3.1



D mm	S mm	INCH-GAS-SCH	R	Art. no. Welded / Seamless	Kg / pc	304/L		316/L	
						Welded	Seamless	Welded	Seamless
33,40	2,77	1" SCH 10S	25,4	AB15 / AB25	0,11	○	●	○	●
33,40	3,38	1" SCH 40S	25,4	AB15 / AB25	0,13	○	●	○	●
42,16	2,77	1.1/4" SCH 10S	31,8	AB15 / AB25	0,16	○	●	○	●
42,16	3,56	1.1/4" SCH 40S	31,8	AB15 / AB25	0,21	○	●	○	●
48,26	2,77	1.1/2" SCH 10S	38,1	AB15 / AB25	0,22	○	●	○	●
48,26	3,68	1.1/2" SCH 40S	38,1	AB15 / AB25	0,28	○	●	○	●
60,33	2,77	2" SCH 10S	50,8	AB15 / AB25	0,48	○	●	○	●
60,33	3,91	2" SCH 40S	50,8	AB15 / AB25	0,36	○	●	○	●
73,03	3,05	2.1/2" SCH 10S	63,5	AB15 / AB25	0,52	○	●	○	●
73,03	5,16	2.1/2" SCH 40S	63,5	AB15 / AB25	0,92	○	●	○	●
88,90	3,05	3" SCH 10S	101,6	AB15 / AB25	0,84	○	●	○	●
88,90	5,49	3" SCH 40S	101,6	AB15 / AB25	1,49	○	●	○	●
114,30	3,05	4" SCH 10S	101,6	AB15 / AB25	1,38	○	●	○	●
114,30	6,02	4" SCH 40S	101,6	AB15 / AB25	2,65	○	●	○	●
141,30	3,40	5" SCH 10S	127,0	AB15 / AB25	2,37	○	○	○	○
141,30	6,55	5" SCH 40S	127,0	AB15 / AB25	4,32	○	○	○	○
168,28	3,40	6" SCH 10S	152,4	AB15 / AB25	3,36	●	○	●	○
168,28	7,11	6" SCH 40S	152,4	AB15 / AB25	6,87	●	○	●	○
219,08	3,76	8" SCH 10S	203,2	AB15 / AB25	6,57	●	○	●	○
219,08	8,18	8" SCH 40S	203,2	AB15 / AB25	14,00	●	○	●	○
273,05	4,19	10" SCH 10S	254,0	AB15 / AB25	11,50	●	○	●	○
273,05	9,27	10" SCH 40S	254,0	AB15 / AB25	26,25	●	○	●	○
323,85	4,57	12" SCH 10S	304,8	AB15 / AB25	17,90	●	○	●	○
323,85	9,53	12" SCH 40S	304,8	AB15 / AB25	40,40	●	○	●	○
355,60	4,78	14" SCH 10S	355,6	AB16 / AB25	26,60	●	○	●	○
355,60	9,53	14" SCH 40S	355,6	AB16 / AB25	59,20	●	○	●	○
406,40	4,78	16" SCH 10S	406,4	AB16 / AB25	38,40	●	○	●	○
406,40	9,53	16" SCH 40S	406,4	AB16 / AB25	77,60	●	○	●	○

● = voorraad
○ = af fabriek

● = stock
○ = ex works

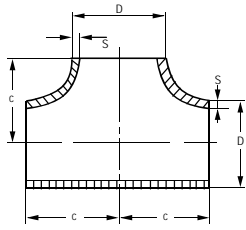

Gelijkbenige T-stuk

Equal tee

ASTM-A 403 ASME B16.9

EN 10204 3.1



D mm	S mm	INCH-GAS-SCH	c	Art. no. Welded / Seamless	Kg / pc	304/L		316/L	
						Welded	Seamless	Welded	Seamless
21,34	2,11	1/2" SCH 10S	25,0	AT10/AT20	0,07	●	●	●	●
21,34	2,77	1/2" SCH 40S	25,0	AT10/AT20	0,08	●	●	●	●
21,34	3,73	1/2" SCH 80S	25,0	AT20	0,11		●		●
26,67	2,11	3/4" SCH 10S	29,0	AT10/AT20	0,09	●	●	●	●
26,67	2,87	3/4" SCH 40S	29,0	AT10/AT20	0,11	●	●	●	●
26,67	3,91	3/4" SCH 80S	29,0	AT20	0,16		●		●
33,40	2,77	1" SCH 10S	38,0	AT10/AT20	0,20	●	●	●	●
33,40	3,38	1" SCH 40S	38,0	AT10/AT20	0,24	●	●	●	●
33,40	4,55	1" SCH 80S	38,0	AT20	0,32		●		●
42,16	2,77	1.1/4" SCH 10S	48,0	AT10/AT20	0,33	●	●	●	●
42,16	3,56	1.1/4" SCH 40S	48,0	AT10/AT20	0,41	●	●	●	●
42,16	4,85	1.1/4" SCH 80S	48,0	AT20	0,54		●		●
48,26	2,77	1.1/2" SCH 10S	57,0	AT10/AT20	0,46	●	●	●	●
48,26	3,68	1.1/2" SCH 40S	57,0	AT10/AT20	0,60	●	●	●	●
48,26	5,08	1.1/2" SCH 80S	57,0	AT20	0,80		●		●
60,33	2,77	2" SCH 10S	64,0	AT10/AT20	0,63	●	●	●	●
60,33	3,91	2" SCH 40S	64,0	AT10/AT20	0,87	●	●	●	●
60,33	5,54	2" SCH 80S	64,0	AT20	1,20		●		●
73,03	3,05	2.1/2" SCH 10S	76,0	AT10/AT20	1,01	●	●	●	●
73,03	5,16	2.1/2" SCH 40S	76,0	AT10/AT20	1,66	●	●	●	●
73,03	7,01	2.1/2" SCH 80S	76,0	AT20	2,19		○		●
88,90	3,05	3" SCH 10S	86,0	AT10/AT20	1,37	●	●	●	●
88,90	5,49	3" SCH 40S	86,0	AT10/AT20	1,90	●	●	●	●
88,90	7,62	3" SCH 80S	86,0	AT20	3,25		●		●
114,30	3,05	4" SCH 10s	114,0	AT10/AT20	2,15	●	●	●	●
114,30	6,02	4" SCH 40S	114,0	AT10/AT20	4,13	●	●	●	●
114,30	8,56	4" SCH 80S	114,0	AT20	5,74		●		●
141,30	3,40	5" SCH 10S	141,0	AT10/AT20	3,48	●	●	●	●
141,30	6,55	5" SCH 40S	141,0	AT10/AT20	6,55	●	●	●	●
168,28	3,40	6" SCH 10S	168,0	AT10/AT20	4,76	●	●	●	●
168,28	7,11	6" SCH 40S	168,0	AT10/AT20	9,73	●	●	●	●
168,28	10,97	6" SCH 80S	168,0	AT20	12,80		●		●
219,08	3,76	8" SCH 10S	219,0	AT10/AT20	8,46	●	●	●	●
219,08	8,18	8" SCH 40S	219,0	AT10/AT20	18,00	●	●	●	●
219,08	12,70	8" SCH 80S	219,0	AT20	27,40		●		●
273,05	4,19	10" SCH 10S	216,0	AT10/AT20	14,20	●	○	●	○
273,05	9,27	10" SCH 40S	216,0	AT10/AT20	30,60	●	○	●	○
323,85	4,57	12" SCH 10S	254,0	AT10/AT20	21,60	●	○	●	○
323,85	9,53	12" SCH 40S	254,0	AT10/AT20	44,30	●	○	●	○
355,60	4,78	14" SCH 10S	279,0	AT11/AT20	27,30	●	○	●	○
355,60	9,53	14" SCH 40S	279,0	AT11/AT20	53,70	●	○	●	○
406,40	4,77	16" SCH 10S	305,0	AT11/AT20	58,90	●	○	●	○
406,40	9,53	16" SCH 40S	305,0	AT11/AT20	99,70	●	○	●	○
508,00	5,53	20" SCH 10S	381,0	AT11	103,30	○		○	
508,00	9,53	20" SCH 40S	381,0	AT11	162,20	○		○	
609,60	6,35	24" SCH 10S	431,8	AT11	155,40	○		○	
609,60	9,53	24" SCH 40S	431,8	AT11	226,00	○		○	

● = voorraad

● = stock

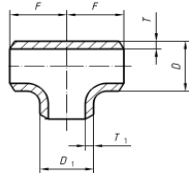

Verloop T-stuk

Reducing tee

ASTM-A 403 ASME B 16.9

EN 10204 3.1



D mm	D1 mm	T mm	T1 mm	INCH-GAS-SCH	F	Art. no. Welded / Seamless	Kg / pc	304/L		316/L	
								Welded	Seamless	Welded	Seamless
26,67	21,34	2,11	2,11	3/4" x 1/2" SCH 10S	14,30	AT15/AT25	0,08	●	●	○	●
26,67	21,34	2,87	2,77	3/4" x 1/2" SCH 40S	14,30	AT15/AT25	0,12	○	●	○	●
26,67	21,34	3,91	3,73	3/4" x 1/2" SCH 80S	14,30	AT25	0,15		●		●
33,40	21,34	2,77	2,11	1" x 1/2" SCH 10S	19,05	AT15/AT25	0,19	○	●	○	●
33,40	21,34	3,38	2,77	1" x 1/2" SCH 40S	19,05	AT15/AT25	0,22	○	●	○	●
33,40	21,34	4,55	3,73	1" x 1/2" SCH 80S	19,05	AT25	0,28		●		●
33,40	26,67	2,77	2,11	1" x 3/4" SCH 10S	19,05	AT15/AT25	0,19	○	●	○	●
33,40	26,67	3,38	2,87	1" x 3/4" SCH 40S	19,05	AT15/AT25	0,23	○	●	○	●
33,40	26,67	4,55	3,91	1" x 3/4" SCH 80S	19,05	AT25	0,29		●		●
42,16	21,34	2,77	2,11	1.1/4" x 1/2" SCH 10S	23,80	AT15/AT25	0,29	○	●	○	●
42,16	21,34	3,56	2,77	1.1/4" x 1/2" SCH 40S	23,80	AT15/AT25	0,37	○	●	○	●
42,16	21,34	4,85	3,73	1.1/4" x 1/2" SCH 80S	23,80	AT25	0,48		●		●
42,16	26,67	2,77	2,11	1.1/4" x 3/4" SCH 10S	23,80	AT15/AT25	0,29	○	●	○	●
42,16	26,67	3,56	2,87	1.1/4" x 3/4" SCH 40S	23,80	AT15/AT25	0,37	○	●	○	●
42,16	26,67	4,85	3,91	1.1/4" x 3/4" SCH 80S	23,80	AT25	0,48		●		●
42,16	33,40	2,77	2,77	1.1/4" x 1" SCH 10S	23,80	AT15/AT25	0,31	○	●	○	●
42,16	33,40	3,56	3,38	1.1/4" x 1" SCH 40S	23,80	AT15/AT25	0,39	○	●	○	●
42,16	33,40	4,85	4,55	1.1/4" x 1" SCH 80S	23,80	AT25	0,51		●		●
48,26	21,34	2,77	2,11	1.1/2" x 1/2" SCH 10S	28,55	AT15/AT25	0,39	○	●	○	●
48,26	21,34	3,68	2,77	1.1/2" x 1/2" SCH 40S	28,55	AT15/AT25	0,51	○	●	○	●
48,26	21,34	5,08	3,73	1.1/2" x 1/2" SCH 80S	28,55	AT25	0,67		●		●
48,26	26,67	2,77	2,11	1.1/2" x 3/4" SCH 10S	28,55	AT15/AT25	0,40	○	●	○	●
48,26	26,67	3,68	2,87	1.1/2" x 3/4" SCH 40S	28,55	AT15/AT25	0,52	○	●	○	●
48,26	26,67	5,08	3,91	1.1/2" x 3/4" SCH 80S	28,55	AT25	0,69		●		●
48,26	33,40	2,77	2,77	1.1/2" x 1" SCH 10S	28,55	AT15/AT25	0,42	○	●	○	●
48,26	33,40	3,68	3,38	1.1/2" x 1" SCH 40S	28,55	AT15/AT25	0,55	○	●	○	●
48,26	33,40	5,08	4,55	1.1/2" x 1" SCH 80S	28,55	AT25	0,73		●		●
48,26	42,16	2,77	2,77	1.1/2" x 1.1/4" SCH 10S	28,55	AT15/AT25	0,44	○	●	○	●
48,26	42,16	3,68	3,56	1.1/2" x 1.1/4" SCH 40S	28,55	AT15/AT25	0,57	○	●	○	●
48,26	42,16	5,08	4,85	1.1/2" x 1.1/4" SCH 80S	28,55	AT25	0,77		●		●
60,33	21,34	2,77	2,11	2" x 1/2" SCH 10S	31,75	AT15/AT25	0,54	○	●	○	●
60,33	21,34	3,91	2,77	2" x 1/2" SCH 40S	31,75	AT15/AT25	0,74	○	●	○	●
60,33	21,34	5,54	3,73	2" x 1/2" SCH 80S	31,75	AT25	1,02		●		●
60,33	26,67	2,77	2,11	2" x 3/4" SCH 10S	31,75	AT15/AT25	0,54	○	●	○	●
60,33	26,67	3,91	2,87	2" x 3/4" SCH 40S	31,75	AT15/AT25	0,74	○	●	○	●
60,33	26,67	5,54	3,91	2" x 3/4" SCH 80S	31,75	AT25	1,02		●		●
60,33	33,40	2,77	2,77	2" x 1" SCH 10S	31,75	AT15/AT25	0,54	○	●	○	●
60,33	33,40	3,91	3,38	2" x 1" SCH 40S	31,75	AT15/AT25	0,74	○	●	○	●
60,33	33,40	5,54	4,55	2" x 1" SCH 80S	31,75	AT25	1,02		●		●
60,33	42,16	2,77	2,77	2" x 1.1/4" SCH 10S	31,75	AT15/AT25	0,57	○	●	○	●
60,33	42,16	3,91	3,56	2" x 1.1/4" SCH 40S	31,75	AT15/AT25	0,80	○	●	○	●
60,33	42,16	5,54	4,85	2" x 1.1/4" SCH 80S	31,75	AT25	1,07		●		●
60,33	48,26	2,77	2,77	2" x 1.1/2" SCH 10S	31,75	AT15/AT25	0,59	○	●	○	●
60,33	48,26	3,91	3,68	2" x 1.1/2" SCH 40S	31,75	AT15/AT25	0,83	○	●	○	●
60,33	48,26	5,54	5,08	2" x 1.1/2" SCH 80S	31,75	AT25	1,11		●		●

● = voorraad
○ = af fabriek

● = stock
○ = ex works

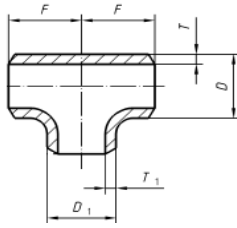

Verloop T-stuk

Reducing tee

ASTM-A 403 ASME B 16.9

EN 10204 3.1



D mm	D1 mm	T mm	T1 mm	INCH-GAS-SCH	F	Art. no. Welded/Seamless	Kg / pc	304/L		316/L	
								Welded	Seamless	Welded	Seamless
73,03	60,33	3,05	2,77	2.1/2" x 2" SCH 10S	38,10	AT15/AT25	0,94	○	●	○	●
73,03	60,33	5,16	3,93	2.1/2" x 2" SCH 40S	38,10	AT15/AT25	1,53	○	●	○	●
88,90	33,40	3,05	2,77	3" x 1" SCH 10S	42,85	AT15/AT25	1,08	○	○	○	●
88,90	33,40	5,49	3,38	3" x 1" SCH 40S	42,85	AT15/AT25	1,94	○	○	○	●
88,90	48,26	3,05	2,77	3" x 1.1/2" SCH 10S	42,85	AT15/AT25	1,19	○	○	○	●
88,90	48,26	5,49	3,68	3" x 1.1/2" SCH 40S	42,85	AT15/AT25	2,05	○	○	○	●
88,90	48,26	7,62	5,08	3" x 1.1/2" SCH 80S	42,85	AT25	2,77		○		○
88,90	60,33	3,05	2,77	3" x 2" SCH 10S	42,85	AT15/AT25	1,23	○	●	○	●
88,90	60,33	5,49	3,91	3" x 2" SCH 40S	42,85	AT15/AT25	2,16	○	●	○	●
88,90	60,33	7,62	5,54	3" x 2" SCH 80S	42,85	AT25	2,85		○		○
88,90	73,03	3,05	3,05	3" x 2.1/2" SCH 10S	42,85	AT15/AT25	1,31	○	●	○	●
88,90	73,03	5,49	5,16	3" x 2.1/2" SCH 40S	42,85	AT15/AT25	2,29	○	●	○	●
114,30	60,33	3,05	2,77	4" x 2" SCH 10S	52,40	AT15/AT25	1,88	○	●	○	●
114,30	60,33	6,02	3,91	4" x 2" SCH 40S	52,40	AT15/AT25	3,52	○	●	○	●
114,30	60,33	8,56	5,54	4" x 2" SCH 80S	52,40	AT25	4,91		○		○
114,30	73,03	3,05	3,05	4" x 2.1/2" SCH 10S	52,40	AT15/AT25	1,95	○	○	○	○
114,30	73,03	6,02	5,16	4" x 2.1/2" SCH 40S	52,40	AT15/AT25	3,70	○	○	○	○
114,30	88,90	3,05	3,05	4" x 3" SCH 10S	52,40	AT15/AT25	3,02	○	●	○	●
114,30	88,90	6,02	5,49	4" x 3" SCH 40S	52,40	AT15/AT25	3,83	○	●	○	●
114,30	88,90	8,56	7,62	4" x 3" SCH 80S	52,40	AT25	5,31		○		○
168,28	88,90	3,40	3,05	6" x 3" SCH 10S	71,45	AT15/AT25	4,21	○	○	○	○
168,28	88,90	7,11	5,49	6" x 3" SCH 40S	71,45	AT15/AT25	8,52	○	○	○	○
168,28	114,30	3,40	3,05	6" x 4" SCH 10S	71,45	AT15/AT25	4,34	○	○	○	○
168,28	114,30	7,11	6,02	6" x 4" SCH 40S	71,45	AT15/AT25	8,81	○	○	○	○
219,08	114,30	3,40	3,05	8" x 4" SCH 10S	88,90	AT15/AT25	7,48	○	○	○	○
219,08	114,30	8,18	6,02	8" x 4" SCH 40S	88,90	AT15/AT25	15,90	○	○	○	○
219,08	168,28	3,76	3,40	8" x 6" SCH 10S	88,90	AT15/AT25	7,91	○	○	○	○
219,08	168,28	8,18	7,11	8" x 6" SCH 40S	88,90	AT15/AT25	16,80	○	○	○	○

● = voorraad
○ = af fabriek

● = stock
○ = ex works

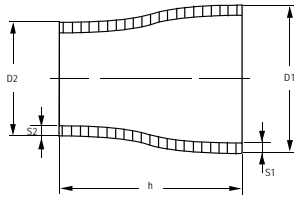

Lasverloop (concentrisch)

Reducers (concentric)

ASTM-A 403 ASME B16.9

EN 10204 3.1



D 1 mm	D 2 mm	S 1 mm	S 2 mm	INCH-GAS-SCH	Art. no. Welded / Seamless	h	Kg/pc	304/L		316/L	
								Welded	Seamless	Welded	Seamless
26,67	21,33	2,11	2,11	3/4" x 1/2" SCH 10S	AR10/AR20	38,1	0,04	●	●	●	●
26,67	21,33	2,87	2,77	3/4" x 1/2" SCH 40S	AR10/AR20	38,1	0,06	●	●	●	●
26,67	21,33	3,91	3,73	3/4" x 1/2" SCH 80S	AR20	38,1	0,08		●		●
33,40	21,33	2,77	2,11	1" x 1/2" SCH 10S	AR10/AR20	50,8	0,09	●	●	●	●
33,40	21,33	3,38	2,77	1" x 1/2" SCH 40S	AR10/AR20	50,8	0,11	●	●	●	●
33,40	21,33	4,55	3,73	1" x 1/2" SCH 80S	AR20	50,8	0,13		●		●
33,40	26,67	2,77	2,11	1" x 3/4" SCH 10S	AR10/AR20	50,8	0,10	●	●	●	●
33,40	26,67	3,38	2,87	1" x 3/4" SCH 40S	AR10/AR20	50,8	0,12	●	●	●	●
33,40	26,67	4,55	3,91	1" x 3/4" SCH 80S	AR20	50,8	0,15		●		●
42,16	21,34	2,77	2,11	1.1/4" x 1/2" SCH 10S	AR10/AR20	50,8	0,10	○	○	○	●
42,16	21,34	3,56	2,77	1.1/4" x 1/2" SCH 40S	AR10/AR20	50,8	0,13	○	○	○	●
42,16	21,34	4,85	3,73	1.1/4" x 1/2" SCH 80S	AR20	50,8	0,17		○		●
42,16	26,67	2,77	2,11	1.1/4" x 3/4" SCH 10S	AR10/AR20	50,8	0,11	○	○	○	●
42,16	26,67	3,56	2,87	1.1/4" x 3/4" SCH 40S	AR10/AR20	50,8	0,14	○	○	○	●
42,16	26,67	4,85	3,91	1.1/4" x 3/4" SCH 80S	AR20	50,8	0,19		○		●
42,16	33,40	2,77	2,77	1.1/4" x 1" SCH 10S	AR10/AR20	50,8	0,12	●	●	●	●
42,16	33,40	3,56	3,38	1.1/4" x 1" SCH 40S	AR10/AR20	50,8	0,16	●	●	●	●
42,16	33,40	4,85	4,55	1.1/4" x 1" SCH 80S	AR20	50,8	0,21		●		●
48,26	21,34	2,77	2,11	1.1/2" x 1/2" SCH 10S	AR10/AR20	63,5		○	○	○	●
48,26	21,34	3,68	2,77	1.1/2" x 1/2" SCH 40S	AR10/AR20	63,5	0,183	○	○	○	●
48,26	21,34	5,08	3,73	1.1/2" x 1/2" SCH 80S	AR20	63,5	0,242		○		●
48,26	26,67	2,77	2,11	1.1/2" x 3/4" SCH 10S	AR10/AR20	63,5	0,153	○	○	○	●
48,26	26,67	3,68	2,87	1.1/2" x 3/4" SCH 40S	AR10/AR20	63,5	0,201	○	○	○	●
48,26	26,67	5,08	3,91	1.1/2" x 3/4" SCH 80S	AR20	63,5	0,266		●		●
48,26	33,40	2,77	2,77	1.1/2" x 1" SCH 10S	AR10/AR20	63,5	0,166	●	●	●	●
48,26	33,40	3,68	3,38	1.1/2" x 1" SCH 40S	AR10/AR20	63,5	0,219	●	●	●	●
48,26	33,40	5,08	4,55	1.1/2" x 1" SCH 80S	AR20	63,5	0,291		●		●
48,26	42,16	2,77	2,77	1.1/2" x 1.1/4" SCH 10S	AR10/AR20	63,5	0,184	●	●	●	●
48,26	42,16	3,68	3,56	1.1/2" x 1.1/4" SCH 40S	AR10/AR20	63,5	0,243		●		●
48,26	42,16	5,08	4,85	1.1/2" x 1.1/4" SCH 80S	AR20	63,5	0,324	●	●	●	●
60,33	21,34	2,77	2,11	2" x 1/2" SCH 10S	AR10/AR20	76,1	0,225	○	○	○	●
60,33	21,34	3,91	2,77	2" x 1/2" SCH 40S	AR10/AR20	76,1	0,279	○	○	○	●
60,33	21,34	5,54	3,73	2" x 1/2" SCH 80S	AR20	76,1	0,379		○		●
60,33	26,67	2,77	2,11	2" x 3/4" SCH 10S	AR10/AR20	76,1	0,217	○	○	○	●
60,33	26,67	3,91	2,87	2" x 3/4" SCH 40S	AR10/AR20	76,1	0,300	○	○	○	●
60,33	26,67	5,54	3,91	2" x 3/4" SCH 80S	AR20	76,1	0,406		○		●
60,33	33,40	2,77	2,77	2" x 1" SCH 10S	AR10/AR20	76,1	0,233	●	●	●	●
60,33	33,40	3,91	3,38	2" x 1" SCH 40S	AR10/AR20	76,1	0,322	●	●	●	●
60,33	33,40	5,54	4,55	2" x 1" SCH 80S	AR20	76,1	0,438		●		●
60,33	42,16	2,77	2,77	2" x 1.1/4" SCH 10S	AR10/AR20	76,1	0,254	●	●	●	●
60,33	42,16	3,91	3,56	2" x 1.1/4" SCH 40S	AR10/AR20	76,1	0,352	●	●	●	●
60,33	42,16	5,54	4,85	2" x 1.1/4" SCH 80S	AR20	76,1	0,478		●		●
60,33	48,26	2,77	2,77	2" x 1.1/2" SCH 10S	AR10/AR20	76,1	0,269	●	●	●	●
60,33	48,26	3,91	3,68	2" x 1.1/2" SCH 40S	AR10/AR20	76,1	0,372	●	●	●	●
60,33	48,26	5,54	5,08	2" x 1.1/2" SCH 80S	AR20	76,1	0,508		●		●

● = voorraad
○ = af fabriek

● = stock
○ = ex works

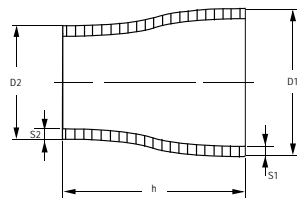

Lasverloop (concentrisch)

Reducers (concentric)

ASTM-A 403 ASME B16.9

EN 10204 3.1



D 1 mm	D 2 mm	S 1 mm	S 2 mm	INCH-GAS-SCH	Art. no. Welded / Seamless	h	Kg/pc	304/L		316/L	
								Welded	Seamless	Welded	Seamless
73,03	48,26	3,05	2,77	2.1/2" x 1.1/2" SCH 10S	AR10/AR20	88,9	0,39	○	○	○	●
73,03	48,26	5,16	3,68	2.1/2" x 1.1/2" SCH 40S	AR10/AR20	88,9	0,66	○	○	○	●
73,03	48,26	7,01	5,08	2.1/2" x 1.1/2" SCH 80S	AR20	88,9	0,83		○		●
73,03	60,33	3,05	2,77	2.1/2" x 2" SCH 10S	AR10/AR20	88,9	0,43	●	●	●	●
73,03	60,33	5,16	3,91	2.1/2" x 2" SCH 40S	AR10/AR20	88,9	0,72	●	●	●	●
73,03	60,33	7,01	5,54	2.1/2" x 2" SCH 80S	AR20	88,9	0,92		●		●
88,90	33,40	3,05	2,77	3" x 1" SCH 10S	AR10/AR20	88,9	0,43	○	●	○	●
88,90	33,40	5,49	3,38	3" x 1" SCH 40S	AR10/AR20	88,9	0,74	○	●	○	●
88,90	33,40	7,62	4,55	3" x 1" SCH 80S	AR20	88,9	0,83		●		●
88,90	42,16	3,05	2,77	3" x 1.1/4" SCH 10S	AR10/AR20	88,9	0,43	○	○	○	●
88,90	42,16	5,49	3,56	3" x 1.1/4" SCH 40S	AR10/AR20	88,9	0,75	○	○	○	●
88,90	42,16	7,62	4,85	3" x 1.1/4" SCH 80S	AR20	88,9	0,96		○		●
88,90	48,26	3,05	2,77	3" x 1.1/2" SCH 10S	AR10/AR20	88,9	0,45	●	●	●	●
88,90	48,26	5,49	3,68	3" x 1.1/2" SCH 40S	AR10/AR20	88,9	0,78	●	●	●	●
88,90	48,26	7,62	5,08	3" x 1.1/2" SCH 80S	AR20	88,9	1,04		●		●
88,90	60,33	3,05	2,77	3" x 2" SCH 10S	AR10/AR20	88,9	0,48	●	●	●	●
88,90	60,33	5,49	3,91	3" x 2" SCH 40S	AR10/AR20	88,9	0,85	●	●	●	●
88,90	60,33	7,62	5,54	3" x 2" SCH 80S	AR20	88,9	1,13		●		●
88,90	73,03	3,05	3,05	3" x 2.1/2" SCH 10S	AR10/AR20	88,9	0,48	●	●	●	●
88,90	73,03	5,49	5,16	3" x 2.1/2" SCH 40S	AR10/AR20	88,9	0,933	●	●	●	●
88,90	73,03	7,62	7,01	3" x 2.1/2" SCH 80S	AR20	88,9	1,230		●		●
114,30	48,26	3,05	2,77	4" x 1.1/2" SCH 10S	AR10/AR20	101,6	0,629	○	●	○	●
114,30	48,26	6,02	3,68	4" x 1.1/2" SCH 40S	AR10/AR20	101,6	1,180	○	●	○	●
114,30	48,26	8,56	5,08	4" x 1.1/2" SCH 80S	AR20	101,6	1,640		●		●
114,30	60,33	3,05	2,77	4" x 2" SCH 10S	AR10/AR20	101,6	0,665	●	●	●	●
114,30	60,33	6,02	3,91	4" x 2" SCH 40S	AR10/AR20	101,6	1,270	●	●	●	●
114,30	60,33	8,56	5,54	4" x 2" SCH 80S	AR20	101,6	1,760		●		●
114,30	73,03	3,05	3,05	4" x 2.1/2" SCH 10S	AR10/AR20	101,6	0,706	●	●	●	●
114,30	73,03	6,02	5,16	4" x 2.1/2" SCH 40S	AR10/AR20	101,6	1,370	●	●	●	●
114,30	73,03	8,56	7,01	4" x 2.1/2" SCH 80S	AR20	101,6	1,860		●		●
114,30	88,90	3,05	3,05	4" x 3" SCH 10S	AR10/AR20	101,6	0,758	●	●	●	●
114,30	88,90	6,02	5,49	4" x 3" SCH 40S	AR10/AR20	101,6	1,450	●	●	●	●
114,30	88,90	8,56	7,62	4" x 3" SCH 80S	AR20	101,6	2,020		●		●
141,30	88,90	3,40	3,05	5" x 3" SCH 10S	AR10/AR20	127,0	1,220	○	○	○	●
141,30	88,90	6,55	5,49	5" x 3" SCH 40S	AR10/AR20	127,0	2,270	○	○	○	●
141,30	114,30	3,40	3,05	5" x 4" SCH 10S	AR10/AR20	127,0	1,330	●	●	●	●
141,30	114,30	6,55	6,02	5" x 4" SCH 40S	AR10/AR20	127,0	2,500	●	●	●	●
168,28	88,90	3,40	3,05	6" x 3" SCH 10S	AR10/AR20	140,0	1,650	●	●	●	●
168,28	88,90	8,18	5,49	6" x 3" SCH 40S	AR10/AR20	140,0	3,300	●	●	●	●
168,28	88,90	10,97	7,62	6" x 3" SCH 80S	AR20	140,0	4,960	●	●	●	●
168,28	114,30	3,40	3,05	6" x 4" SCH 10S	AR10/AR20	140,0	1,650	●	●	●	●
168,28	114,30	8,18	6,02	6" x 4" SCH 40S	AR10/AR20	140,0	3,300	●	●	●	●
168,28	114,30	10,97	8,56	6" x 4" SCH 80S	AR20	140,0	4,960	●	●	●	●

● = voorraad
○ = af fabriek

● = stock
○ = ex works

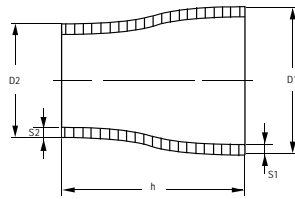

Lasverloop (concentrisch)

Reducers (concentric)

ASTM-A 403 ASME B16.9

EN 10204 3.1



D 1 mm	D 2 mm	S 1 mm	S 2 mm	INCH-GAS-SCH	Art. no. Welded / Seamless	h	Kg/pc	304/L		316/L	
								Welded	Seamless	Welded	Seamless
219,08	114,30	3,76	3,05	8" x 4" SCH 10S	AR10/AR20	152	2,43	●	○	●	○
219,08	114,30	8,18	6,02	8" x 4" SCH 40S	AR10/AR20	152	5,10	●	○	●	○
219,08	168,28	3,76	3,40	8" x 6" SCH 10S	AR10/AR20	152	2,72	●	●	●	●
219,08	168,28	8,18	7,11	8" x 6" SCH 40S	AR10/AR20	152	5,71	●	●	●	●
219,08	168,28	12,70	10,97	8" x 6" SCH 80S	AR20	152	8,86		●	●	●
273,05	168,28	4,19	3,40	10" x 6" SCH 10S	AR10/AR20	179	4,14	●	○	●	○
273,05	168,28	9,27	7,11	10" x 6" SCH 40S	AR10/AR20	179	8,78	●	○	●	○
273,05	219,08	4,19	3,76	10" x 8" SCH 10S	AR10/AR20	179	4,49	●	○	●	○
273,05	219,08	9,27	8,18	10" x 8" SCH 40S	AR10/AR20	179	9,58	●	○	●	○
323,85	168,28	4,57	3,40	12" x 6" SCH 10S	AR10/AR20	203	5,92	●	○	●	○
323,85	168,28	9,53	7,11	12" x 6" SCH 40S	AR10/AR20	203	11,80	●	○	●	○
323,85	219,08	4,57	3,76	12" x 8" SCH 10S	AR10/AR20	203	6,31	●	○	●	○
323,85	219,08	9,53	8,18	12" x 8" SCH 40S	AR10/AR20	203	12,70	●	○	●	○
323,85	273,05	4,57	4,19	12" x 10" SCH 10S	AR10/AR20	203	6,78	●	○	●	○
323,85	273,05	9,53	9,27	12" x 10" SCH 40S	AR10/AR20	203	13,60	●	○	●	○
355,60	273,05	4,78	4,19	14" x 10" SCH 10S	AR11/AR20	330,2	12,10	○	○	○	○
355,60	273,05	9,53	9,27	14" x 10" SCH 40S	AR11/AR20	330,2	23,60	○	○	○	○
355,60	323,85	4,78	4,57	14" x 12" SCH 10S	AR11/AR20	330,2	13,00	●	○	●	○
355,60	323,85	9,53	9,53	14" x 12" SCH 40S	AR11/AR20	330,2	25,40	○	○	○	○
406,40	323,85	4,78	4,57	16" x 12" SCH 10S	AR11/AR20	355,6	15,200	●	○	○	○
406,40	323,85	9,53	9,53	16" x 12" SCH 40S	AR11/AR20	355,6	29,600	○	○	○	○
406,40	355,60	4,78	4,78	16" x 14" SCH 10S	AR11/AR20	355,6	15,800	●	○	●	○
406,40	355,60	9,53	9,53	16" x 14" SCH 40S	AR11/AR20	355,6	31,000	○	○	○	○
457,20	355,60	4,78	4,78	18" x 14" SCH 10S	AR11	381,0	18,200	○	○	○	○
457,20	355,60	9,53	9,53	18" x 14" SCH 40S	AR11	381,0	35,700	○	○	○	○
457,20	406,40	4,78	4,78	18" x 16" SCH 10S	AR11	381,0	19,200	○	○	○	○
457,20	406,40	9,53	9,53	18" x 16" SCH 40S	AR11	381,0	37,800	○	○	○	○
508,00	406,40	5,54	4,78	20" x 16" SCH 10S	AR11	508,0	31,700	○	○	○	○
508,00	406,40	9,53	9,53	20" x 16" SCH 40S	AR11	508,0	53,500	○	○	○	○
508,00	457,20	5,54	4,78	20" x 18" SCH 10S	AR11	508,0	33,100	○	○	○	○
508,00	457,20	9,53	9,53	20" x 18" SCH 40S	AR11	508,0	56,400	○	○	○	○

● = voorraad
○ = af fabriek

● = stock
○ = ex works

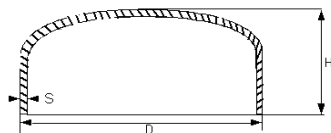

Laskap

End cap

ASTM-A 403 ASME B16.9

EN 10204 3.1



D mm	S mm	INCH-GAS-SCH	H	Art. no.	Kg / pc	304/L	316/L
21,34	2,11	1/2" SCH 10S	25,4	AC10	0,050	●	●
21,34	2,77	1/2" SCH 40S	25,4	AC10	0,070	●	●
21,34	3,73	1/2" SCH 80S	25,4	AC10	0,080	○	○
26,67	2,11	3/4" SCH 10S	25,4	AC10	0,060	●	●
26,67	2,87	3/4" SCH 40S	25,4	AC10	0,080	●	●
26,67	3,91	3/4" SCH 80S	25,4	AC10	0,090	○	○
33,40	2,77	1" SCH 10S	38,1	AC10	0,075	●	●
33,40	3,38	1" SCH 40S	38,1	AC10	0,090	●	●
33,40	4,55	1" SCH 80S	38,1	AC10	0,110	○	○
42,16	2,77	1.1/4" SCH 10S	38,1	AC10	0,100	●	●
42,16	3,56	1.1/4" SCH 40S	38,1	AC10	0,130	●	●
42,16	4,85	1.1/4" SCH 80S	38,1	AC10	0,160	○	○
48,26	2,77	1.1/2" SCH 10S	38,1	AC10	0,130	●	●
48,26	3,68	1.1/2" SCH 40S	38,1	AC10	0,170	●	●
48,26	5,08	1.1/2" SCH 80S	38,1	AC10	0,220	○	○
60,33	2,77	2" SCH 10S	38,1	AC10	0,190	●	●
60,33	3,91	2" SCH 40S	38,1	AC10	0,260	●	●
60,33	5,54	2" SCH 80S	38,1	AC10	0,350	○	○
73,03	3,05	2.1/2" SCH 10S	38,1	AC10	0,240	●	●
73,03	5,16	2.1/2" SCH 40S	38,1	AC10	0,410	●	●
73,03	7,01	2.1/2" SCH 80S	38,1	AC10	0,510	○	○
88,90	3,05	3" SCH 10S	50,8	AC10	0,370	●	●
88,90	5,49	3" SCH 40S	50,8	AC10	0,680	●	●
88,90	7,56	3" SCH 80S	50,8	AC10		○	○
114,30	3,05	4" SCH 10S	63,5	AC10	0,570	●	●
114,30	6,02	4" SCH 40S	63,5	AC10	1,130	●	●
114,30	8,56	4" SCH 80S	63,5	AC10	1,510	○	○
141,30	3,40	5" SCH 10S	76,2	AC10	1,100	●	●
141,30	6,55	5" SCH 40S	76,2	AC10	2,120	●	●
168,28	3,40	6" SCH 10S	88,9	AC10	1,410	●	●
168,28	7,11	6" SCH 40S	88,9	AC10	2,950	●	●
168,28	10,97	6" SCH 80S	88,9	AC10	4,240	○	○
219,08	3,76	8" SCH 10S	101,6	AC10	2,470	●	●
219,08	12,70	8" SCH 80S	101,6	AC10	7,800	●	●
273,05	4,19	10" SCH 10S	127,0	AC10	4,510	●	●
273,05	9,27	10" SCH 40S	127,0	AC10	10,000	●	●

● = voorraad
○ = af fabriek

● = stock
○ = ex works

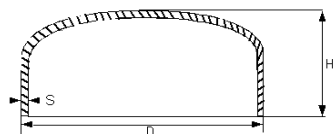

Laskap
End cap



EN 10204 3.1

D mm	S mm	INCH-GAS-SCH	H	Art. no.	Kg / pc	304/L	316/L
323,85	4,57	12" SCH 10S	152,4	AC10	6,670	●	●
323,85	9,53	12" SCH 40S	152,4	AC10	13,900	●	●
355,60	4,78	14" SCH 10S	165,1	AC10	8,160	●	●
355,60	9,53	14" SCH 40S	165,1	AC10	15,900	●	●
406,40	4,19	16" SCH 10S	177,8	AC10	14,510	●	●
406,40	4,19	16" SCH 40S	177,8	AC10	20,000	●	●
457,20	4,78	18" SCH 10S	203,2	AC10	17,960	○	○
457,20	9,53	18" SCH 40S	203,2	AC10		○	○
508,00	4,78	20" SCH 10S	228,6	AC10	27,220	○	○
508,00	9,53	20" SCH 40S	228,6	AC10		○	○
609,60	4,78	24" SCH 10S	266,7	AC10	34,470	○	○
609,60	9,53	24" SCH 40S	266,7	AC10		○	○

● = voorraad
○ = af fabriek

● = stock
○ = ex works

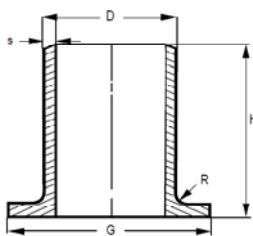

Stub end type A

Stub end Type A

MSS SP 43, ASTM-A403 / ASME B16.9

EN 10204 3.1



D mm	S mm	INCH-GAS-SCH	h	G	R	Art. no. Welded / Seamless	Kg/pc	304		316	
								Welded	Seamless	Welded	Seamless
21,34	2,11	1/2" SCH 10S	50,8	34,9	3,18	AS10/AS20	0,06	●	●	○	●
21,34	2,77	1/2" SCH 40S	50,8	34,9	3,18	AS10/AS20	0,08	○	●	○	●
21,34	3,73	1/2" SCH 80S	50,8	34,9	3,18	AS20	0,15		○		○
26,67	2,11	3/4" SCH 10S	50,8	42,9	3,18	AS10/AS20	0,08	○	●	○	●
26,67	2,87	3/4" SCH 40S	50,8	42,9	3,18	AS10/AS20	0,10	○	●	○	●
26,67	3,91	3/4" SCH 80S	50,8	42,9	3,18	AS20	0,20		○		○
33,40	2,77	1" SCH 10S	50,8	50,8	3,18	AS10/AS20	0,13	○	●	○	●
33,40	3,38	1" SCH 40S	50,8	50,8	3,18	AS10/AS20	0,16	○	●	○	●
33,40	4,55	1" SCH 80S	50,8	50,8	3,18	AS20	0,39		○		○
42,60	2,77	1.1/4" SCH 10S	50,8	63,5	4,76	AS10/AS20	0,18	○	●	○	●
42,16	3,56	1.1/4" SCH 40S	50,8	63,5	4,76	AS10/AS20	0,23	○	●	○	●
42,16	4,85	1.1/4" SCH 80S	50,8	63,5	4,76	AS20	0,59		○		○
48,26	2,77	1.1/2" SCH 10S	50,8	73,0	6,35	AS10/AS20	0,21	○	●	○	●
48,26	3,68	1.1/2" SCH 40S	50,8	73,0	6,35	AS10/AS20	0,28	○	●	○	●
48,26	5,08	1.1/2" SCH 80S	50,8	73,0	6,35	AS20	0,68		○		○
60,33	2,77	2" SCH 10S	50,8	92,1	7,94	AS10/AS20	0,34	○	●	○	●
60,33	3,91	2" SCH 40S	63,5	92,1	7,94	AS10/AS20	0,47	○	●	○	●
60,33	5,54	2" SCH 80S	63,5	92,1	7,94	AS20	1,37		○		○
73,03	3,05	2.1/2" SCH 10S	63,5	104,8	7,94	AS10/AS20	0,45	○	●	○	●
73,03	5,16	2.1/2" SCH 40S	63,5	104,8	7,94	AS10/AS20	0,74	○	●	○	●
88,90	3,05	3" SCH 10S	63,5	127,0	9,53	AS10/AS20	0,57	○	●	○	○
88,90	5,49	3" SCH 40S	63,5	127,0	9,53	AS10/AS20	1,01	○	●	○	○
114,30	3,05	4" SCH 10S	76,2	157,2	11,11	AS10/AS20	0,87	○	●	○	●
114,30	6,02	4" SCH 40S	76,2	157,2	11,11	AS10/AS20	1,68	○	●	○	●
141,30	3,40	5" SCH 10S	76,2	185,7	11,11	AS10/AS20	1,21	○	○	○	○
141,30	6,55	5" SCH 40S	76,2	185,7	11,11	AS10/AS20	2,28	○	○	○	○
168,28	3,40	6" SCH 10S	88,9	215,9	12,70	AS10/AS20	1,64	●	○	●	○
168,28	7,11	6" SCH 40S	88,9	215,9	12,70	AS10/AS20	3,37	●	○	●	○
219,08	3,76	8" SCH 10S	101,6	269,0	12,70	AS10/AS20	2,65	●	○	●	○
219,08	8,18	8" SCH 40S	101,6	269,0	12,70	AS10/AS20	5,67	●	○	●	○
273,05	4,19	10" SCH 10S	127,0	323,9	12,70	AS10/AS20	4,38	●	○	●	○
273,05	9,27	10" SCH 40S	127,0	323,9	12,70	AS10/AS20	9,55	●	○	●	○
323,85	4,57	12" SCH 10S	152,4	381,0	12,70	AS10/AS20	6,74	●	○	●	○
323,85	9,53	12" SCH 40S	152,4	381,0	12,70	AS10/AS20	13,80	●	○	●	○
355,60	4,78	14" SCH 10S	355,6	412,8	12,70	AS11/AS20	7,73	●	○	●	○
406,40	4,78	16" SCH 10S	406,4	469,9	12,70	AS11/AS20	9,00	●	○	●	○

● = voorraad
○ = af fabriek

● = stock
○ = ex works