

Sok

Socket

ISO 228-1G

EN ISO 4144

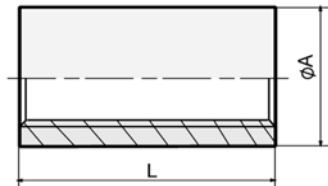

Inch	DN	L mm	ØA mm	Art. no.	4308 (304)	4408 (316)
1/8"	6	18,0	16,0	TB01	●	●
1/4"	8	26,0	19,5	TB01	●	●
3/8"	10	27,0	22,3	TB01	●	●
1/2"	15	34,0	27,7	TB01	●	●
3/4"	20	36,0	33,6	TB01	●	●
1"	25	43,0	39,5	TB01	●	●
1.1/4"	32	48,0	48,3	TB01	●	●
1.1/2"	40	48,0	54,6	TB01	●	●
2"	50	56,0	66,3	TB01	●	●
2.1/2"	65	65,0	82,0	TB01	○	○
3"	80	71,0	100,5	TB01	○	○
4"	100	83,0	122,0	TB01	○	○

Sok uit buis

Socket from pipe

ISO 228-1G

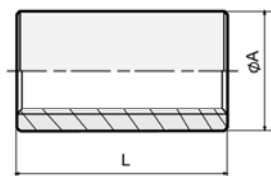

Inch	DN	L mm	ØA mm	Art. no.	304L	316L
1/8"	6	18	14	TB03	○	●
1/4"	8	25	18,52	TB03	●	●
3/8"	10	26	21,3	TB03	●	●
1/2"	15	34	26,4	TB03	●	●
3/4"	20	36	31,8	TB03	●	●
1"	25	43	39,5	TB03	●	●
1.1/4"	32	48	48,3	TB03	●	●
1.1/2"	40	48	54,5	TB03	●	●
2"	50	56	66,3	TB03	●	●
2.1/2"	65	65	82	TB03	○	●
3"	80	81	95	TB03	○	●
4"	100	83	122	TB03	○	●

● = voorraad
○ = af fabriek

● = stock
○ = ex works

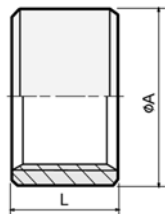

Halve sok

Half socket

ISO 228-1G

EN ISO 4144



Inch	DN	L mm	ØA mm	Art. no.	4308 (304)	4408 (316)
1/8"	6	18	14	TB02	○	●
1/4"	8	25	18,52	TB02	●	●
3/8"	10	26	21,3	TB02	●	●
1/2"	15	34	26,4	TB02	●	●
3/4"	20	36	31,8	TB02	●	●
1"	25	43	39,5	TB02	●	●
1.1/4"	32	48	48,3	TB02	●	●
1.1/2"	40	48	54,5	TB02	●	●
2"	50	56	66,3	TB02	●	●
2.1/2"	65	65	82	TB02	○	○
3"	80	81	95	TB02	○	○
4"	100	83	122	TB02	○	○

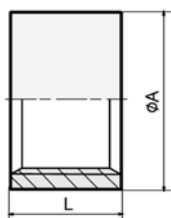

Halve sok uit buis

Half socket from pipe

ISO 228-1G



Inch	DN	L mm	ØA mm	Art. no.	304L	316L
1/8"	6	10	14	TB04	○	●
1/4"	8	11	18,52	TB04	●	●
3/8"	10	12	21,3	TB04	●	●
1/2"	15	15	26,4	TB04	●	●
3/4"	20	18	31,8	TB04	●	●
1"	25	20	39,5	TB04	●	●
1.1/4"	32	22	48,3	TB04	●	●
1.1/2"	40	22	54,5	TB04	●	●
2"	50	26	66,3	TB04	●	●
2.1/2"	65	31	82	TB04	○	●
3"	80	34	95	TB04	○	●
4"	100	39	122	TB04	○	●

● = voorraad
○ = af fabriek

● = stock
○ = ex works

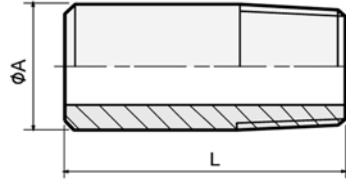

Lasnippel uit buis

Welding nipple from pipe

ISO 7-1R



Inch	1/8"	1/4"	3/8"	1/2"	3/4"	1"	1.1/4"	1.1/2"	2"	2.1/2"	3"	4"	5"	6"
DN	6	8	10	15	20	25	32	40	50	65	80	100	125	150
ØA	10	13,5	17,2	21,3	26,9	33,7	42,4	48,3	60,3	76	89	114	140	168
tp	316L	316L	316L	316L	316L	316L	316L	316L	316L	316L	316L	316L	316L	316L
L = 30mm	●	● + 304L	● + 304L	●	○	○	○	○						
L = 35mm	○	○	○	● + 304L	○	○	○	○						
L = 40mm	○	●	●	●	● + 304L	● + 304L	○	○	○					
L = 50mm	○	●	●	●	●	●	● + 304L	● + 304L	● + 304L	○				
L = 60mm	○	●	●	●	●	●	●	●	●	●	○			
L = 70mm	○	●	●	●	●	●	●	●	●	○	○	○		
L = 80mm	○	●	●	●	●	●	●	●	●	○	○	●	○	
L = 90mm	○	●	●	●	●	●	●	●	●	○	○	○	○	○
L = 100mm	○	●	●	●	●	●	●	●	●	○	○	○	○	○
L = 110mm	○	●	●	●	●	●	●	●	●	○	○	○	○	○
L = 120mm	○	●	●	●	●	●	●	●	●	○	○	○	○	○
L = 130mm	○	●	●	●	●	●	●	●	●	○	○	○	○	○
L = 140mm	○	●	●	●	●	●	●	●	●	○	○	○	○	○
L = 150mm	○	●	●	●	●	●	●	●	●	○	○	○	○	○
L = 160mm	○	●	●	●	●	●	●	●	●	○	○	○	○	○
L = 170mm	○	●	●	●	●	●	●	●	●	○	○	○	○	○
L = 180mm	○	●	●	●	●	●	●	●	●	○	○	○	○	○
L = 190mm	○	●	●	●	●	●	●	●	●	○	○	○	○	○
L = 200mm	○	●	●	●	●	●	●	●	●	○	○	○	○	○
L = 210mm	○	●	●	●	●	●	●	●	●	○	○	○	○	○
L = 220mm	○	●	●	●	●	●	●	●	●	○	○	○	○	○
L = 230mm	○	●	●	●	●	●	●	●	●	○	○	○	○	○
L = 240mm	○	●	●	●	●	●	●	●	●	○	○	○	○	○
L = 250mm	○	●	●	●	●	●	●	●	●	○	○	○	○	○
L = 260mm	○	●	●	●	●	●	●	●	●	○	○	○	○	○
L = 270mm	○	●	●	●	●	●	●	●	●	○	○	○	○	○
L = 280mm	○	●	●	●	●	●	●	●	●	○	○	○	○	○
L = 290mm	○	●	●	●	●	●	●	●	●	○	○	○	○	○
L = 300mm	○	●	●	●	●	●	●	●	●	○	○	○	○	○

● = voorraad
○ = af fabriek

● = stock
○ = ex works

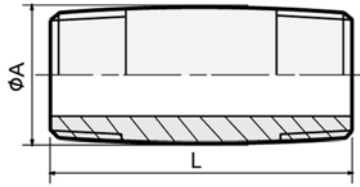

Pijpnippel uit buis

Barrel nipple from tube

ISO 7-1R



inch	1/8"	1/4"	3/8"	1/2"	3/4"	1"	1.1/4"	1.1/2"	2"	2.1/2"	3"	4"	5"	6"
DN	6	8	10	15	20	25	32	40	50	65	80	100	125	150
ØA	10,2	13,5	17,2	21,3	26,9	33,7	42,4	48,3	60,3	76	89	114	140	168
tp	316L	316L	316L	316L	316L	316L	316L	316L	316L	316L	316L	316L	316L	316L
L = 30mm	●	●	○	●	○	○								
L = 35mm	○	○	○	○	○	○								
L = 40mm	●	●+304L	●+304L	●	●	●	○	○						
L = 50mm	○	●	●	●	●	●	●	●	○					
L = 60mm	○	●	●	●+304L	●+304L	●+304L	●	●	●	○				
L = 70mm	○	●	●	●	●	●	●	●	●	○	○			
L = 80mm	○	●	●	●	●	●	●+304L	●+304L	●	○	○	○		
L = 90mm	○	●	●	●	●	●	●	●	●	○	○	○		
L = 100mm	○	●	●	●	●	●	●	●	●+304L	●	○	○		
L = 110mm	○	●	●	●	●	●	●	●	●	○	○	○		
L = 120mm	○	●	●	●	●	●	●	●	●	○	●	●	○	○
L = 130mm	○	●	●	●	●	●	●	●	●	○	○	○	○	○
L = 140mm	○	●	●	●	●	●	●	●	●	○	○	○	○	○
L = 150mm	○	●	●	●	●	●	●	●	●	○	○	○	○	○
L = 160mm	○	●	●	●	●	●	●	●	●	○	○	○	○	○
L = 170mm	○	●	●	●	●	●	●	●	●	○	○	○	○	○
L = 180mm	○	●	●	●	●	●	●	●	●	○	○	○	○	○
L = 190mm	○	●	●	●	●	●	●	●	●	○	○	○	○	○
L = 200mm	○	●	●	●	●	●	●	●	●	○	○	○	○	○
L = 210mm	○	●	●	●	●	●	●	●	●	○	○	○	○	○
L = 220mm	○	●	●	●	●	●	●	●	●	○	○	○	○	○
L = 230mm	○	●	●	●	●	●	●	●	●	○	○	○	○	○
L = 240mm	○	●	●	●	●	●	●	●	●	○	○	○	○	○
L = 250mm	○	●	●	●	●	●	●	●	●	○	○	○	○	○
L = 260mm	○	●	●	●	●	●	●	●	●	○	○	○	○	○
L = 270mm	○	●	●	●	●	●	●	●	●	○	○	○	○	○
L = 280mm	○	●	●	●	●	●	●	●	●	○	○	○	○	○
L = 290mm	○	●	●	●	●	●	●	●	●	○	○	○	○	○
L = 300mm	○	●	●	●	●	●	●	●	●	○	○	○	○	○

● = voorraad
○ = af fabriek

● = stock
○ = ex works

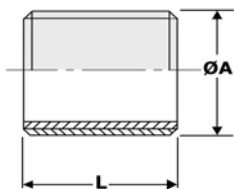

Draadnippel uit buis

Parallel nipple from tube

ISO 228



Inch	DN	L mm	ØA mm	Art. no.	304L	316L
1/8"	6	16	10,2	TB08	○	●
1/4"	8	18	13,5	TB08	○	●
3/8"	10	22	18,2	TB08	○	●
1/2"	15	25	21,3	TB08	○	●
3/4"	20	30	26,9	TB08	○	●
1"	25	35	33,8	TB08	○	●
1.1/4"	32	38	42,4	TB08	○	●
1.1/2"	40	38	48,3	TB08	○	●
2"	50	45	60,3	TB08	○	●
2.1/2"	65	55	86,1	TB08	○	○
3"	80	60	88,9	TB08	○	○
4"	100	80	114,3	TB08	○	○

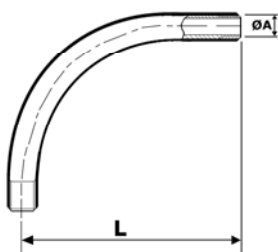

Bocht BU / BU uit buis

Bend M / M from tube

ISO 228



Inch	DN	L mm	ØA mm	Art. no.	304L	316L
1/8"	6	50	10,2	TB10	○	●
1/4"	8	60	13,5	TB10	○	●
3/8"	10	80	18,2	TB10	○	●
1/2"	15	80	21,3	TB10	○	●
3/4"	20	100	26,9	TB10	○	●
1"	25	120	33,8	TB10	○	●
1.1/4"	32	140	42,4	TB10	○	●
1.1/2"	40	160	48,3	TB10	○	●
2"	50	190	60,3	TB10	○	●
2.1/2"	65	240	86,1	TB10	○	○
3"	80	290	88,9	TB10	○	○

● = voorraad
○ = af fabriek

● = stock
○ = ex works

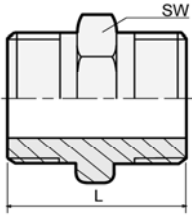

Zeskant nipple

Hexagon nipple

ISO 8-1R

EN ISO 4144



Inch	DN	L mm	SW mm	Art. no.	4308 (304)	4408 (316)
1/8"	6	23,6	12,0	TB11	○	●
1/4"	8	27,8	16,0	TB11	●	●
3/8"	10	28,0	19,0	TB11	●	●
1/2"	15	34,0	21,6	TB11	●	●
3/4"	20	40,0	30,0	TB11	●	●
1"	25	46,0	36,0	TB11	●	●
1.1/4"	32	52,5	46,0	TB11	●	●
1.1/2"	40	54,0	50,0	TB11	●	●
2"	50	62,0	64,5	TB11	●	●
2.1/2"	65	70,0	79,5	TB11	○	●
3"	80	78,4	90,0	TB11	○	●
4"	100	94,0	120,0	TB11	○	●

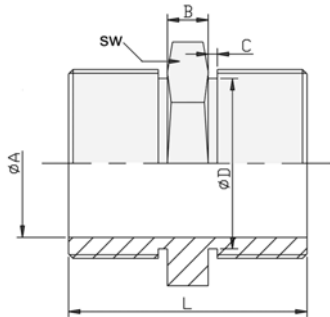

Zeskant nipple cilindrische draad

Hexagon nipple parallel thread

ISO 228

EN ISO 4144



Inch	DN	L mm	SW mm	A mm	B mm	ØC mm	ØD mm	Art. no.	4308 (304)	4408 (316)
1/8"	6	23,6	12,0	4,3	8,5	2,0	8,5	TB12	○	●
1/4"	8	27,8	16,0	7,0	11,4	3,0	11,4	TB12	○	●
3/8"	10	26	19,0	9,4	14,0	3,0	14,0	TB12	○	●
1/2"	15	35	21,6	13,7	18,0	4,0	18,0	TB12	○	●
3/4"	20	40	30,0	19,0	24,0	4,0	24,0	TB12	○	●
1"	25	46	36,0	25,5	30,0	4,0	30,0	TB12	○	●
1.1/4"	32	52,5	46,0	32,0	39,0	4,0	39,0	TB12	○	●
1.1/2"	40	54	50,0	38,5	45,0	4,0	45,0	TB12	○	●
2"	50	62	64,5	50,2	56,5	4,0	56,5	TB12	○	●
2.1/2"	65	70	79,5	63,8	72,0	4,0	72,0	TB12	○	○
3"	80	78,4	90,0	77,0	85,0	4,0	85,0	TB12	○	○
4"	100	94	120,0	102,0	110,0	4,0	110,0	TB12	○	○

● = voorraad
○ = af fabriek

● = stock
○ = ex works

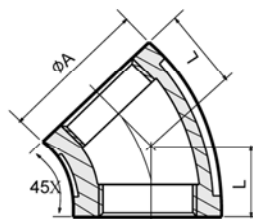

Knie 45° BI / BI

Elbow 45° F / F

ISO 228-1G

EN ISO 4144



Inch	DN	ØA mm	L mm	Art. no.	4308 (304)	4408 (316)
1/8"	6	18,0	18,0	TB13	○	●
1/4"	8	21,0	19,4	TB13	○	●
3/8"	10	25,0	20,0	TB13	○	●
1/2"	15	29,5	22,0	TB13	○	●
3/4"	20	35,6	25,0	TB13	○	●
1"	25	43,0	28,0	TB13	○	●
1.1/4"	32	52,4	33,0	TB13	○	●
1.1/2"	40	58,0	36,0	TB13	○	●
2"	50	72,0	43,0	TB13	○	●
2.1/2"	65	87,0	50,0	TB13	○	●
3"	80	100,0	55,0	TB13	○	●
4"	100	125,5	64,0	TB13	○	●

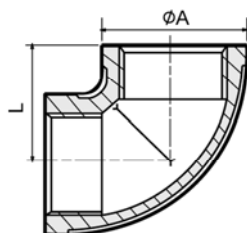

Knie 90° BI / BI

Elbow 90° F / F

ISO 228-1G

EN ISO 4144



Inch	DN	ØA mm	L mm	Art. no.	4308 (304)	4408 (316)
1/8"	6	17,0	19,0	TB14	○	●
1/4"	8	21,3	21,0	TB14	●	●
3/8"	10	23,5	21,3	TB14	●	●
1/2"	15	29,0	27,0	TB14	●	●
3/4"	20	36,0	33,0	TB14	●	●
1"	25	43,0	38,0	TB14	●	●
1.1/4"	32	52,0	45,0	TB14	●	●
1.1/2"	40	58,5	50,0	TB14	●	●
2"	50	71,5	57,0	TB14	●	●
2.1/2"	65	87,0	69,7	TB14	○	●
3"	80	99,5	77,0	TB14	○	●
4"	100	126,0	98,2	TB14	○	●

● = voorraad
○ = af fabriek

● = stock
○ = ex works

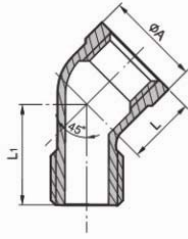

Knie 45° BI / BU

Elbow 90° M / F

ISO 8-1R / ISO 228-1G

EN ISO 4144



Inch	DN	ØA mm	L mm	L1 mm	Art. no.	4308 (304)	4408 (316)
1/8"	6	17	16	21	TB19	○	●
1/4"	8	21	17	23	TB19	○	●
3/8"	10	25	19	27	TB19	○	●
1/2"	15	29	21	31	TB19	○	●
3/4"	20	35	25	36	TB19	○	●
1"	25	43	29	42	TB19	○	●
1.1/4"	32	52	34	49	TB19	○	●
1.1/2"	40	58	37	51	TB19	○	●
2"	50	71	42	59	TB19	○	●
2.1/2"	65	88	49	71	TB19	○	●
3"	80	101	54	79	TB19	○	●
4"	100	129	65	96	TB19	○	●

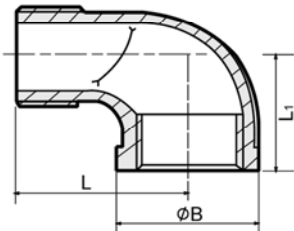

Knie 90° BI / BU

Elbow 90° M / F

ISO 8-1R / ISO 228-1G

EN ISO 4144



Inch	DN	ØB mm	L mm	L1 mm	Art. no.	4308 (304)	4408 (316)
1/8"	6	17,0	25,0	19,0	TB20	○	●
1/4"	8	21,0	28,3	21,0	TB20	●	●
3/8"	10	25,0	32,0	25,0	TB20	●	●
1/2"	15	29,0	42,0	28,0	TB20	●	●
3/4"	20	35,0	50,5	33,0	TB20	●	●
1"	25	43,0	52,0	39,0	TB20	●	●
1.1/4"	32	52,0	60,0	45,0	TB20	●	●
1.1/2"	40	58,8	65,0	50,0	TB20	●	●
2"	50	71,7	74,0	58,0	TB20	●	●
2.1/2"	65	88,2	99,0	69,0	TB20	○	●
3"	80	100,0	114,5	78,0	TB20	○	●
4"	100	126,5	146,5	97,0	TB20	○	●

● = voorraad
○ = af fabriek

● = stock
○ = ex works

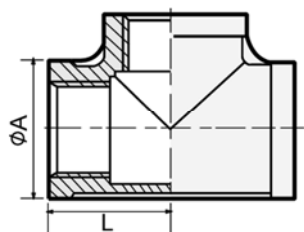

T-Stuk

Equal tee

ISO 228-1G

EN ISO 4144



Inch	DN	ØA mm	L mm	Art. no.	4308 (304)	4408 (316)
1/8"	6	17,0	19,0	TB22	●	●
1/4"	8	21,3	21,0	TB22	●	●
3/8"	10	23,5	23,6	TB22	●	●
1/2"	15	30,0	28,0	TB22	●	●
3/4"	20	35,0	33,0	TB22	●	●
1"	25	43,0	38,0	TB22	●	●
1.1/4"	32	52,0	45,0	TB22	●	●
1.1/2"	40	58,5	50,0	TB22	●	●
2"	50	71,5	58,0	TB22	●	●
2.1/2"	65	87,0	70,0	TB22	○	●
3"	80	100,0	78,5	TB22	○	●
4"	100	125,0	97,0	TB22	○	●

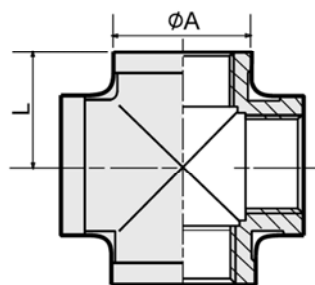

Kruisstuk

Gross

ISO 228-1G

EN ISO 4144



Inch	DN	ØA mm	L mm	Art. no.	4308 (304)	4408 (316)
1/8"	6	15,2	17,0	TB25	○	●
1/4"	8	19,7	18,5	TB25	○	●
3/8"	10	23,3	22,9	TB25	○	●
1/2"	15	28,0	26,8	TB25	○	●
3/4"	20	34,6	32,0	TB25	○	●
1"	25	43,6	37,5	TB25	○	●
1.1/4"	32	53,0	45,9	TB25	○	●
1.1/2"	40	58,0	47,6	TB25	○	●
2"	50	71,0	58,0	TB25	○	●
2.1/2"	65	87,0	70,0	TB25	○	●
3"	80	100,0	77,0	TB25	○	●
4"	100	126,0	97,0	TB25	○	●

● = voorraad
○ = af fabriek

● = stock
○ = ex works

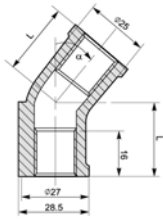

Knie met strip BI / BI

Elbow with bar F / F

ISO 228- 1G



Inch	DN	α	L mm	Art.no	4308 (304)	4408 (316)
1/2"	15	45°	22,8	TB15	●	●
1/2"	15	60°	25,6	TB16	●	●
1/2"	15	75°	28,5	TB17	●	●
1/2"	15	90°	27,7	TB18	●	●

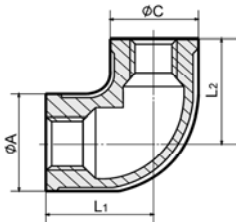

Verloop knie 90° BI / BI

Reducing elbow 90° F / F

ISO 228- 1G

EN ISO 4144



Inch	inch	DN	DN	ØA mm	ØC mm	L1 mm	L2 mm	Art. no.	4308 (304)	4408 (316)
1/4"	1/8"	8	6	19,0	15,5	18,5	18,5	TB21	○	●
3/8"	1/8"	10	6	22,5	15,5	19,5	20,5	TB21	○	●
3/8"	1/4"	8	8	22,5	19,0	20,5	22,5	TB21	○	●
1/2"	1/8"	15	6	27,5	15,5	22,5	23,5	TB21	○	●
1/2"	1/4"	15	8	27,5	19,0	24,5	24,5	TB21	○	●
1/2"	3/8"	15	10	27,5	22,5	26,5	25,5	TB21	○	●
3/4"	1/4"	20	8	33,0	19,0	27,5	26,5	TB21	○	●
3/4"	3/8"	20	10	33,0	22,5	28,5	28,5	TB21	○	●
3/4"	1/2"	20	15	33,0	27,5	29,5	30,5	TB21	○	●
1"	1/4"	25	8	40,5	19,0	28,5	30,5	TB21	○	●
1"	3/8"	25	10	40,5	22,5	30,5	32,0	TB21	○	●
1"	1/2"	25	15	40,5	27,5	32,5	33,5	TB21	○	●
1"	3/4"	25	20	40,5	33,0	34,5	35,5	TB21	○	●
1.1/4"	3/8"	32	10	50,0	22,5	34,0	36,5	TB21	○	●
1.1/4"	1/2"	32	15	50,0	27,5	36,5	38,5	TB21	○	●
1.1/4"	3/4"	32	20	50,0	33,0	38,5	40,5	TB21	○	●
1.1/4"	1"	32	25	50,0	40,5	40,5	42,5	TB21	○	●
1.1/2"	3/8"	40	10	56,5	22,5	34,0	40,0	TB21	○	●
1.1/2"	1/2"	40	15	56,5	27,5	36,0	41,5	TB21	○	●
1.1/2"	3/4"	40	20	56,5	33,0	38,5	43,5	TB21	○	●
1.1/2"	1"	40	25	56,5	40,5	41,5	45,5	TB21	○	●
1.1/2"	1.1/4"	40	32	56,5	50,0	45,5	48,5	TB21	○	●
2"	1/2"	50	15	70,0	27,5	42,0	51,5	TB21	○	●
2"	3/4"	50	20	70,0	33,0	44,0	52,5	TB21	○	●
2"	1"	50	25	70,0	40,5	46,5	53,5	TB21	○	●
2"	1.1/4"	50	32	70,0	50,0	48,5	54,5	TB21	○	●
2"	1.1/2"	50	40	70,0	56,5	52,5	55,5	TB21	○	●

● = voorraad
○ = af fabriek

● = stock
○ = ex works

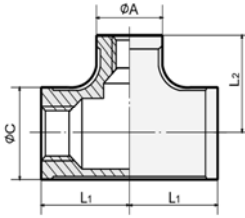

Verloop T-stuk BI / BI / BI

Reducing tee F / F / F

ISO 228-1G

EN ISO 4144



Inch	inch	DN	DN	ØA mm	ØC mm	L1 mm	L2 mm	Art. no.	4308 (304)	4408 (316)
1/4"	1/8"	8	6	17.0	21.0	18.0	19.0	TB24	○	●
3/8"	1/8"	10	6	17.0	23.0	19.0	21.0	TB24	○	●
3/8"	1/4"	8	8	21.0	23.0	20.0	22.0	TB24	○	●
1/2"	1/8"	15	6	17.0	29.0	22.0	23.0	TB24	○	●
1/2"	1/4"	15	8	20.8	29.0	24.0	24.0	TB24	○	●
1/2"	3/8"	15	10	23.5	29.0	26.0	25.0	TB24	○	●
3/4"	1/4"	20	8	20.8	36.0	25.0	28.0	TB24	○	●
3/4"	3/8"	20	10	23.3	36.0	28.0	28.0	TB24	○	●
3/4"	1/2"	20	15	30.0	37.0	30.0	32.0	TB24	○	●
1"	1/4"	25	8	20.8	44.0	30.0	31.0	TB24	○	●
1"	3/8"	25	10	23.3	44.0	30.0	31.0	TB24	○	●
1"	1/2"	25	15	30.5	44.0	32.0	33.4	TB24	○	●
1"	3/4"	25	20	35.8	44.0	35.0	35.0	TB24	○	●
1.1/4"	3/8"	32	10	23.3	51.4	32.0	36.0	TB24	○	●
1.1/4"	1/2"	32	15	28.8	51.4	34.0	38.0	TB24	○	●
1.1/4"	3/4"	32	20	35.8	51.4	38.0	40.0	TB24	○	●
1.1/4"	1"	32	25	43.3	51.4	40.0	42.0	TB24	○	●
1.1/2"	3/8"	40	10	23.3	57.9	34.0	40.0	TB24	○	●
1.1/2"	1/2"	40	15	28.8	57.9	35.0	42.0	TB24	○	●
1.1/2"	3/4"	40	20	35.8	57.9	38.0	43.0	TB24	○	●
1.1/2"	1"	40	25	43.3	57.9	41.0	45.0	TB24	○	●
1.1/2"	1.1/4"	40	32	51.4	57.9	45.0	48.0	TB24	○	●
2"	1/2"	50	15	28.8	71.0	38.0	48.0	TB24	○	●
2"	3/4"	50	20	35.8	71.0	41.0	49.0	TB24	○	●
2"	1"	50	25	43.3	71.0	44.0	51.0	TB24	○	●
2"	1.1/4"	50	32	51.4	71.0	48.0	54.0	TB24	○	●
2"	1.1/2"	50	40	57.9	71.0	52.0	55.0	TB24	○	●

● = voorraad
○ = af fabriek

● = stock
○ = ex works

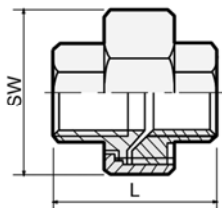

Koppeling konisch BI / BI

Union conical F / F

ISO 228-1G

EN ISO 4144



Inch	DN	L mm	SW mm	Art. no.	4308 (304)	4408 (316)
1/8"	6	29,0	25,0	TB26	○	●
1/4"	8	37,5	30,0	TB26	●	●
3/8"	10	38,0	35,0	TB26	●	●
1/2"	15	42,0	42,0	TB26	●	●
3/4"	20	50,4	47,0	TB26	●	●
1"	25	48,0	53,0	TB26	●	●
1.1/4"	32	59,0	71,0	TB26	●	●
1.1/2"	40	65,0	78,0	TB26	●	●
2"	50	69,0	92,0	TB26	●	●
2.1/2"	65	80,0	112,0	TB26	○	●
3"	80	88,0	127,0	TB26	○	●
4"	100	108,0	157,0	TB26	○	●

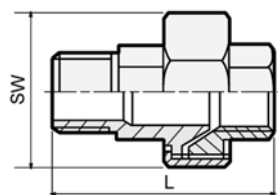

Koppeling konisch BI / BU

Union conical M / F

ISO 8-1R / ISO 228-1G

EN ISO 4144



Inch	DN	L mm	SW mm	Art. no.	4308 (304)	4408 (316)
1/8"	6	40,0	25,0	TB28	○	●
1/4"	8	50,0	30,0	TB28	●	●
3/8"	10	50,0	35,0	TB28	●	●
1/2"	15	58,0	42,0	TB28	●	●
3/4"	20	67,0	47,0	TB28	●	●
1"	25	68,3	53,0	TB28	●	●
1.1/4"	32	83,0	71,0	TB28	●	●
1.1/2"	40	86,3	78,0	TB28	●	●
2"	50	94,0	92,0	TB28	●	●
2.1/2"	65	113,3	112,0	TB28	○	●
3"	80	127,0	126,0	TB28	○	●
4"	100	154,5	157,0	TB28	○	●

● = voorraad
○ = af fabriek

● = stock
○ = ex works

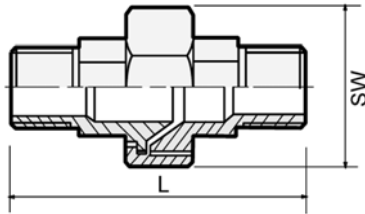

Koppeling conisch BU / BU

Union conical M / M

ISO 8-1R

EN ISO 4144



Inch	DN	L mm	SW mm	Art. no.	4308 (304)	4408 (316)
1/8"	6	52,0	25,0	TB28	○	●
1/4"	8	61,0	30,0	TB28	○	●
3/8"	10	62,5	35,0	TB28	○	●
1/2"	15	73,0	42,0	TB28	○	●
3/4"	20	82,0	47,0	TB28	○	●
1"	25	90,0	53,0	TB28	○	●
1.1/4"	32	104,0	71,0	TB28	○	●
1.1/2"	40	109,6	78,0	TB28	○	●
2"	50	118,0	92,0	TB28	○	●
2.1/2"	65	145,0	112,0	TB28	○	●
3"	80	164,0	126,0	TB28	○	●
4"	100	205,0	157,0	TB28	○	●

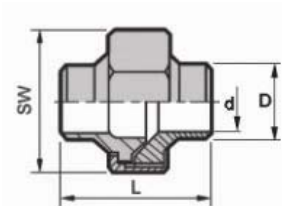

Koppeling conisch LAS / LAS

Union conical BW / BW

ANSI B16.25



Inch	DN	L mm	SW mm	D mm	d mm	Art. no.	4308 (304)	4408 (316)
1/8"	6	29,0	25,0	10,2	8,1	TB29	○	●
1/4"	8	35,5	30,0	13,5	10,0	TB29	●	●
3/8"	10	38,0	35,0	17,2	12,7	TB29	●	●
1/2"	15	42,0	42,0	21,3	16,7	TB29	●	●
3/4"	20	50,4	47,0	26,9	21,5	TB29	●	●
1"	25	48,0	53,0	33,7	26,5	TB29	●	●
1.1/4"	32	59,0	71,0	42,4	35,8	TB29	●	●
1.1/2"	40	64,0	78,0	48,3	42,0	TB29	●	●
2"	50	69,0	92,0	60,3	53,3	TB29	●	●
2.1/2"	65	80,0	112,0	76,1	66,5	TB29	○	●
3"	80	88,0	126,0	88,9	78,5	TB29	○	●
4"	100	108,0	157,0	114,3	104,0	TB29	○	●

● = voorraad
○ = af fabriek

● = stock
○ = ex works

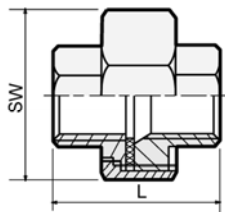

Koppeling vlak BI / BI

Union flat F / F

ISO 228-1G

EN ISO 4144



Inch	DN	L mm	SW mm	Art. no.	4308 (304)	4408 (316)
1/8"	6	29,0	25,0	TB32	●	●
1/4"	8	37,5	30,0	TB32	●	●
3/8"	10	38,0	35,0	TB32	●	●
1/2"	15	42,0	42,0	TB32	●	●
3/4"	20	50,4	47,0	TB32	●	●
1"	25	48,0	53,0	TB32	●	●
1.1/4"	32	59,0	71,0	TB32	●	●
1.1/2"	40	65,0	78,0	TB32	●	●
2"	50	69,0	92,0	TB32	●	●
2.1/2"	65	80,0	112,0	TB32	○	●
3"	80	88,0	127,0	TB32	○	●
4"	100	108,0	157,0	TB32	○	●

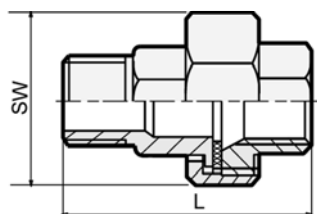

Koppeling vlak BI / BU

Union flat M / F

ISO 8-1R / ISO 228-1G

EN ISO 4144



Inch	DN	L mm	SW mm	Art. no.	4308 (304)	4408 (316)
1/8"	6	40,0	25,0	TB33	○	●
1/4"	8	50,0	30,0	TB33	●	●
3/8"	10	50,0	35,0	TB33	●	●
1/2"	15	58,0	42,0	TB33	●	●
3/4"	20	67,0	47,0	TB33	●	●
1"	25	68,3	53,0	TB33	●	●
1.1/4"	32	83,0	71,0	TB33	●	●
1.1/2"	40	86,3	78,0	TB33	●	●
2"	50	94,0	92,0	TB33	●	●
2.1/2"	65	113,3	112,0	TB33	○	●
3"	80	127,0	126,0	TB33	○	●
4"	100	154,5	157,0	TB33	○	●

● = voorraad
○ = af fabriek

● = stock
○ = ex works

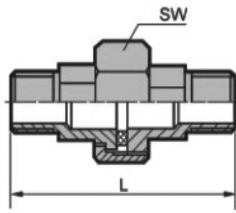

Koppeling vlak BU / BU

Union flat M / M

ISO 8-1R

EN ISO 4144



Inch	DN	L mm	SW mm	Art. no.	4308 (304)	4408 (316)
1/8"	6	52,0	25,0	TB34	○	●
1/4"	8	61,0	30,0	TB34	○	●
3/8"	10	62,5	35,0	TB34	○	●
1/2"	15	73,0	42,0	TB34	○	●
3/4"	20	82,0	47,0	TB34	○	●
1"	25	90,0	53,0	TB34	○	●
1.1/4"	32	104,0	71,0	TB34	○	●
1.1/2"	40	109,6	78,0	TB34	○	●
2"	50	118,0	92,0	TB34	○	●
2.1/2"	65	145,0	112,0	TB34	○	●
3"	80	164,0	126,0	TB34	○	●
4"	100	205,0	157,0	TB34	○	●

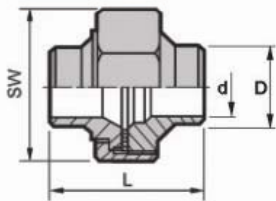

Koppeling vlak LAS / LAS

Union flat BW / BW

ANSI B16.25



Inch	DN	L mm	SW mm	D mm	d mm	Art. no.	4308 (304)	4408 (316)
1/8"	6	29,0	25,0	10,2	8,1	TB35	○	●
1/4"	8	35,0	30,0	13,5	10,0	TB35	●	●
3/8"	10	38,0	35,0	17,2	12,7	TB35	●	●
1/2"	15	42,0	42,0	21,3	16,7	TB35	●	●
3/4"	20	50,4	47,0	26,9	21,5	TB35	●	●
1"	25	48,0	53,0	33,7	26,5	TB35	●	●
1.1/4"	32	59,0	71,0	42,4	35,8	TB35	●	●
1.1/2"	40	64,0	78,0	48,3	42,0	TB35	●	●
2"	50	69,0	92,0	60,3	53,3	TB35	●	●
2.1/2"	65	80,0	112,0	76,1	66,5	TB35	○	●
3"	80	88,0	126,0	88,9	78,5	TB35	○	●
4"	100	108,0	157,0	114,3	104,0	TB35	○	●

● = voorraad
○ = af fabriek

● = stock
○ = ex works

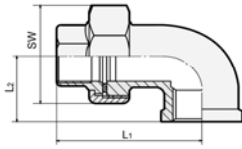

Kniekoppeling konisch BI / BI

Elbow union conical F / F

ISO 228-1G



Inch	DN	L1 mm	L2 mm	SW mm	Art. no.	4308 (304)	4408 (316)
1/8"	6	39,0	19,0	25,0	TB38	●	●
1/4"	8	46,2	21,0	30,0	TB38	●	●
3/8"	10	49,0	25,0	35,0	TB38	●	●
1/2"	15	56,0	28,0	42,0	TB38	●	●
3/4"	20	62,7	33,0	47,0	TB38	●	●
1"	25	68,0	38,0	53,0	TB38	●	●
1.1/4"	32	79,5	45,0	71,0	TB38	●	●
1.1/2"	40	88,0	50,0	78,0	TB38	●	●
2"	50	93,8	58,0	92,0	TB38	●	●

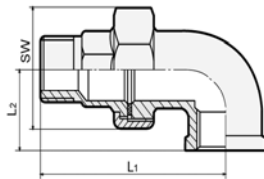

Kniekoppeling konisch BI / BU

Elbow union conical M / F

ISO 7-1R / ISO 228-1G



Inch	DN	L1 mm	L2 mm	SW mm	Art. no.	4308 (304)	4408 (316)
1/8"	6	50,7	19,0	25,0	TB39	●	●
1/4"	8	58,6	21,0	30,0	TB39	●	●
3/8"	10	61,0	25,0	35,0	TB39	●	●
1/2"	15	71,0	28,0	42,0	TB39	●	●
3/4"	20	78,7	33,0	47,0	TB39	●	●
1"	25	88,4	38,0	53,0	TB39	●	●
1.1/4"	32	102,9	45,0	71,0	TB39	●	●
1.1/2"	40	110,3	50,0	78,0	TB39	●	●
2"	50	119,4	58,0	92,0	TB39	●	●

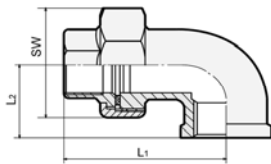

Kniekoppeling vlak BI / BI

Elbow union flat F / F

ISO 228-1G



Inch	DN	L1 mm	L2 mm	SW mm	Art. no.	4308 (304)	4408 (316)
1/8"	6	39,0	19,0	25,0	TB44	●	●
1/4"	8	46,2	21,0	30,0	TB44	●	●
3/8"	10	49,0	25,0	35,0	TB44	●	●
1/2"	15	56,0	28,0	42,0	TB44	●	●
3/4"	20	62,7	33,0	47,0	TB44	●	●
1"	25	68,0	38,0	53,0	TB44	●	●
1.1/4"	32	79,5	45,0	71,0	TB44	●	●
1.1/2"	40	88,0	50,0	78,0	TB44	●	●
2"	50	93,8	58,0	92,0	TB44	●	●

● = voorraad
○ = af fabriek

● = stock
○ = ex works

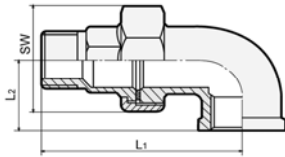

Kniekoppeling vlak BI / BU

Elbow union flat M / F

ISO 7-1R / ISO 228-1G



Inch	DN	L1 mm	L2 mm	SW mm	Art. no.	4308 (304)	4408 (316)
1/8"	6	50,7	19,0	25,0	TB45	○	○
1/4"	8	58,6	21,0	30,0	TB45	○	○
3/8"	10	61,0	25,0	35,0	TB45	○	○
1/2"	15	71,0	28,0	42,0	TB45	○	○
3/4"	20	78,7	33,0	47,0	TB45	○	○
1"	25	88,4	38,0	53,0	TB45	○	○
1.1/4"	32	102,9	45,0	71,0	TB45	○	○
1.1/2"	40	110,3	50,0	78,0	TB45	○	○
2"	50	119,4	58,0	92,0	TB45	○	○

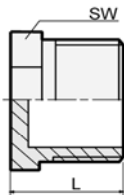

Zeskant plug konisch

Hexagon head plug tapered

ISO 8-1R

EN ISO 4144



Inch	DN	L mm	SW mm	Art. no.	4308 (304)	4408 (316)
1/8"	6	17,0	12,0	TB50	○	●
1/4"	8	17,5	16,0	TB50	●	●
3/8"	10	18,0	20,0	TB50	●	●
1/2"	15	25,0	24,0	TB50	●	●
3/4"	20	26,0	30,0	TB50	●	●
1"	25	29,0	38,0	TB50	●	●
1.1/4"	32	35,0	46,0	TB50	●	●
1.1/2"	40	38,0	52,0	TB50	●	●
2"	50	39,0	65,0	TB50	●	●
2.1/2"	65	44,0	81,0	TB50	○	●
3"	80	54,0	94,0	TB50	○	●
4"	100	55,0	119,0	TB50	○	●

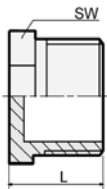

Zeskant plug cilindrisch

Hexagon head plug parallel

ISO 228

EN ISO 4144

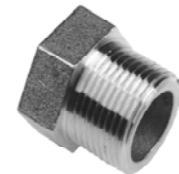

Inch	DN	L mm	SW mm	Art. no.	4308 (304)	4408 (316)
1/8"	6	17,0	12,0	TB51	○	●
1/4"	8	17,5	16,0	TB51	○	●
3/8"	10	18,0	20,0	TB51	○	●
1/2"	15	25,0	24,0	TB51	○	●
3/4"	20	26,0	30,0	TB51	○	●
1"	25	29,0	38,0	TB51	○	●
1.1/4"	32	35,0	46,0	TB51	○	●
1.1/2"	40	38,0	52,0	TB51	○	●
2"	50	39,0	65,0	TB51	○	●
2.1/2"	65	44,0	81,0	TB51	○	●
3"	80	54,0	94,0	TB51	○	●
4"	100	55,0	119,0	TB51	○	●

● = voorraad
○ = af fabriek

● = stock
○ = ex works

Vierkant plug

Square head plug

ISO 8-1R

EN ISO 4144

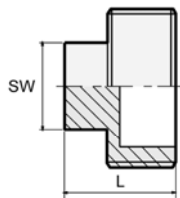

Inch	DN	L mm	SW mm	Art. no.	4308 (304)	4408 (316)
1/8"	6	16,5	6,0	TB52	●	●
1/4"	8	20,0	9,0	TB52	●	●
3/8"	10	24,0	11,0	TB52	●	●
1/2"	15	25,0	13,0	TB52	●	●
3/4"	20	27,0	16,0	TB52	●	●
1"	25	32,0	20,0	TB52	●	●
1.1/4"	32	35,0	24,0	TB52	●	●
1.1/2"	40	36,0	25,0	TB52	●	●
2"	50	38,0	32,0	TB52	●	●
2.1/2"	65	48,0	42,0	TB52	○	●
3"	80	52,0	46,0	TB52	○	●
4"	100	62,0	58,0	TB52	○	●

Ronde dop

Round cap

ISO 228-1G

EN ISO 4144

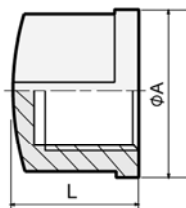

Inch	DN	ØA mm	L mm	Art. no.	4308 (304)	4408 (316)
1/8"	6	18,0	15,0	TB53	○	●
1/4"	8	21,0	17,0	TB53	●	●
3/8"	10	24,0	17,0	TB53	●	●
1/2"	15	27,3	19,0	TB53	●	●
3/4"	20	35,0	24,0	TB53	●	●
1"	25	42,0	29,0	TB53	●	●
1.1/4"	32	52,0	33,0	TB53	●	●
1.1/2"	40	57,5	34,0	TB53	●	●
2"	50	69,3	38,0	TB53	●	●
2.1/2"	65	92,0	41,0	TB53	○	●
3"	80	106,0	47,0	TB53	○	●
4"	100	134,0	53,0	TB53	○	●

● = voorraad
○ = af fabriek

● = stock
○ = ex works

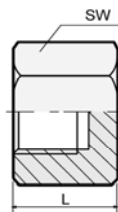

Zeskant kap

Hexagon cap

ISO 228-1G

EN ISO 4144



Inch	DN	L mm	SW mm	Art. no.	4308 (304)	4408 (316)
1/8"	6	13	15	TB54	○	●
1/4"	8	17	18	TB54	●	●
3/8"	10	19	21	TB54	●	●
1/2"	15	20	27	TB54	●	●
3/4"	20	24	30	TB54	●	●
1"	25	25	38	TB54	●	●
1.1/4"	32	28	50	TB54	●	●
1.1/2"	40	28	55	TB54	●	●
2"	50	34	70	TB54	●	●
2.1/2"	65	40	92	TB54	○	●
3"	80	45	109	TB54	○	●
4"	100	50	132	TB54	○	●

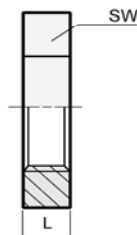

Zeskant gasmoer

Hexagon nut

ISO 228-1g



Inch	DN	L mm	SW mm	Art. no.	4308 (304)	4408 (316)
1/8"	6	6,2	14,6	TB58	○	●
1/4"	8	7,0	23,0	TB58	○	●
3/8"	10	8,0	26,0	TB58	○	●
1/2"	15	10,0	31,0	TB58	○	●
3/4"	20	11,0	37,0	TB58	○	●
1"	25	10,0	46,0	TB58	○	●
1.1/4"	32	11,0	55,0	TB58	○	●
1.1/2"	40	12,0	63,0	TB58	○	●
2"	50	13,0	76,0	TB58	○	●
2.1/2"	65	16,0	95,0	TB58	○	●
3"	80	19,0	105,0	TB58	○	●
4"	100	20,0	131,0	TB58	○	●

● = voorraad
○ = af fabriek

● = stock
○ = ex works

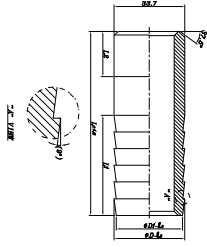

Slangnippel SLANG / BU

Hose nipple HOSE / M

ISO 8-1R



Inch	DN	D mm	D1 mm	L mm	L1 mm	L2 mm	A inch	Art. no.	304L	316L
1/8"	6	10,2	8,62	70	30,0	12	1/8"	TB56	○	●
1/4"	8	13,5	11,92	70	30,0	12	1/4"	TB56	○	●
3/8"	10	17,2	15,62	70	30,0	15	3/8"	TB56	○	●
1/2"	15	21,3	19,45	75	35,0	20	1/2"	TB56	○	●
3/4"	20	26,7	25,05	75	35,0	20	3/4"	TB56	○	●
1"	25	33,4	31,59	80	37,5	20	1"	TB56	○	●
1.1/4"	32	42,2	39,76	90	40,0	25	1.1/4"	TB56	○	●
1.1/2"	40	48,3	45,67	90	40,0	25	1.1/2"	TB56	○	●
2"	50	60,3	57,39	95	40,0	25	2"	TB56	○	●
2.1/2"	65	76,1	72,67	105	60,0	30	2.1/2"	TB56	○	●
3"	80	88,9	85,23	110	60,0	30	3"	TB56	○	●
4"	100	114,3	110,34	115	60,0	35	4"	TB56	○	●

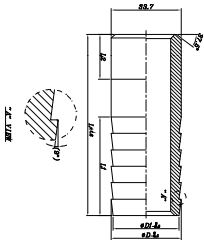

Slangnippel SLANG / LAS

Hose nipple HOSE / BW

ISO 8-1R



Inch	DN	D mm	D1 mm	L mm	L1 mm	L2 mm	Art. no.	304L	316L
1/8"	6	10,2	8,62	70	30,0	12	TB58	○	●
1/4"	8	13,5	11,92	70	30,0	12	TB58	○	●
3/8"	10	17,2	15,62	70	30,0	15	TB58	○	●
1/2"	15	21,3	19,45	75	35,0	20	TB58	○	●
3/4"	20	26,7	25,05	75	35,0	20	TB58	○	●
1"	25	33,4	31,59	80	37,5	20	TB58	○	●
1.1/4"	32	42,2	39,76	90	40,0	25	TB58	○	●
1.1/2"	40	48,3	45,67	90	40,0	25	TB58	○	●
2"	50	60,3	57,39	95	40,0	25	TB58	○	●
2.1/2"	65	76,1	72,67	105	60,0	30	TB58	○	●
3"	80	88,9	85,23	110	60,0	30	TB58	○	●
4"	100	114,3	110,34	115	60,0	35	TB58	○	●

● = voorraad
○ = af fabriek

● = stock
○ = ex works

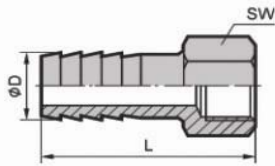

Slangpilaar BI

Hose nipple F

ISO 228-1G

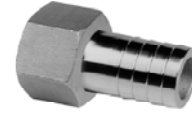

Inch	DN	ØD mm	L mm	SW mm	Art. no.	4308 (304)	4408 (316)
1/8"	6	6,50	39,0	15,00	TB58	○	●
1/4"	8	6,35	42,0	19,00	TB58	○	●
1/4"	8	7,94	42,0	19,00	TB58	○	●
3/8"	10	9,50	53,0	22,00	TB58	○	●
3/8"	10	11,00	53,0	22,00	TB58	○	●
1/2"	15	12,70	62,0	27,00	TB58	○	●
1/2"	15	14,00	62,0	27,00	TB58	○	●
3/4"	20	19,05	63,5	32,00	TB58	○	●
3/4"	20	20,50	63,5	32,00	TB58	○	●
1"	25	25,40	66,0	38,00	TB58	○	●
1"	25	27,00	66,0	38,00	TB58	○	●
1.1/4"	32	31,80	74,0	50,00	TB58	○	●
1.1/4"	32	33,00	74,0	50,00	TB58	○	●
1.1/2"	40	38,10	87,5	55,50	TB58	○	●
1.1/2"	40	39,50	87,5	55,50	TB58	○	●
2"	50	50,80	94,5	67,50	TB58	○	●
2"	50	52,00	94,5	67,50	TB58	○	●

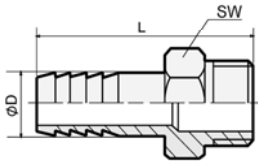

Slangpilaar BU

Hose nipple M

ISO 7-1R



Inch	DN	ØD mm	L mm	SW mm	Art. no.	4308 (304)	4408 (316)
1/8"	6	4,5	45,0	13,00	TB59	○	●
1/4"	8	6,3	47,0	16,50	TB59	○	●
1/4"	8	7,0	47,0	16,50	TB59	○	●
1/4"	8	9,0	47,0	16,50	TB59	○	●
1/4"	8	10,0	47,0	16,50	TB59	○	●
1/4"	8	11,0	47,0	16,50	TB59	○	●
1/4"	8	12,7	47,0	16,50	TB59	○	●
3/8"	10	6,4	55,0	20,00	TB59	○	●
3/8"	10	8,0	55,0	20,00	TB59	○	●
3/8"	10	9,5	55,0	20,00	TB59	○	●
3/8"	10	10,0	55,0	20,00	TB59	○	●
3/8"	10	11,0	55,0	20,00	TB59	○	●
3/8"	10	12,7	55,0	20,00	TB59	○	●
1/2"	15	6,3	64,0	23,50	TB59	○	●
1/2"	15	9,5	64,0	23,50	TB59	○	●
1/2"	15	10,0	64,0	23,50	TB59	○	●
1/2"	15	11,0	64,0	23,50	TB59	○	●
1/2"	15	12,7	64,0	23,50	TB59	○	●
1/2"	15	14,0	64,0	23,50	TB59	○	●
1/2"	15	19,0	64,0	23,50	TB59	○	●
3/4"	20	12,7	68,0	31,00	TB59	○	●
3/4"	20	19,1	68,0	31,00	TB59	○	●
3/4"	20	20,5	68,0	31,00	TB59	○	●

● = voorraad

○ = stock

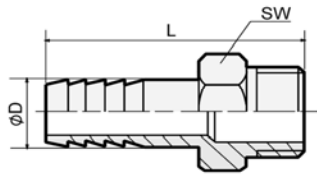

Slangpilaar BU

Hose nipple M

ISO 7-1R



Inch	DN	ØD mm	L mm	SW mm	Art. no.	4308 (304)	4408 (316)
1"	25	12,7	71,0	38,5	TB59	○	●
1"	25	19,0	71,0	38,5	TB59	○	●
1"	25	25,4	71,0	38,5	TB59	○	●
1"	25	27,0	71,0	38,5	TB59	○	●
1.1/4"	32	31,8	80,0	46,0	TB59	○	●
1.1/4"	32	33,0	80,0	46,0	TB59	○	●
1.1/2"	40	38,1	95,0	52,0	TB59	○	●
1.1/2"	40	39,5	95,0	52,0	TB59	○	●
2"	50	50,8	105,0	62,0	TB59	○	●
2"	50	52,0	105,0	62,0	TB59	○	●
2.1/2"	65	63,5	107,0	80,0	TB59	○	●
2.1/2"	65	67,0	107,0	80,0	TB59	○	●
3"	80	76,2	112,0	91,0	TB59	○	●
3"	80	80,0	112,0	91,0	TB59	○	●
4"	100	101,6	130,0	116,5	TB59	○	●
4"	100	105,0	130,0	116,5	TB59	○	●

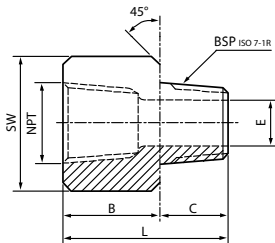

Zeskant adapter BI NPT / BU BSP

Hexagon adaptor F NPT / M BSP

ISO 228-1G / ISO 7-1R



Inch	Inch	DN	DN	B mm	C mm	E mm	L mm	SW mm	Art. no.	4308 (304)	4408 (316)
1/4"	1/4"	8	8	16,5	12,0	8,0	28,5	17,0	TB64	○	●
3/8"	3/8"	10	10	18,5	12,5	10,0	31,0	21,0	TB64	○	●
1/2"	1/2"	15	15	22,0	15,5	13,5	37,5	26,0	TB64	○	●
3/4"	3/4"	20	20	23,0	18,0	20,0	41,0	32,0	TB64	○	●
1"	1"	25	25	26,0	20,0	26,0	46,0	38,0	TB64	○	●
1.1/4"	1.1/4"	32	32	27,0	22,0	33,0	49,0	46,0	TB64	○	●
1.1/2"	1.1/2"	40	40	28,0	23,0	39,0	51,0	54,0	TB64	○	●
2"	2"	50	50	30,0	25,5	52,0	55,5	63,0	TB64	○	●

- = voorraad
- = af fabriek

- = stock
- = ex works

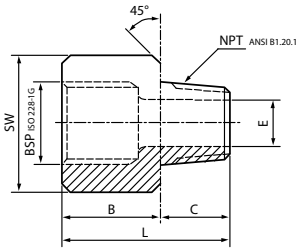

Zeskant adapter BI BSP / BU NPT

Hexagon adaptor F NPT / M BSP

ISO 228-1G / ISO 7-1R



Inch	Inch	DN	DN	B mm	C mm	E mm	L mm	SW mm	Art. no.	4308 (304)	4408 (316)
1/4"	1/4"	8	8	16,5	12	8,0	28,5	17,0	TB64	○	●
3/8"	3/8"	10	10	18,5	12,5	10,0	31	21,0	TB64	○	●
1/2"	1/2"	15	15	22,0	15,5	13,5	37,5	26,0	TB64	○	●
3/4"	3/4"	20	20	23,0	18	20,0	41	32,0	TB64	○	●
1"	1"	25	25	26,0	20	26,0	46	38,0	TB64	○	●
1.1/4"	1.1/4"	32	32	27,0	22	33,0	49	46,0	TB64	○	●
1.1/2"	1.1/2"	40	40	28,0	23	39,0	51	54,0	TB64	○	●
2"	2"	50	50	30,0	25,5	52,0	55,5	63,0	TB64	○	●

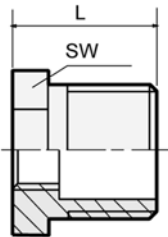

Zeskant verloopring BI / BU

Hexagon bushing M / F

ISO 7-1R / ISO 228-1G

EN ISO 4144



Inch	Inch	DN	DN	L mm	SW mm	Art. no.	4308 (304)	4408 (316)
1/4"	1/8"	8	6	15,2	16	TB60	●	●
3/8"	1/8"	10	6	16,5	18	TB60	●	●
3/8"	1/4"	10	8	16,5	18	TB60	●	●
1/2"	1/8"	15	6	21,0	26	TB60	○	●
1/2"	1/4"	15	8	21,0	26	TB60	●	●
1/2"	3/8"	15	10	21,0	26	TB60	●	●
3/4"	1/8"	20	6	24,0	30	TB60	○	●
3/4"	1/4"	20	8	24,0	30	TB60	●	●
3/4"	3/8"	20	10	24,0	30	TB60	●	●
3/4"	1/2"	20	15	24,0	30	TB60	●	●
1"	1/4"	25	8	27,0	35	TB60	○	●
1"	3/8"	25	10	27,0	35	TB60	●	●
1"	1/2"	25	15	27,0	35	TB60	●	●
1"	3/4"	25	20	27,0	35	TB60	●	●
1.1/4"	1/2"	32	15	30,0	45	TB60	○	●
1.1/4"	3/4"	32	20	30,0	45	TB60	●	●
1.1/4"	1"	32	25	30,0	45	TB60	●	●
1.1/2"	1/2"	40	15	38,0	52	TB60	○	●
1.1/2"	3/4"	40	20	38,0	52	TB60	○	●
1.1/2"	1"	40	25	38,0	52	TB60	●	●
1.1/2"	1.1/4"	40	32	38,0	52	TB60	●	●
2"	1/2"	50	15	36,0	63	TB60	○	●
2"	3/4"	50	20	36,0	63	TB60	○	●
2"	1"	50	25	36,0	63	TB60	●	●
2"	1.1/4"	50	32	36,0	63	TB60	●	●
2"	1.1/2"	50	40	36,0	63	TB60	●	●

● = voorraad
○ = af fabriek

● = stock
○ = ex works

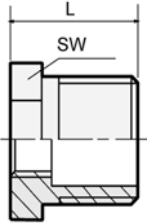

Zeskant verloopring BI / BU

Hexagon bushing M / F

ISO 7-1R / ISO 228-1G

EN ISO 4144



Inch	Inch	DN	DN	L mm	SW mm	Art. no.	4308 (304)	4408 (316)
2.1/2"	1"	65	25	45,0	81	TB60	○	●
2.1/2"	1.1/2"	65	40	45,0	81	TB60	○	●
2.1/2"	2"	65	50	45,0	81	TB60	○	●
3"	1.1/2"	80	40	47,0	95	TB60	○	●
3"	2"	80	50	47,0	95	TB60	○	●
3"	2.1/2"	80	65	47,0	95	TB60	○	●
4"	2"	100	50	52,0	120	TB60	○	●
4"	2.1/2"	100	65	52,0	120	TB60	○	●
4"	3"	100	80	52,0	120	TB60	○	●

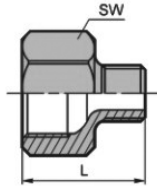

Zeskant negatieve verloopring BI / BU

Hexagon negative bushing M / F

ISO 228-1G / ISO 7-1R



Inch	Inch	DN	DN	L mm	SW mm	Art. no.	4308 (304)	4408 (316)
1/4"	1/8"	8	6	27,0	17	TB61	○	●
3/8"	1/8"	10	6	29,0	21	TB61	○	●
3/8"	1/4"	10	8	30,5	21	TB61	○	●
1/2"	1/8"	15	6	32,5	26	TB61	○	●
1/2"	1/4"	15	8	34,0	26	TB61	○	●
1/2"	3/8"	15	10	34,5	26	TB61	○	●
3/4"	1/8"	20	6	33,5	32	TB61	○	●
3/4"	1/4"	20	8	35,0	32	TB61	○	●
3/4"	3/8"	20	10	35,5	32	TB61	○	●
3/4"	1/2"	20	15	38,5	32	TB61	○	●
1"	1/8"	25	6	36,5	38	TB61	○	●
1"	1/4"	25	8	38,0	38	TB61	○	●
1"	3/8"	25	10	38,5	38	TB61	○	●
1"	1/2"	25	15	41,0	38	TB61	○	●
1"	3/4"	25	20	44,0	38	TB61	○	●
1.1/4"	1/4"	32	8	40,0	50	TB61	○	●
1.1/4"	3/8"	32	10	40,0	50	TB61	○	●
1.1/4"	1/2"	32	15	42,5	50	TB61	○	●
1.1/4"	3/4"	32	20	45,0	50	TB61	○	●
1.1/4"	1"	32	25	47,0	50	TB61	○	●
1.1/2"	1/4"	40	8	41,0	54	TB61	○	●
1.1/2"	3/8"	40	10	42,0	54	TB61	○	●
1.1/2"	1/2"	40	15	45,0	54	TB61	○	●
1.1/2"	3/4"	40	20	46,0	54	TB61	○	●
1.1/2"	1"	40	25	48,0	54	TB61	○	●
1.1/2"	1.1/4"	40	32	50,0	54	TB61	○	●

● = voorraad
○ = af fabriek

● = stock
○ = ex works

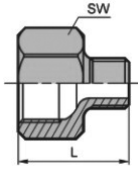

Zeskant negatieve verloopring BI / BU

Hexagon negative bushing M / F

ISO 228-1G / ISO 7-1R



Inch	Inch	DN	DN	L mm	SW mm	Art. no.	4308 (304)	4408 (316)
2"	1/4"	50	8	44,5	68	TB61	○	●
2"	3/8"	50	10	31,0	68	TB61	○	●
2"	1/2"	50	15	49,0	68	TB61	○	●
2"	3/4"	50	20	51,0	68	TB61	○	●
2"	1"	50	25	51,0	68	TB61	○	●
2"	1.1/4"	50	32	53,0	68	TB61	○	●
2"	1,1/2"	50	40	54,0	68	TB61	○	●

Zeskant verloopnippel BU / BU

Hexagon red nipple M / M

ISO 7-1R

EN ISO 4144

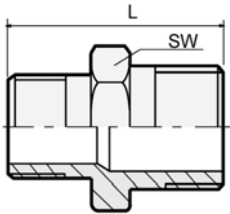

Inch	Inch	DN	DN	L mm	SW mm	Art. no.	4308 (304)	4408 (316)
1/4"	1/8"	8	6	34,0	18,0	TB62	●	●
3/8"	1/8"	10	6	35,0	21,0	TB62	○	●
3/8"	1/4"	10	8	34,0	21,0	TB62	●	●
1/2"	1/8"	15	6	34,0	26,0	TB62	○	●
1/2"	1/4"	15	8	34,0	26,0	TB62	●	●
1/2"	3/8"	15	10	41,0	26,0	TB62	●	●
3/4"	1/8"	20	6	37,0	30,0	TB62	○	●
3/4"	1/4"	20	8	37,0	30,0	TB62	●	●
3/4"	3/8"	20	10	37,0	30,0	TB62	●	●
3/4"	1/2"	20	15	45,0	30,0	TB62	●	●
1"	1/8"	25	6	39,0	35,0	TB62	○	●
1"	1/4"	25	8	39,0	35,0	TB62	○	●
1"	3/8"	25	10	40,0	35,0	TB62	●	●
1"	1/2"	25	15	43,2	35,0	TB62	●	●
1"	3/4"	25	20	50,0	37,0	TB62	●	●
1.1/4"	1/2"	32	15	48,0	46,0	TB62	○	●
1.1/4"	3/4"	32	20	52,0	46,0	TB62	○	●
1.1/4"	1"	32	25	54,0	46,0	TB62	●	●
1.1/2"	1/2"	40	15	49,0	50,0	TB62	○	●
1.1/2"	3/4"	40	20	53,0	50,0	TB62	○	●
1.1/2"	1"	40	25	53,0	50,0	TB62	●	●
1.1/2"	1.1/4"	40	32	59,0	50,0	TB62	●	●
2"	1/2"	50	15	52,0	63,0	TB62	○	●
2"	3/4"	50	20	56,0	63,0	TB62	○	●
2"	1"	50	25	57,0	63,0	TB62	●	●
2"	1.1/4"	50	32	58,0	63,0	TB62	●	●
2"	1,1/2"	50	40	65,4	64,0	TB62	●	●
2.1/2"	1"	65	25	63,0	80,0	TB62	○	●
2.1/2"	1.1/2"	65	40	66,0	80,0	TB62	○	●
2.1/2"	2"	65	50	77,0	76,3	TB62	○	●

● = voorraad

● = stock

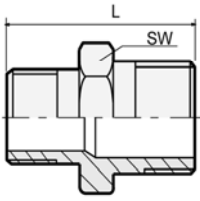

Zeskant verloopnippel BU / BU

Hexagon red nipple M / M

ISO 7-1R

EN ISO 4144



Inch	Inch	DN	DN	L mm	SW mm	Art. no.	4308 (304)	4408 (316)
3"	1.1/2"	80	40	72,0	95,0	TB62	○	●
3"	2"	80	50	74,0	95,0	TB62	○	●
3"	2.1/2"	80	65	84,0	95,0	TB62	○	●
4"	2"	100	50	82,0	125,0	TB62	○	●
4"	2.1/2"	100	65	82,0	125,0	TB62	○	●
4"	3"	100	80	94,0	117,4	TB62	○	●

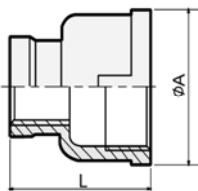

Verloopsok BI / BI

Reducing socket F / F

ISO 228-1G

EN ISO 4144



Inch	Inch	DN	DN	L mm	ØA	Art. no.	4308 (304)	4408 (316)
1/4"	1/8"	8	6	26,0	21,5	TB63	○	●
3/8"	1/8"	10	6	28,3	22,6	TB63	○	●
3/8"	1/4"	10	8	29,0	26,0	TB63	○	●
1/2"	1/8"	15	6	34,0	29,0	TB63	○	●
1/2"	1/4"	15	8	34,0	29,0	TB63	○	●
1/2"	3/8"	15	10	34,0	29,0	TB63	○	●
3/4"	1/4"	20	8	38,0	36,7	TB63	○	●
3/4"	3/8"	20	10	38,0	36,7	TB63	○	●
3/4"	1/2"	20	15	37,0	37,0	TB63	○	●
1"	1/4"	25	8	42,0	43,0	TB63	○	●
1"	3/8"	25	10	42,0	43,0	TB63	○	●
1"	1/2"	25	15	42,0	43,0	TB63	○	●
1"	3/4"	25	20	42,0	43,0	TB63	○	●
1.1/4"	1/2"	32	15	48,0	52,0	TB63	○	●
1.1/4"	3/4"	32	20	48,0	52,0	TB63	○	●
1.1/4"	1"	32	25	52,0	52,5	TB63	○	●
1.1/2"	1/2"	40	15	51,0	59,0	TB63	○	●
1.1/2"	3/4"	40	20	49,0	59,0	TB63	○	●
1.1/2"	1"	40	25	53,0	59,0	TB63	○	●
1.1/2"	1.1/4"	40	32	53,0	59,0	TB63	○	●
2"	1/2"	50	15	50,5	72,0	TB63	○	●
2"	3/4"	50	20	50,5	72,0	TB63	○	●
2"	1"	50	25	56,0	72,0	TB63	○	●
2"	1.1/4"	50	32	56,0	72,0	TB63	○	●
2"	1.1/2"	50	40	57,0	72,0	TB63	○	●
2.1/2"	1"	65	25	60,0	87,0	TB63	○	●
2.1/2"	1.1/2"	65	40	60,0	85,0	TB63	○	●
2.1/2"	2"	65	50	61,0	85,0	TB63	○	●
3"	1.1/2"	80	40	62,0	100,0	TB63	○	●
3"	2"	80	50	62,0	100,0	TB63	○	●
3"	2.1/2"	80	65	62,0	100,0	TB63	○	●
4"	2"	100	50	65,0	129,0	TB63	○	●
4"	2.1/2"	100	65	65,0	128,0	TB63	○	●
4"	3"	100	80	65,0	128,0	TB63	○	●

● = voorraad
○ = af fabriek

● = stock
○ = ex works

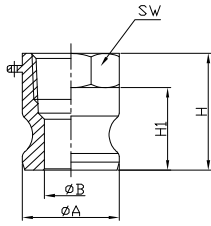

A Adapter binnendraad

A Adapter female thread

ISO 228-1G

MIL-C-27487 ASTM-F1122



Inch	DN	ØA mm	ØB mm	H mm	H1 mm	SW	Art. no.	CF8 (304)	316 (316)
1/2"	15	24,3	14,4	38,0	25,0	25,5	TQ10	○	●
3/4"	20	32,0	21,2	38,0	28,0	33,0	TQ10	○	●
1"	25	36,7	23,8	46,5	33,5	41,0	TQ10	○	●
1.1/4"	32	45,5	28,6	55,0	40,0	48,0	TQ10	○	●
1.1/2"	40	53,4	36,0	58,5	42,5	56,0	TQ10	○	●
2"	50	63,0	45,5	62,3	47,5	67,5	TQ10	○	●
2.1/2"	65	75,7	56,4	68,0	50,0	83,0	TQ10	○	●
3"	80	91,5	73,5	70,0	51,0	96,5	TQ10	○	●
4"	100	119,5	100,0	76,0	53,0	124,0	TQ10	○	●

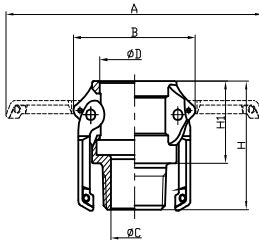

B Koppelstuk buitendraad

B Coupler male thread

ISO 7-1R

MIL-C-27487 ASTM-F1122



Inch	DN	A mm	B mm	ØC mm	ØD mm	H1 mm	H mm	Art. no.	CF8 (304)	316 (316)
1/2"	15	107	48,7	14,8	25,1	31,0	48	TQ11	○	●
3/4"	20	115	57,0	21,2	32,4	30,0	49	TQ11	○	●
1"	25	137	65,6	25,0	37,3	39,0	61	TQ11	○	●
1.1/4"	32	183	77,0	28,0	46	46,0	68	TQ11	○	●
1.1/2"	40	191	85,0	39,0	54	48,0	70,5	TQ11	○	●
2"	50	201	96,0	50,0	63,7	53,0	78,7	TQ11	○	●
2.1/2"	65	213	110,4	58,0	76,5	58,0	86	TQ11	○	●
3"	80	267	133,0	73,2	92,2	58,0	89	TQ11	○	●
4"	100	296	166,0	97,0	120,2	63,0	97	TQ11	○	●

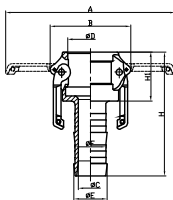

C Koppelstuk slangtule

C Coupler hose shank

MIL-C-27487 ASTM-F1122



Inch	DN	A mm	B mm	ØC mm	ØD mm	ØE mm	ØF mm	H1 mm	H mm	Art. no.	CF8 (304)	316 (316)
1/2"	15	107	48,7	8,0	25,1	15,0	13	31	72,0	TQ12	○	●
3/4"	20	115	57,0	13,6	32,4	20,7	19,4	30	80,0	TQ12	○	●
1"	25	137	65,6	20,0	37,3	27,0	25,8	39	99,0	TQ12	○	●
1.1/4"	32	183	77,0	25,8	46	33,9	32,9	46	110,0	TQ12	○	●
1.1/2"	40	191	85,0	31,3	54	40,5	38,6	48	114,0	TQ12	○	●
2"	50	201	96,0	43,8	63,7	52,0	51	53	129,0	TQ12	○	●
2.1/2"	65	213	110,4	55,7	76,5	66,8	-	58	151,0	TQ12	○	●
3"	80	267	133,0	68,0	92,2	79,0	-	58	160,0	TQ12	○	●
4"	100	296	166,0	92,0	120,2	104,8	-	63	176,0	TQ12	○	●

● = voorraad
○ = af fabriek

● = stock
○ = ex works

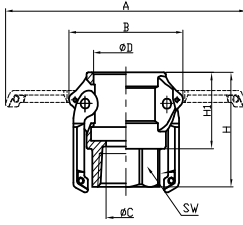

D Koppelstuk binnendraad

D Coupler female thread

ISO 228-1G

MIL-C-27487 ASTM-F1122



Inch	DN	A mm	B mm	ØC mm	ØD mm	H1 mm	H mm	SW	Art. no.	CF8 (304)	316 (316)
1/2"	15	107	48,7	17,4	25,1	31,0	49	25,5	TQ13	○	●
3/4"	20	115	57,0	20,0	32,4	30,0	50	32,0	TQ13	○	●
1"	25	137	65,6	26,0	37,3	39,0	60	38,5	TQ13	○	●
1.1/4"	32	183	77,0	34,5	46	46,0	66	48,0	TQ13	○	●
1.1/2"	40	191	85,0	40,0	54	48,0	70,5	55,5	TQ13	○	●
2"	50	201	96,0	50,0	63,7	53,0	76	67,0	TQ13	○	●
2.1/2"	65	213	110,4	61,0	76,5	58,0	82	82,0	TQ13	○	●
3"	80	267	133,0	75,0	92,2	58,0	86	94,2	TQ13	○	●
4"	100	296	166,0	100,0	120,2	63,0	92	127,0	TQ13	○	●

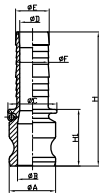

E Adapter slangtule

E Adapter hose shank

MIL-C-27487 ASTM-F1122



Inch	DN	ØA mm	ØB mm	ØC mm	ØD mm	ØE mm	ØF mm	H1	H mm	Art. no.	CF8 (304)	316 (316)
1/2"	15	24,3	14,4	30,0	8,0	15,0	13	35	76,0	TQ14	○	●
3/4"	20	32,0	21,2	33,0	13,6	20,7	19,4	37	87,0	TQ14	○	●
1"	25	36,7	23,8	39,0	20,0	27,0	25,8	44	104,0	TQ14	○	●
1.1/4"	32	45,5	28,6	48,0	25,8	33,9	32,9	51	115,0	TQ14	○	●
1.1/2"	40	53,4	36,0	56,0	31,3	40,5	38,6	52	118,0	TQ14	○	●
2"	50	63,0	45,5	66,0	43,8	52,0	51	56	132,0	TQ14	○	●
2.1/2"	65	75,7	55,7	80,0	55,7	66,8	-	64	156,0	TQ14	○	●
3"	80	91,5	73,2	101,0	68,0	79,0	-	66	169,0	TQ14	○	●
4"	100	119,5	91,0	130,0	92,0	104,8	-	68	180,0	TQ14	○	●

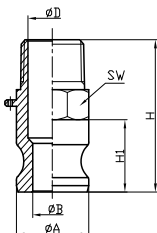

F Adapter buitendraad

F Adapter male thread

ISO 7-1R

MIL-C-27487 ASTM-F1122



Inch	DN	ØA mm	ØB mm	ØD mm	H1 mm	H mm	SW	Art. no.	CF8 (304)	316 (316)
1/2"	15	24,3	14,4	14,4	25	56	25,5	TQ15	○	●
3/4"	20	32,0	21,2	21,2	28	56	33,0	TQ15	○	●
1"	25	36,7	23,8	23,8	33,5	69	41,0	TQ15	○	●
1.1/4"	32	45,5	28,6	33,0	40	77	48,0	TQ15	○	●
1.1/2"	40	53,4	36,0	39,6	42,5	80	56,0	TQ15	○	●
2"	50	63,0	45,5	50,0	47,5	89	65,0	TQ15	○	●
2.1/2"	65	75,7	56,4	56,4	50	98	82,5	TQ15	○	●
3"	80	91,5	73,2	77,5	51	101	95,8	TQ15	○	●
4"	100	119,5	100,0	100,0	53	114	124,0	TQ15	○	●

● = voorraad
○ = af fabriek

● = stock
○ = ex works

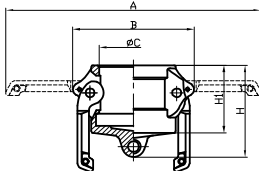

DC Stofkap

DC Dust cap

MIL-C-27487 ASTM-F1122



Inch	DN	A mm	B mm	ØC mm	H1 mm	H mm	Art. no.	CF8 (304)	316 (316)
1/2"	15	107,0	48,7	25,1	30	40	TQ16	○	●
3/4"	20	115,0	57,0	32,4	30	40	TQ16	○	●
1"	25	137,0	65,6	37,3	39	53	TQ16	○	●
1.1/4"	32	183,0	77,0	46,0	46	61	TQ16	○	●
1.1/2"	40	191,0	85,0	54,0	48	64	TQ16	○	●
2"	50	201,0	96,0	63,7	53	68	TQ16	○	●
2.1/2"	65	213,0	110,4	76,5	58	82	TQ16	○	●
3"	80	267,0	133,0	92,2	58	83	TQ16	○	●
4"	100	296,0	166,0	120,2	63	93	TQ16	○	●

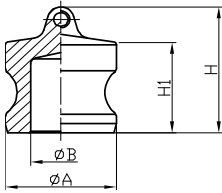

DP Stofplug

DP Dust Plug

MIL-C-27487 ASTM-F1122



Inch	DN	ØA mm	ØB mm	H1	H	Art. no.	CF8 (304)	316 (316)
1/2"	15	24,3	14,4	26,0	35,0	TQ17	○	●
3/4"	20	32,0	21,2	25,0	36,0	TQ17	○	●
1"	25	36,7	23,8	30,5	44,5	TQ17	○	●
1.1/4"	32	45,5	28,6	37,7	52,7	TQ17	○	●
1.1/2"	40	53,4	36,0	38,7	53,7	TQ17	○	●
2"	50	63,0	45,5	42,8	57,8	TQ17	○	●
2.1/2"	65	75,7	56,4	46,0	71,0	TQ17	○	●
3"	80	91,5	73,2	46,0	76,0	TQ17	○	●
4"	100	119,5	100,0	50,0	120,0	TQ17	○	●

● = voorraad
○ = af fabriek

● = stock
○ = ex works