

## Muff, gjuten

### Socket

ISO 228-1G

EN ISO 4144

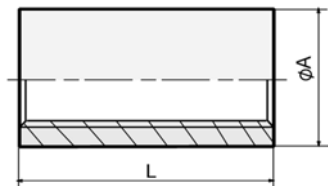

Inch	DN	L mm	ØA mm	Art. no.	4308 (304)	4408 (316)
1/8"	6	18,0	16,0	TB01	○	●
1/4"	8	26,0	19,5	TB01	●	●
3/8"	10	27,0	22,3	TB01	●	●
1/2"	15	34,0	27,7	TB01	●	●
3/4"	20	36,0	33,6	TB01	●	●
1"	25	43,0	39,5	TB01	●	●
1.1/4"	32	48,0	48,3	TB01	●	●
1.1/2"	40	48,0	54,6	TB01	●	●
2"	50	56,0	66,3	TB01	●	●
2.1/2"	65	65,0	82,0	TB01	○	○
3"	80	71,0	100,5	TB01	○	○
4"	100	83,0	122,0	TB01	○	○

## Muff, hel

### Socket from pipe

ISO 228-1G

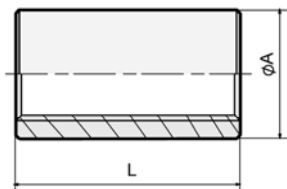

Inch	DN	L mm	ØA mm	Art. no.	304L	316L
1/8"	6	18	14	TB03	○	●
1/4"	8	25	18,52	TB03	●	●
3/8"	10	26	21,3	TB03	●	●
1/2"	15	34	26,4	TB03	●	●
3/4"	20	36	31,8	TB03	●	●
1"	25	43	39,5	TB03	●	●
1.1/4"	32	48	48,3	TB03	●	●
1.1/2"	40	48	54,5	TB03	●	●
2"	50	56	66,3	TB03	●	●
2.1/2"	65	65	82	TB03	○	●
3"	80	81	95	TB03	○	●
4"	100	83	122	TB03	○	●

● = lager  
○ = ex works

● = stock  
○ = ex works

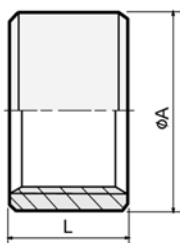

## Muff gjuten, halv

Half socket

ISO 228-1G

EN ISO 4144



Inch	DN	L mm	ØA mm	Art. no.	4308 (304)	4408 (316)
1/8"	6	18	14	TB02	○	●
1/4"	8	25	18,52	TB02	●	●
3/8"	10	26	21,3	TB02	●	●
1/2"	15	34	26,4	TB02	●	●
3/4"	20	36	31,8	TB02	●	●
1"	25	43	39,5	TB02	●	●
1.1/4"	32	48	48,3	TB02	●	●
1.1/2"	40	48	54,5	TB02	●	●
2"	50	56	66,3	TB02	●	●
2.1/2"	65	65	82	TB02	○	○
3"	80	81	95	TB02	○	○
4"	100	83	122	TB02	○	○

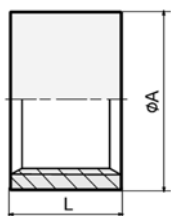

## Muff, halv från rör

Half socket from pipe

ISO 228-1G



Inch	DN	L mm	ØA mm	Art. no.	304L	316L
1/8"	6	10	14	TB04	○	●
1/4"	8	11	18,52	TB04	●	●
3/8"	10	12	21,3	TB04	●	●
1/2"	15	15	26,4	TB04	●	●
3/4"	20	18	31,8	TB04	●	●
1"	25	20	39,5	TB04	●	●
1.1/4"	32	22	48,3	TB04	●	●
1.1/2"	40	22	54,5	TB04	●	●
2"	50	26	66,3	TB04	●	●
2.1/2"	65	31	82	TB04	○	●
3"	80	34	95	TB04	○	●
4"	100	39	122	TB04	○	●

● = lager  
○ = ex works

● = stock  
○ = ex works

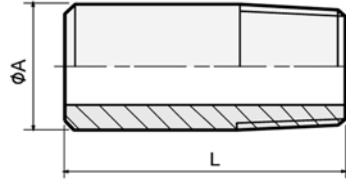

## Svetsnippel från rör

Welding nipple from pipe

ISO 7-1R



Inch	1/8"	1/4"	3/8"	1/2"	3/4"	1"	1.1/4"	1.1/2"	2"	2.1/2"	3"	4"	5"	6"
DN	6	8	10	15	20	25	32	40	50	65	80	100	125	150
ØA	10	13,5	17,2	21,3	26,9	33,7	42,4	48,3	60,3	76	89	114	140	168
tp	316L	316L	316L	316L	316L	316L	316L	316L	316L	316L	316L	316L	316L	316L

L = 30mm	●	● + 304L	● + 304L	●	○	○	○	○						
L = 35mm	○	○	○	● + 304L	○	○	○	○						
L = 40mm	○	●	●	●	● + 304L	● + 304L	○	○	○					
L = 50mm	○	●	●	●	●	●	● + 304L	● + 304L	● + 304L	○				
L = 60mm	○	●	●	●	●	●	●	●	●	●	○			
L = 70mm	○	●	●	●	●	●	●	●	●	○	○	○		
L = 80mm	○	●	●	●	●	●	●	●	●	○	○	●	○	
L = 90mm	○	●	●	●	●	●	●	●	●	○	○	○	○	○
L = 100mm	○	●	●	●	●	●	●	●	●	○	○	○	○	○
L = 110mm	○	●	●	●	●	●	●	●	●	○	○	○	○	○
L = 120mm	○	●	●	●	●	●	●	●	●	○	○	○	○	○
L = 130mm	○	●	●	●	●	●	●	●	●	○	○	○	○	○
L = 140mm	○	●	●	●	●	●	●	●	●	○	○	○	○	○
L = 150mm	○	●	●	●	●	●	●	●	●	○	○	○	○	○
L = 160mm	○	●	●	●	●	●	●	●	●	○	○	○	○	○
L = 170mm	○	●	●	●	●	●	●	●	●	○	○	○	○	○
L = 180mm	○	●	●	●	●	●	●	●	●	○	○	○	○	○
L = 190mm	○	●	●	●	●	●	●	●	●	○	○	○	○	○
L = 200mm	○	●	●	●	●	●	●	●	●	○	○	○	○	○
L = 210mm	○	●	●	●	●	●	●	●	●	○	○	○	○	○
L = 220mm	○	●	●	●	●	●	●	●	●	○	○	○	○	○
L = 230mm	○	●	●	●	●	●	●	●	●	○	○	○	○	○
L = 240mm	○	●	●	●	●	●	●	●	●	○	○	○	○	○
L = 250mm	○	●	●	●	●	●	●	●	●	○	○	○	○	○
L = 260mm	○	●	●	●	●	●	●	●	●	○	○	○	○	○
L = 270mm	○	●	●	●	●	●	●	●	●	○	○	○	○	○
L = 280mm	○	●	●	●	●	●	●	●	●	○	○	○	○	○
L = 290mm	○	●	●	●	●	●	●	●	●	○	○	○	○	○
L = 300mm	○	●	●	●	●	●	●	●	●	○	○	○	○	○

● = lager  
○ = ex works

● = stock  
○ = ex works

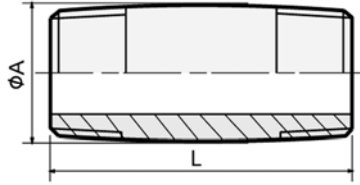

## Nippelrör

Barrel nipple from tube

ISO 7-1R



inch	1/8"	1/4"	3/8"	1/2"	3/4"	1"	1.1/4"	1.1/2"	2"	2.1/2"	3"	4"	5"	6"
DN	6	8	10	15	20	25	32	40	50	65	80	100	125	150
ØA	10,2	13,5	17,2	21,3	26,9	33,7	42,4	48,3	60,3	76	89	114	140	168
tp	316L	316L	316L	316L	316L	316L	316L	316L	316L	316L	316L	316L	316L	316L
L = 30mm	●	●	○	●	○	○								
L = 35mm	○	○	○	○	○	○								
L = 40mm	●	●+304L	●+304L	●	●	●	○	○						
L = 50mm	○	●	●	●	●	●	●	●	○					
L = 60mm	○	●	●	●+304L	●+304L	●+304L	●	●	●	○				
L = 70mm	○	●	●	●	●	●	●	●	●	○	○			
L = 80mm	○	●	●	●	●	●	●+304L	●+304L	●	○	○	○		
L = 90mm	○	●	●	●	●	●	●	●	●	○	○	○		
L = 100mm	○	●	●	●	●	●	●	●	●+304L	●	○	○		
L = 110mm	○	●	●	●	●	●	●	●	●	○	○	○		
L = 120mm	○	●	●	●	●	●	●	●	●	○	●	●	○	○
L = 130mm	○	●	●	●	●	●	●	●	●	○	○	○	○	○
L = 140mm	○	●	●	●	●	●	●	●	●	○	○	○	○	○
L = 150mm	○	●	●	●	●	●	●	●	●	○	○	○	○	○
L = 160mm	○	●	●	●	●	●	●	●	●	○	○	○	○	○
L = 170mm	○	●	●	●	●	●	●	●	●	○	○	○	○	○
L = 180mm	○	●	●	●	●	●	●	●	●	○	○	○	○	○
L = 190mm	○	●	●	●	●	●	●	●	●	○	○	○	○	○
L = 200mm	○	●	●	●	●	●	●	●	●	○	○	○	○	○
L = 210mm	○	●	●	●	●	●	●	●	●	○	○	○	○	○
L = 220mm	○	●	●	●	●	●	●	●	●	○	○	○	○	○
L = 230mm	○	●	●	●	●	●	●	●	●	○	○	○	○	○
L = 240mm	○	●	●	●	●	●	●	●	●	○	○	○	○	○
L = 250mm	○	●	●	●	●	●	●	●	●	○	○	○	○	○
L = 260mm	○	●	●	●	●	●	●	●	●	○	○	○	○	○
L = 270mm	○	●	●	●	●	●	●	●	●	○	○	○	○	○
L = 280mm	○	●	●	●	●	●	●	●	●	○	○	○	○	○
L = 290mm	○	●	●	●	●	●	●	●	●	○	○	○	○	○
L = 300mm	○	●	●	●	●	●	●	●	●	○	○	○	○	○

● = lager  
○ = ex works

● = stock  
○ = ex works

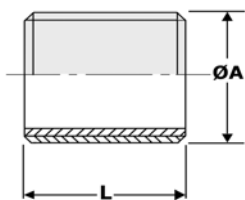

## Nippel, cylindrisk gänga

Parallel nipple from tube

ISO 228



Inch	DN	L mm	ØA mm	Art. no.	304L	316L
1/8"	6	16	10,2	TB08	○	●
1/4"	8	18	13,5	TB08	○	●
3/8"	10	22	18,2	TB08	○	●
1/2"	15	25	21,3	TB08	○	●
3/4"	20	30	26,9	TB08	○	●
1"	25	35	33,8	TB08	○	●
1.1/4"	32	38	42,4	TB08	○	●
1.1/2"	40	38	48,3	TB08	○	●
2"	50	45	60,3	TB08	○	●
2.1/2"	65	55	86,1	TB08	○	○
3"	80	60	88,9	TB08	○	○
4"	100	80	114,3	TB08	○	○

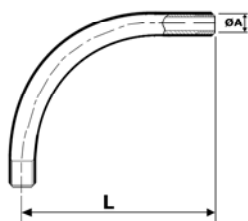

## Gängböj U/U

Bend M / M from tube

ISO 228



Inch	DN	L mm	ØA mm	Art. no.	304L	316L
1/8"	6	50	10,2	TB10	○	●
1/4"	8	60	13,5	TB10	○	●
3/8"	10	80	18,2	TB10	○	●
1/2"	15	80	21,3	TB10	○	●
3/4"	20	100	26,9	TB10	○	●
1"	25	120	33,8	TB10	○	●
1.1/4"	32	140	42,4	TB10	○	●
1.1/2"	40	160	48,3	TB10	○	●
2"	50	190	60,3	TB10	○	●
2.1/2"	65	240	86,1	TB10	○	○
3"	80	290	88,9	TB10	○	○

● = lager  
○ = ex works

● = stock  
○ = ex works

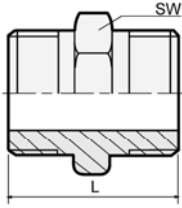

## Sexkantnippel

Hexagon nipple

ISO 8-1R

EN ISO 4144



Inch	DN	L mm	SW mm	Art. no.	4308 (304)	4408 (316)
1/8"	6	23,6	12,0	TB11	○	●
1/4"	8	27,8	16,0	TB11	●	●
3/8"	10	28,0	19,0	TB11	●	●
1/2"	15	34,0	21,6	TB11	●	●
3/4"	20	40,0	30,0	TB11	●	●
1"	25	46,0	36,0	TB11	●	●
1.1/4"	32	52,5	46,0	TB11	●	●
1.1/2"	40	54,0	50,0	TB11	●	●
2"	50	62,0	64,5	TB11	●	●
2.1/2"	65	70,0	79,5	TB11	○	●
3"	80	78,4	90,0	TB11	○	●
4"	100	94,0	120,0	TB11	○	●

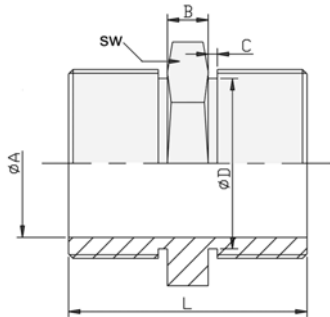

## Sexkantnippel, cylindrisk gänga

Hexagon nipple parallel thread

ISO 228

EN ISO 4144



Inch	DN	L mm	SW mm	A mm	B mm	ØC mm	ØD mm	Art. no.	4308 (304)	4408 (316)
1/8"	6	23,6	12,0	4,3	8,5	2,0	8,5	TB12	○	●
1/4"	8	27,8	16,0	7,0	11,4	3,0	11,4	TB12	○	●
3/8"	10	26	19,0	9,4	14,0	3,0	14,0	TB12	○	●
1/2"	15	35	21,6	13,7	18,0	4,0	18,0	TB12	○	●
3/4"	20	40	30,0	19,0	24,0	4,0	24,0	TB12	○	●
1"	25	46	36,0	25,5	30,0	4,0	30,0	TB12	○	●
1.1/4"	32	52,5	46,0	32,0	39,0	4,0	39,0	TB12	○	●
1.1/2"	40	54	50,0	38,5	45,0	4,0	45,0	TB12	○	●
2"	50	62	64,5	50,2	56,5	4,0	56,5	TB12	○	●
2.1/2"	65	70	79,5	63,8	72,0	4,0	72,0	TB12	○	○
3"	80	78,4	90,0	77,0	85,0	4,0	85,0	TB12	○	○
4"	100	94	120,0	102,0	110,0	4,0	110,0	TB12	○	○

● = lager  
○ = ex works

● = stock  
○ = ex works

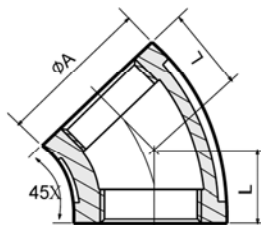

## Vinkel 45° I/I

Elbow 45° F / F

ISO 228-1G

EN ISO 4144



Inch	DN	ØA mm	L mm	Art. no.	4308 (304)	4408 (316)
1/8"	6	18,0	18,0	TB13	○	●
1/4"	8	21,0	19,4	TB13	○	●
3/8"	10	25,0	20,0	TB13	○	●
1/2"	15	29,5	22,0	TB13	○	●
3/4"	20	35,6	25,0	TB13	○	●
1"	25	43,0	28,0	TB13	○	●
1.1/4"	32	52,4	33,0	TB13	○	●
1.1/2"	40	58,0	36,0	TB13	○	●
2"	50	72,0	43,0	TB13	○	●
2.1/2"	65	87,0	50,0	TB13	○	●
3"	80	100,0	55,0	TB13	○	●
4"	100	125,5	64,0	TB13	○	●

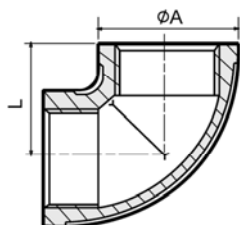

## Vinkel 90° I/I

Elbow 90° F / F

ISO 228-1G

EN ISO 4144



Inch	DN	ØA mm	L mm	Art. no.	4308 (304)	4408 (316)
1/8"	6	17,0	19,0	TB14	○	●
1/4"	8	21,3	21,0	TB14	●	●
3/8"	10	23,5	21,3	TB14	●	●
1/2"	15	29,0	27,0	TB14	●	●
3/4"	20	36,0	33,0	TB14	●	●
1"	25	43,0	38,0	TB14	●	●
1.1/4"	32	52,0	45,0	TB14	●	●
1.1/2"	40	58,5	50,0	TB14	●	●
2"	50	71,5	57,0	TB14	●	●
2.1/2"	65	87,0	69,7	TB14	○	●
3"	80	99,5	77,0	TB14	○	●
4"	100	126,0	98,2	TB14	○	●

● = lager  
○ = ex works

● = stock  
○ = ex works

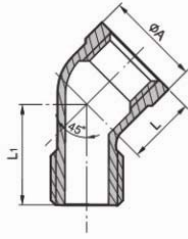

### Vinkel 45° I/U

Elbow 90° M / F

ISO 8-1R / ISO 228-1G

EN ISO 4144



Inch	DN	ØA mm	L mm	L1 mm	Art. no.	4308 (304)	4408 (316)
1/8"	6	17	16	21	TB19	○	●
1/4"	8	21	17	23	TB19	○	●
3/8"	10	25	19	27	TB19	○	●
1/2"	15	29	21	31	TB19	○	●
3/4"	20	35	25	36	TB19	○	●
1"	25	43	29	42	TB19	○	●
1.1/4"	32	52	34	49	TB19	○	●
1.1/2"	40	58	37	51	TB19	○	●
2"	50	71	42	59	TB19	○	●
2.1/2"	65	88	49	71	TB19	○	●
3"	80	101	54	79	TB19	○	●
4"	100	129	65	96	TB19	○	●

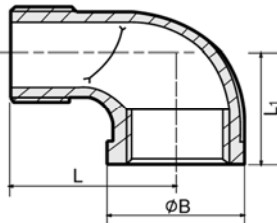

### Vinkel 90° I/U

Elbow 90° M / F

ISO 8-1R / ISO 228-1G

EN ISO 4144



Inch	DN	ØB mm	L mm	L1 mm	Art. no.	4308 (304)	4408 (316)
1/8"	6	17,0	25,0	19,0	TB20	○	●
1/4"	8	21,0	28,3	21,0	TB20	●	●
3/8"	10	25,0	32,0	25,0	TB20	●	●
1/2"	15	29,0	42,0	28,0	TB20	●	●
3/4"	20	35,0	50,5	33,0	TB20	●	●
1"	25	43,0	52,0	39,0	TB20	●	●
1.1/4"	32	52,0	60,0	45,0	TB20	●	●
1.1/2"	40	58,8	65,0	50,0	TB20	●	●
2"	50	71,7	74,0	58,0	TB20	●	●
2.1/2"	65	88,2	99,0	69,0	TB20	○	●
3"	80	100,0	114,5	78,0	TB20	○	●
4"	100	126,5	146,5	97,0	TB20	○	●

● = lager  
○ = ex works

● = stock  
○ = ex works

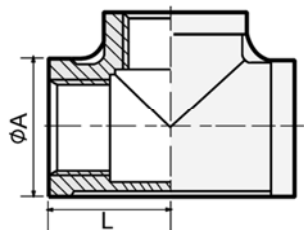

### T-rör

Equal tee

ISO 228-1G

EN ISO 4144



Inch	DN	ØA mm	L mm	Art. no.	4308 (304)	4408 (316)
1/8"	6	17,0	19,0	TB22	○	●
1/4"	8	21,3	21,0	TB22	●	●
3/8"	10	23,5	23,6	TB22	●	●
1/2"	15	30,0	28,0	TB22	●	●
3/4"	20	35,0	33,0	TB22	●	●
1"	25	43,0	38,0	TB22	●	●
1.1/4"	32	52,0	45,0	TB22	●	●
1.1/2"	40	58,5	50,0	TB22	●	●
2"	50	71,5	58,0	TB22	●	●
2.1/2"	65	87,0	70,0	TB22	○	●
3"	80	100,0	78,5	TB22	○	●
4"	100	125,0	97,0	TB22	○	●

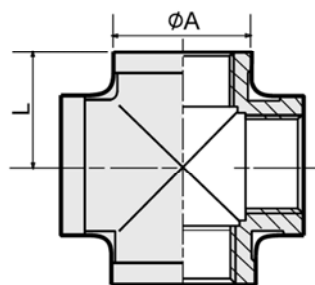

### Korsrör

Gross

ISO 228-1G

EN ISO 4144



Inch	DN	ØA mm	L mm	Art. no.	4308 (304)	4408 (316)
1/8"	6	15,2	17,0	TB25	○	●
1/4"	8	19,7	18,5	TB25	○	●
3/8"	10	23,3	22,9	TB25	○	●
1/2"	15	28,0	26,8	TB25	○	●
3/4"	20	34,6	32,0	TB25	○	●
1"	25	43,6	37,5	TB25	○	●
1.1/4"	32	53,0	45,9	TB25	○	●
1.1/2"	40	58,0	47,6	TB25	○	●
2"	50	71,0	58,0	TB25	○	●
2.1/2"	65	87,0	70,0	TB25	○	●
3"	80	100,0	77,0	TB25	○	●
4"	100	126,0	97,0	TB25	○	●

● = lager  
○ = ex works

● = stock  
○ = ex works

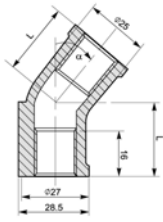

### Vinkel m. mont.platta

Elbow with bar F / F

ISO 228- 1G



Inch	DN	α	L mm	Art.no	4308 (304)	4408 (316)
1/2"	15	45°	22,8	TB15	●	●
1/2"	15	60°	25,6	TB16	●	●
1/2"	15	75°	28,5	TB17	●	●
1/2"	15	90°	27,7	TB18	●	●

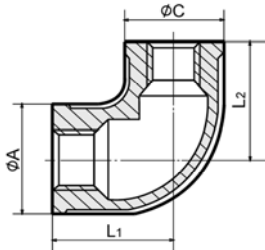

### Vinkel I/I, reducerad

Reducing elbow 90° F / F

ISO 228- 1G

EN ISO 4144



Inch	inch	DN	DN	ØA mm	ØC mm	L1 mm	L2 mm	Art. no.	4308 (304)	4408 (316)
1/4"	1/8"	8	6	19,0	15,5	18,5	18,5	TB21	○	●
3/8"	1/8"	10	6	22,5	15,5	19,5	20,5	TB21	○	●
3/8"	1/4"	8	8	22,5	19,0	20,5	22,5	TB21	○	●
1/2"	1/8"	15	6	27,5	15,5	22,5	23,5	TB21	○	●
1/2"	1/4"	15	8	27,5	19,0	24,5	24,5	TB21	○	●
1/2"	3/8"	15	10	27,5	22,5	26,5	25,5	TB21	○	●
3/4"	1/4"	20	8	33,0	19,0	27,5	26,5	TB21	○	●
3/4"	3/8"	20	10	33,0	22,5	28,5	28,5	TB21	○	●
3/4"	1/2"	20	15	33,0	27,5	29,5	30,5	TB21	○	●
1"	1/4"	25	8	40,5	19,0	28,5	30,5	TB21	○	●
1"	3/8"	25	10	40,5	22,5	30,5	32,0	TB21	○	●
1"	1/2"	25	15	40,5	27,5	32,5	33,5	TB21	○	●
1"	3/4"	25	20	40,5	33,0	34,5	35,5	TB21	○	●
1.1/4"	3/8"	32	10	50,0	22,5	34,0	36,5	TB21	○	●
1.1/4"	1/2"	32	15	50,0	27,5	36,5	38,5	TB21	○	●
1.1/4"	3/4"	32	20	50,0	33,0	38,5	40,5	TB21	○	●
1.1/4"	1"	32	25	50,0	40,5	40,5	42,5	TB21	○	●
1.1/2"	3/8"	40	10	56,5	22,5	34,0	40,0	TB21	○	●
1.1/2"	1/2"	40	15	56,5	27,5	36,0	41,5	TB21	○	●
1.1/2"	3/4"	40	20	56,5	33,0	38,5	43,5	TB21	○	●
1.1/2"	1"	40	25	56,5	40,5	41,5	45,5	TB21	○	●
1.1/2"	1.1/4"	40	32	56,5	50,0	45,5	48,5	TB21	○	●
2"	1/2"	50	15	70,0	27,5	42,0	51,5	TB21	○	●
2"	3/4"	50	20	70,0	33,0	44,0	52,5	TB21	○	●
2"	1"	50	25	70,0	40,5	46,5	53,5	TB21	○	●
2"	1.1/4"	50	32	70,0	50,0	48,5	54,5	TB21	○	●
2"	1.1/2"	50	40	70,0	56,5	52,5	55,5	TB21	○	●

● = lager  
○ = ex works

● = stock  
○ = ex works

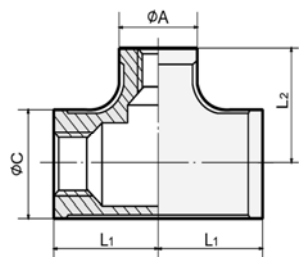

## T-rör I/I, reducerad

Reducing tee F / F / F

ISO 228-1G

EN ISO 4144



Inch	inch	DN	DN	ØA mm	ØC mm	L1 mm	L2 mm	Art. no.	4308 (304)	4408 (316)
1/4"	1/8"	8	6	17.0	21.0	18.0	19.0	TB24	○	●
3/8"	1/8"	10	6	17.0	23.0	19.0	21.0	TB24	○	●
3/8"	1/4"	8	8	21.0	23.0	20.0	22.0	TB24	○	●
1/2"	1/8"	15	6	17.0	29.0	22.0	23.0	TB24	○	●
1/2"	1/4"	15	8	20.8	29.0	24.0	24.0	TB24	○	●
1/2"	3/8"	15	10	23.5	29.0	26.0	25.0	TB24	○	●
3/4"	1/4"	20	8	20.8	36.0	25.0	28.0	TB24	○	●
3/4"	3/8"	20	10	23.3	36.0	28.0	28.0	TB24	○	●
3/4"	1/2"	20	15	30.0	37.0	30.0	32.0	TB24	○	●
1"	1/4"	25	8	20.8	44.0	30.0	31.0	TB24	○	●
1"	3/8"	25	10	23.3	44.0	30.0	31.0	TB24	○	●
1"	1/2"	25	15	30.5	44.0	32.0	33.4	TB24	○	●
1"	3/4"	25	20	35.8	44.0	35.0	35.0	TB24	○	●
1.1/4"	3/8"	32	10	23.3	51.4	32.0	36.0	TB24	○	●
1.1/4"	1/2"	32	15	28.8	51.4	34.0	38.0	TB24	○	●
1.1/4"	3/4"	32	20	35.8	51.4	38.0	40.0	TB24	○	●
1.1/4"	1"	32	25	43.3	51.4	40.0	42.0	TB24	○	●
1.1/2"	3/8"	40	10	23.3	57.9	34.0	40.0	TB24	○	●
1.1/2"	1/2"	40	15	28.8	57.9	35.0	42.0	TB24	○	●
1.1/2"	3/4"	40	20	35.8	57.9	38.0	43.0	TB24	○	●
1.1/2"	1"	40	25	43.3	57.9	41.0	45.0	TB24	○	●
1.1/2"	1.1/4"	40	32	51.4	57.9	45.0	48.0	TB24	○	●
2"	1/2"	50	15	28.8	71.0	38.0	48.0	TB24	○	●
2"	3/4"	50	20	35.8	71.0	41.0	49.0	TB24	○	●
2"	1"	50	25	43.3	71.0	44.0	51.0	TB24	○	●
2"	1.1/4"	50	32	51.4	71.0	48.0	54.0	TB24	○	●
2"	1.1/2"	50	40	57.9	71.0	52.0	55.0	TB24	○	●

● = lager  
○ = ex works

● = stock  
○ = ex works

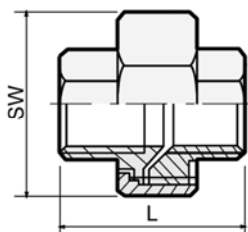

### Unionskoppling konisk tätn. I/I

Union conical F / F

ISO 228-1G

EN ISO 4144



Inch	DN	L mm	SW mm	Art. no.	4308 (304)	4408 (316)
1/8"	6	29,0	25,0	TB26	○	●
1/4"	8	37,5	30,0	TB26	●	●
3/8"	10	38,0	35,0	TB26	●	●
1/2"	15	42,0	42,0	TB26	●	●
3/4"	20	50,4	47,0	TB26	●	●
1"	25	48,0	53,0	TB26	●	●
1.1/4"	32	59,0	71,0	TB26	●	●
1.1/2"	40	65,0	78,0	TB26	●	●
2"	50	69,0	92,0	TB26	●	●
2.1/2"	65	80,0	112,0	TB26	○	●
3"	80	88,0	127,0	TB26	○	●
4"	100	108,0	157,0	TB26	○	●

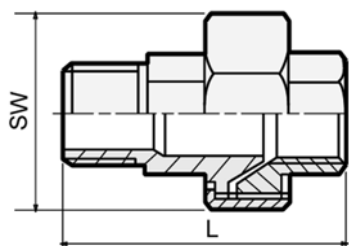

### Unionskoppling kon.tätn. I/U

Union conical M / F

ISO 8-1R / ISO 228-1G

EN ISO 4144



Inch	DN	L mm	SW mm	Art. no.	4308 (304)	4408 (316)
1/8"	6	40,0	25,0	TB28	○	●
1/4"	8	50,0	30,0	TB28	●	●
3/8"	10	50,0	35,0	TB28	●	●
1/2"	15	58,0	42,0	TB28	●	●
3/4"	20	67,0	47,0	TB28	●	●
1"	25	68,3	53,0	TB28	●	●
1.1/4"	32	83,0	71,0	TB28	●	●
1.1/2"	40	86,3	78,0	TB28	●	●
2"	50	94,0	92,0	TB28	●	●
2.1/2"	65	113,3	112,0	TB28	○	●
3"	80	127,0	126,0	TB28	○	●
4"	100	154,5	157,0	TB28	○	●

● = lager  
○ = ex works

● = stock  
○ = ex works

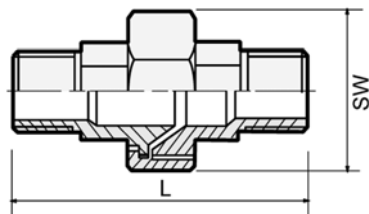

## Unionskoppling kon.tätn. U/U

Union conical M / M

ISO 8-1R

EN ISO 4144



Inch	DN	L mm	SW mm	Art. no.	4308 (304)	4408 (316)
1/8"	6	52,0	25,0	TB28	○	●
1/4"	8	61,0	30,0	TB28	○	●
3/8"	10	62,5	35,0	TB28	○	●
1/2"	15	73,0	42,0	TB28	○	●
3/4"	20	82,0	47,0	TB28	○	●
1"	25	90,0	53,0	TB28	○	●
1.1/4"	32	104,0	71,0	TB28	○	●
1.1/2"	40	109,6	78,0	TB28	○	●
2"	50	118,0	92,0	TB28	○	●
2.1/2"	65	145,0	112,0	TB28	○	●
3"	80	164,0	126,0	TB28	○	●
4"	100	205,0	157,0	TB28	○	●

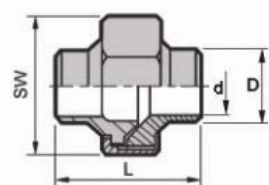

## Unionskoppling kon.tätn.Svetsansl

Union conical BW / BW

ANSI B16.25



Inch	DN	L mm	SW mm	D mm	d mm	Art. no.	4308 (304)	4408 (316)
1/8"	6	29,0	25,0	10,2	8,1	TB29	○	●
1/4"	8	35,5	30,0	13,5	10,0	TB29	●	●
3/8"	10	38,0	35,0	17,2	12,7	TB29	●	●
1/2"	15	42,0	42,0	21,3	16,7	TB29	●	●
3/4"	20	50,4	47,0	26,9	21,5	TB29	●	●
1"	25	48,0	53,0	33,7	26,5	TB29	●	●
1.1/4"	32	59,0	71,0	42,4	35,8	TB29	●	●
1.1/2"	40	64,0	78,0	48,3	42,0	TB29	●	●
2"	50	69,0	92,0	60,3	53,3	TB29	●	●
2.1/2"	65	80,0	112,0	76,1	66,5	TB29	○	●
3"	80	88,0	126,0	88,9	78,5	TB29	○	●
4"	100	108,0	157,0	114,3	104,0	TB29	○	●

● = lager  
○ = ex works

● = stock  
○ = ex works

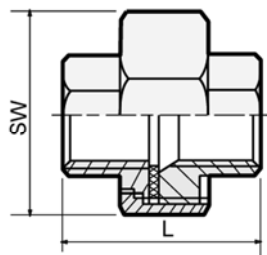

## Unionskoppling, slät I/I

Union flat F / F

ISO 228-1G

EN ISO 4144



Inch	DN	L mm	SW mm	Art. no.	4308 (304)	4408 (316)
1/8"	6	29,0	25,0	TB32	○	●
1/4"	8	37,5	30,0	TB32	●	●
3/8"	10	38,0	35,0	TB32	●	●
1/2"	15	42,0	42,0	TB32	●	●
3/4"	20	50,4	47,0	TB32	●	●
1"	25	48,0	53,0	TB32	●	●
1.1/4"	32	59,0	71,0	TB32	●	●
1.1/2"	40	65,0	78,0	TB32	●	●
2"	50	69,0	92,0	TB32	●	●
2.1/2"	65	80,0	112,0	TB32	○	●
3"	80	88,0	127,0	TB32	○	●
4"	100	108,0	157,0	TB32	○	●

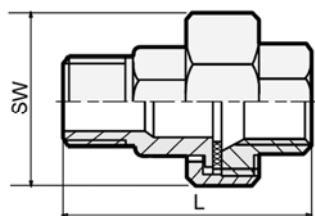

## Unionskoppling, slät U/I

Union flat M / F

ISO 8-1R / ISO 228-1G

EN ISO 4144



Inch	DN	L mm	SW mm	Art. no.	4308 (304)	4408 (316)
1/8"	6	40,0	25,0	TB33	○	●
1/4"	8	50,0	30,0	TB33	●	●
3/8"	10	50,0	35,0	TB33	●	●
1/2"	15	58,0	42,0	TB33	●	●
3/4"	20	67,0	47,0	TB33	●	●
1"	25	68,3	53,0	TB33	●	●
1.1/4"	32	83,0	71,0	TB33	●	●
1.1/2"	40	86,3	78,0	TB33	●	●
2"	50	94,0	92,0	TB33	●	●
2.1/2"	65	113,3	112,0	TB33	○	●
3"	80	127,0	126,0	TB33	○	●
4"	100	154,5	157,0	TB33	○	●

● = lager  
○ = ex works

● = stock  
○ = ex works

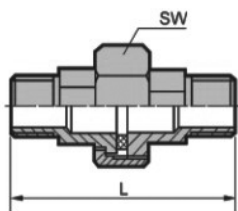

## Unionskoppling, slät U/U

Union flat M / M

ISO 8-1R

EN ISO 4144



Inch	DN	L mm	SW mm	Art. no.	4308 (304)	4408 (316)
1/8"	6	52,0	25,0	TB34	○	●
1/4"	8	61,0	30,0	TB34	○	●
3/8"	10	62,5	35,0	TB34	○	●
1/2"	15	73,0	42,0	TB34	○	●
3/4"	20	82,0	47,0	TB34	○	●
1"	25	90,0	53,0	TB34	○	●
1.1/4"	32	104,0	71,0	TB34	○	●
1.1/2"	40	109,6	78,0	TB34	○	●
2"	50	118,0	92,0	TB34	○	●
2.1/2"	65	145,0	112,0	TB34	○	●
3"	80	164,0	126,0	TB34	○	●
4"	100	205,0	157,0	TB34	○	●

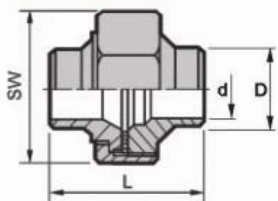

## Unionskoppling, slät. Svetsansl

Union flat BW / BW

ANSI B16.25



Inch	DN	L mm	SW mm	D mm	d mm	Art. no.	4308 (304)	4408 (316)
1/8"	6	29,0	25,0	10,2	8,1	TB35	○	●
1/4"	8	35,0	30,0	13,5	10,0	TB35	●	●
3/8"	10	38,0	35,0	17,2	12,7	TB35	●	●
1/2"	15	42,0	42,0	21,3	16,7	TB35	●	●
3/4"	20	50,4	47,0	26,9	21,5	TB35	●	●
1"	25	48,0	53,0	33,7	26,5	TB35	●	●
1.1/4"	32	59,0	71,0	42,4	35,8	TB35	●	●
1.1/2"	40	64,0	78,0	48,3	42,0	TB35	●	●
2"	50	69,0	92,0	60,3	53,3	TB35	●	●
2.1/2"	65	80,0	112,0	76,1	66,5	TB35	○	●
3"	80	88,0	126,0	88,9	78,5	TB35	○	●
4"	100	108,0	157,0	114,3	104,0	TB35	○	●

● = lager  
○ = ex works

● = stock  
○ = ex works

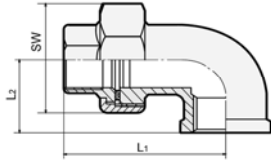

### Unionskoppling Vinkel, kon.tätn, I/I

Elbow union conical F / F

ISO 228-1G



Inch	DN	L1 mm	L2 mm	SW mm	Art. no.	4308 (304)	4408 (316)
1/8"	6	39,0	19,0	25,0	TB38	●	●
1/4"	8	46,2	21,0	30,0	TB38	●	●
3/8"	10	49,0	25,0	35,0	TB38	●	●
1/2"	15	56,0	28,0	42,0	TB38	●	●
3/4"	20	62,7	33,0	47,0	TB38	●	●
1"	25	68,0	38,0	53,0	TB38	●	●
1.1/4"	32	79,5	45,0	71,0	TB38	●	●
1.1/2"	40	88,0	50,0	78,0	TB38	●	●
2"	50	93,8	58,0	92,0	TB38	●	●

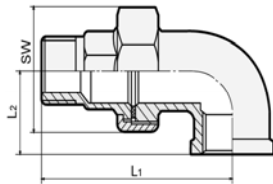

### Unionskoppling Vinkel, kon.tätn, U/I

Elbow union conical M / F

ISO 7-1R / ISO 228-1G



Inch	DN	L1 mm	L2 mm	SW mm	Art. no.	4308 (304)	4408 (316)
1/8"	6	50,7	19,0	25,0	TB39	●	●
1/4"	8	58,6	21,0	30,0	TB39	●	●
3/8"	10	61,0	25,0	35,0	TB39	●	●
1/2"	15	71,0	28,0	42,0	TB39	●	●
3/4"	20	78,7	33,0	47,0	TB39	●	●
1"	25	88,4	38,0	53,0	TB39	●	●
1.1/4"	32	102,9	45,0	71,0	TB39	●	●
1.1/2"	40	110,3	50,0	78,0	TB39	●	●
2"	50	119,4	58,0	92,0	TB39	●	●

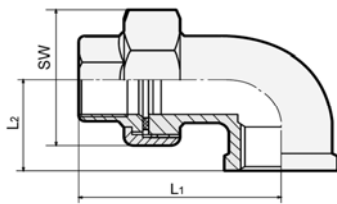

### Unionkoppling Vinkel, slät, I/I

Elbow union flat F / F

ISO 228-1G



Inch	DN	L1 mm	L2 mm	SW mm	Art. no.	4308 (304)	4408 (316)
1/8"	6	39,0	19,0	25,0	TB44	●	●
1/4"	8	46,2	21,0	30,0	TB44	●	●
3/8"	10	49,0	25,0	35,0	TB44	●	●
1/2"	15	56,0	28,0	42,0	TB44	●	●
3/4"	20	62,7	33,0	47,0	TB44	●	●
1"	25	68,0	38,0	53,0	TB44	●	●
1.1/4"	32	79,5	45,0	71,0	TB44	●	●
1.1/2"	40	88,0	50,0	78,0	TB44	●	●
2"	50	93,8	58,0	92,0	TB44	●	●

● = lager  
○ = ex works

● = stock  
○ = ex works

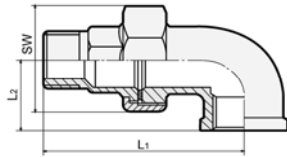

### Unionskoppling Vinkel,slät, U/I

Elbow union flat M / F  
ISO 7-1R / ISO 228-1G



Inch	DN	L1 mm	L2 mm	SW mm	Art. no.	4308 (304)	4408 (316)
1/8"	6	50,7	19,0	25,0	TB45	○	○
1/4"	8	58,6	21,0	30,0	TB45	○	○
3/8"	10	61,0	25,0	35,0	TB45	○	○
1/2"	15	71,0	28,0	42,0	TB45	○	○
3/4"	20	78,7	33,0	47,0	TB45	○	○
1"	25	88,4	38,0	53,0	TB45	○	○
1.1/4"	32	102,9	45,0	71,0	TB45	○	○
1.1/2"	40	110,3	50,0	78,0	TB45	○	○
2"	50	119,4	58,0	92,0	TB45	○	○

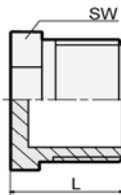

### Sexkantpropp, konisk

Hexagon head plug tapered  
ISO 8-1R  
EN ISO 4144



Inch	DN	L mm	SW mm	Art. no.	4308 (304)	4408 (316)
1/8"	6	17,0	12,0	TB50	○	●
1/4"	8	17,5	16,0	TB50	●	●
3/8"	10	18,0	20,0	TB50	●	●
1/2"	15	25,0	24,0	TB50	●	●
3/4"	20	26,0	30,0	TB50	●	●
1"	25	29,0	38,0	TB50	●	●
1.1/4"	32	35,0	46,0	TB50	●	●
1.1/2"	40	38,0	52,0	TB50	●	●
2"	50	39,0	65,0	TB50	●	●
2.1/2"	65	44,0	81,0	TB50	○	●
3"	80	54,0	94,0	TB50	○	●
4"	100	55,0	119,0	TB50	○	●

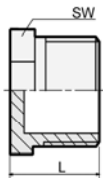

### Sexkantpropp, cylindrisk

Hexagon head plug parallel  
ISO 228  
EN ISO 4144



Inch	DN	L mm	SW mm	Art. no.	4308 (304)	4408 (316)
1/8"	6	17,0	12,0	TB51	○	●
1/4"	8	17,5	16,0	TB51	○	●
3/8"	10	18,0	20,0	TB51	○	●
1/2"	15	25,0	24,0	TB51	○	●
3/4"	20	26,0	30,0	TB51	○	●
1"	25	29,0	38,0	TB51	○	●
1.1/4"	32	35,0	46,0	TB51	○	●
1.1/2"	40	38,0	52,0	TB51	○	●
2"	50	39,0	65,0	TB51	○	●
2.1/2"	65	44,0	81,0	TB51	○	●
3"	80	54,0	94,0	TB51	○	●
4"	100	55,0	119,0	TB51	○	●

● = lager  
○ = ex works

● = stock  
○ = ex works

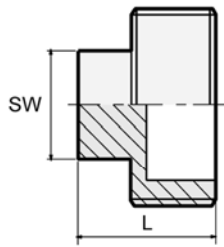

## Fyrkantpropp

Square head plug

ISO 8-1R

EN ISO 4144



Inch	DN	L mm	SW mm	Art. no.	4308 (304)	4408 (316)
1/8"	6	16,5	6,0	TB52	○	●
1/4"	8	20,0	9,0	TB52	●	●
3/8"	10	24,0	11,0	TB52	●	●
1/2"	15	25,0	13,0	TB52	●	●
3/4"	20	27,0	16,0	TB52	●	●
1"	25	32,0	20,0	TB52	●	●
1.1/4"	32	35,0	24,0	TB52	●	●
1.1/2"	40	36,0	25,0	TB52	●	●
2"	50	38,0	32,0	TB52	●	●
2.1/2"	65	48,0	42,0	TB52	○	●
3"	80	52,0	46,0	TB52	○	●
4"	100	62,0	58,0	TB52	○	●

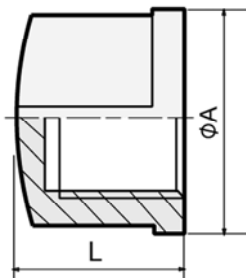

## Rund Huv

Round cap

ISO 228-1G

EN ISO 4144



Inch	DN	ØA mm	L mm	Art. no.	4308 (304)	4408 (316)
1/8"	6	18,0	15,0	TB53	○	●
1/4"	8	21,0	17,0	TB53	●	●
3/8"	10	24,0	17,0	TB53	●	●
1/2"	15	27,3	19,0	TB53	●	●
3/4"	20	35,0	24,0	TB53	●	●
1"	25	42,0	29,0	TB53	●	●
1.1/4"	32	52,0	33,0	TB53	●	●
1.1/2"	40	57,5	34,0	TB53	●	●
2"	50	69,3	38,0	TB53	●	●
2.1/2"	65	92,0	41,0	TB53	○	●
3"	80	106,0	47,0	TB53	○	●
4"	100	134,0	53,0	TB53	○	●

● = lager  
○ = ex works

● = stock  
○ = ex works

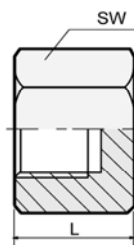

## Sexkantshuv

Hexagon cap

ISO 228-1G

EN ISO 4144



Inch	DN	L mm	SW mm	Art. no.	4308 (304)	4408 (316)
1/8"	6	13	15	TB54	●	●
1/4"	8	17	18	TB54	●	●
3/8"	10	19	21	TB54	●	●
1/2"	15	20	27	TB54	●	●
3/4"	20	24	30	TB54	●	●
1"	25	25	38	TB54	●	●
1.1/4"	32	28	50	TB54	●	●
1.1/2"	40	28	55	TB54	●	●
2"	50	34	70	TB54	●	●
2.1/2"	65	40	92	TB54	○	●
3"	80	45	109	TB54	○	●
4"	100	50	132	TB54	○	●

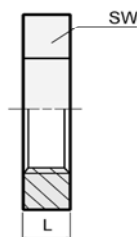

## Sexkantmutter

Hexagon nut

ISO 228-1g



Inch	DN	L mm	SW mm	Art. no.	4308 (304)	4408 (316)
1/8"	6	6,2	14,6	TB58	○	●
1/4"	8	7,0	23,0	TB58	○	●
3/8"	10	8,0	26,0	TB58	○	●
1/2"	15	10,0	31,0	TB58	○	●
3/4"	20	11,0	37,0	TB58	○	●
1"	25	10,0	46,0	TB58	○	●
1.1/4"	32	11,0	55,0	TB58	○	●
1.1/2"	40	12,0	63,0	TB58	○	●
2"	50	13,0	76,0	TB58	○	●
2.1/2"	65	16,0	95,0	TB58	○	●
3"	80	19,0	105,0	TB58	○	●
4"	100	20,0	131,0	TB58	○	●

● = lager  
○ = ex works

● = stock  
○ = ex works

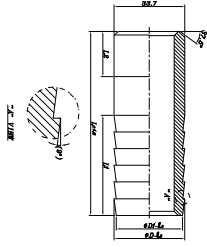

## Slangnippel SLANG / U

Hose nipple HOSE / M

ISO 8-1R



Inch	DN	D mm	D1 mm	L mm	L1 mm	L2 mm	A inch	Art. no.	304L	316L
1/8"	6	10,2	8,62	70	30,0	12	1/8"	TB56	○	●
1/4"	8	13,5	11,92	70	30,0	12	1/4"	TB56	○	●
3/8"	10	17,2	15,62	70	30,0	15	3/8"	TB56	○	●
1/2"	15	21,3	19,45	75	35,0	20	1/2"	TB56	○	●
3/4"	20	26,7	25,05	75	35,0	20	3/4"	TB56	○	●
1"	25	33,4	31,59	80	37,5	20	1"	TB56	○	●
1.1/4"	32	42,2	39,76	90	40,0	25	1.1/4"	TB56	○	●
1.1/2"	40	48,3	45,67	90	40,0	25	1.1/2"	TB56	○	●
2"	50	60,3	57,39	95	40,0	25	2"	TB56	○	●
2.1/2"	65	76,1	72,67	105	60,0	30	2.1/2"	TB56	○	●
3"	80	88,9	85,23	110	60,0	30	3"	TB56	○	●
4"	100	114,3	110,34	115	60,0	35	4"	TB56	○	●

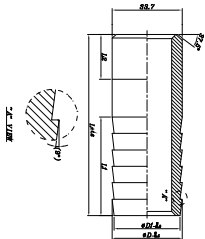

## Slangnippel SLANG / SVETS

Hose nipple HOSE / BW

ISO 8-1R



Inch	DN	D mm	D1 mm	L mm	L1 mm	L2 mm	Art. no.	304L	316L
1/8"	6	10,2	8,62	70	30,0	12	TB58	○	●
1/4"	8	13,5	11,92	70	30,0	12	TB58	○	●
3/8"	10	17,2	15,62	70	30,0	15	TB58	○	●
1/2"	15	21,3	19,45	75	35,0	20	TB58	○	●
3/4"	20	26,7	25,05	75	35,0	20	TB58	○	●
1"	25	33,4	31,59	80	37,5	20	TB58	○	●
1.1/4"	32	42,2	39,76	90	40,0	25	TB58	○	●
1.1/2"	40	48,3	45,67	90	40,0	25	TB58	○	●
2"	50	60,3	57,39	95	40,0	25	TB58	○	●
2.1/2"	65	76,1	72,67	105	60,0	30	TB58	○	●
3"	80	88,9	85,23	110	60,0	30	TB58	○	●
4"	100	114,3	110,34	115	60,0	35	TB58	○	●

● = lager  
○ = ex works

● = stock  
○ = ex works

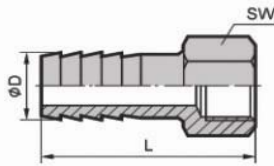

### Slangnippel Inv.

Hose nipple F

ISO 228-1G

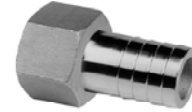

Inch	DN	ØD mm	L mm	SW mm	Art. no.	4308 (304)	4408 (316)
1/8"	6	6,50	39,0	15,00	TB58	○	●
1/4"	8	6,35	42,0	19,00	TB58	○	●
1/4"	8	7,94	42,0	19,00	TB58	○	●
3/8"	10	9,50	53,0	22,00	TB58	○	●
3/8"	10	11,00	53,0	22,00	TB58	○	●
1/2"	15	12,70	62,0	27,00	TB58	○	●
1/2"	15	14,00	62,0	27,00	TB58	○	●
3/4"	20	19,05	63,5	32,00	TB58	○	●
3/4"	20	20,50	63,5	32,00	TB58	○	●
1"	25	25,40	66,0	38,00	TB58	○	●
1"	25	27,00	66,0	38,00	TB58	○	●
1.1/4"	32	31,80	74,0	50,00	TB58	○	●
1.1/4"	32	33,00	74,0	50,00	TB58	○	●
1.1/2"	40	38,10	87,5	55,50	TB58	○	●
1.1/2"	40	39,50	87,5	55,50	TB58	○	●
2"	50	50,80	94,5	67,50	TB58	○	●
2"	50	52,00	94,5	67,50	TB58	○	●

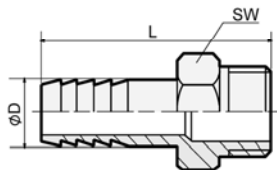

### Slangnippel Utv.

Hose nipple M

ISO 7-1R



Inch	DN	ØD mm	L mm	SW mm	Art. no.	4308 (304)	4408 (316)
1/8"	6	4,5	45,0	13,00	TB59	○	●
1/4"	8	6,3	47,0	16,50	TB59	○	●
1/4"	8	7,0	47,0	16,50	TB59	○	●
1/4"	8	9,0	47,0	16,50	TB59	○	●
1/4"	8	10,0	47,0	16,50	TB59	○	●
1/4"	8	11,0	47,0	16,50	TB59	○	●
1/4"	8	12,7	47,0	16,50	TB59	○	●
3/8"	10	6,4	55,0	20,00	TB59	○	●
3/8"	10	8,0	55,0	20,00	TB59	○	●
3/8"	10	9,5	55,0	20,00	TB59	○	●
3/8"	10	10,0	55,0	20,00	TB59	○	●
3/8"	10	11,0	55,0	20,00	TB59	○	●
3/8"	10	12,7	55,0	20,00	TB59	○	●
1/2"	15	6,3	64,0	23,50	TB59	○	●
1/2"	15	9,5	64,0	23,50	TB59	○	●
1/2"	15	10,0	64,0	23,50	TB59	○	●
1/2"	15	11,0	64,0	23,50	TB59	○	●
1/2"	15	12,7	64,0	23,50	TB59	○	●
1/2"	15	14,0	64,0	23,50	TB59	○	●
1/2"	15	19,0	64,0	23,50	TB59	○	●
3/4"	20	12,7	68,0	31,00	TB59	○	●
3/4"	20	19,1	68,0	31,00	TB59	○	●
3/4"	20	20,5	68,0	31,00	TB59	○	●

● = lager

○ = stock

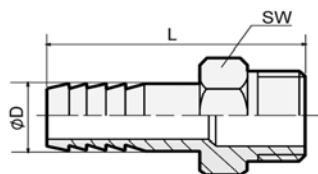

## Slangnippel Utv.

Hose nipple M

ISO 7-1R



Inch	DN	ØD mm	L mm	SW mm	Art. no.	4308 (304)	4408 (316)
1"	25	12,7	71,0	38,5	TB59	○	●
1"	25	19,0	71,0	38,5	TB59	○	●
1"	25	25,4	71,0	38,5	TB59	○	●
1"	25	27,0	71,0	38,5	TB59	○	●
1.1/4"	32	31,8	80,0	46,0	TB59	○	●
1.1/4"	32	33,0	80,0	46,0	TB59	○	●
1.1/2"	40	38,1	95,0	52,0	TB59	○	●
1.1/2"	40	39,5	95,0	52,0	TB59	○	●
2"	50	50,8	105,0	62,0	TB59	○	●
2"	50	52,0	105,0	62,0	TB59	○	●
2.1/2"	65	63,5	107,0	80,0	TB59	○	●
2.1/2"	65	67,0	107,0	80,0	TB59	○	●
3"	80	76,2	112,0	91,0	TB59	○	●
3"	80	80,0	112,0	91,0	TB59	○	●
4"	100	101,6	130,0	116,5	TB59	○	●
4"	100	105,0	130,0	116,5	TB59	○	●

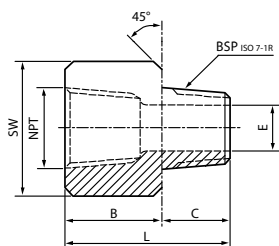

## Sexkant Adapter inv. NPT / utv. BSP

Hexagon adaptor F NPT / M BSP

ISO 228-1G / ISO 7-1R



Inch	Inch	DN	DN	B mm	C mm	E mm	L mm	SW mm	Art. no.	4308 (304)	4408 (316)
1/4"	1/4"	8	8	16,5	12,0	8,0	28,5	17,0	TB64	○	●
3/8"	3/8"	10	10	18,5	12,5	10,0	31,0	21,0	TB64	○	●
1/2"	1/2"	15	15	22,0	15,5	13,5	37,5	26,0	TB64	○	●
3/4"	3/4"	20	20	23,0	18,0	20,0	41,0	32,0	TB64	○	●
1"	1"	25	25	26,0	20,0	26,0	46,0	38,0	TB64	○	●
1.1/4"	1.1/4"	32	32	27,0	22,0	33,0	49,0	46,0	TB64	○	●
1.1/2"	1.1/2"	40	40	28,0	23,0	39,0	51,0	54,0	TB64	○	●
2"	2"	50	50	30,0	25,5	52,0	55,5	63,0	TB64	○	●

- = lager
- = ex works

- = stock
- = ex works

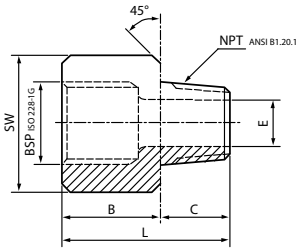

## Sexkant Adapter inv. BSP / utv. NPT

Hexagon adaptor F BSP / M NPT

ISO 228-1G / ISO 7-1R



Inch	Inch	DN	DN	B mm	C mm	E mm	L mm	SW mm	Art. no.	4308 (304)	4408 (316)
1/4"	1/4"	8	8	16,5	12	8,0	28,5	17,0	TB64	●	●
3/8"	3/8"	10	10	18,5	12,5	10,0	31	21,0	TB64	●	●
1/2"	1/2"	15	15	22,0	15,5	13,5	37,5	26,0	TB64	●	●
3/4"	3/4"	20	20	23,0	18	20,0	41	32,0	TB64	●	●
1"	1"	25	25	26,0	20	26,0	46	38,0	TB64	●	●
1.1/4"	1.1/4"	32	32	27,0	22	33,0	49	46,0	TB64	●	●
1.1/2"	1.1/2"	40	40	28,0	23	39,0	51	54,0	TB64	●	●
2"	2"	50	50	30,0	25,5	52,0	55,5	63,0	TB64	●	●

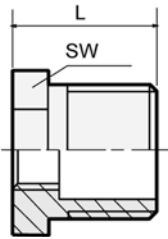

## Bussning U/I

Hexagon bushing M / F

ISO 7-1R / ISO 228-1G

EN ISO 4144



Inch	Inch	DN	DN	L mm	SW mm	Art. no.	4308 (304)	4408 (316)
1/4"	1/8"	8	6	15,2	16	TB60	●	●
3/8"	1/8"	10	6	16,5	18	TB60	●	●
3/8"	1/4"	10	8	16,5	18	TB60	●	●
1/2"	1/8"	15	6	21,0	26	TB60	○	●
1/2"	1/4"	15	8	21,0	26	TB60	●	●
1/2"	3/8"	15	10	21,0	26	TB60	●	●
3/4"	1/8"	20	6	24,0	30	TB60	○	●
3/4"	1/4"	20	8	24,0	30	TB60	●	●
3/4"	3/8"	20	10	24,0	30	TB60	●	●
3/4"	1/2"	20	15	24,0	30	TB60	●	●
1"	1/4"	25	8	27,0	35	TB60	○	●
1"	3/8"	25	10	27,0	35	TB60	●	●
1"	1/2"	25	15	27,0	35	TB60	●	●
1"	3/4"	25	20	27,0	35	TB60	●	●
1.1/4"	1/2"	32	15	30,0	45	TB60	○	●
1.1/4"	3/4"	32	20	30,0	45	TB60	●	●
1.1/4"	1"	32	25	30,0	45	TB60	●	●
1.1/2"	1/2"	40	15	38,0	52	TB60	○	●
1.1/2"	3/4"	40	20	38,0	52	TB60	○	●
1.1/2"	1"	40	25	38,0	52	TB60	●	●
1.1/2"	1.1/4"	40	32	38,0	52	TB60	●	●
2"	1/2"	50	15	36,0	63	TB60	○	●
2"	3/4"	50	20	36,0	63	TB60	○	●
2"	1"	50	25	36,0	63	TB60	●	●
2"	1.1/4"	50	32	36,0	63	TB60	●	●
2"	1.1/2"	50	40	36,0	63	TB60	●	●

● = lager  
○ = ex works

● = stock  
○ = ex works

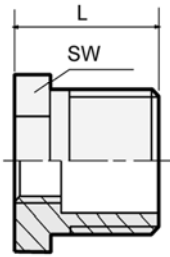

## Bussning U/I

Hexagon bushing M / F

ISO 7-1R / ISO 228-1G

EN ISO 4144



Inch	Inch	DN	DN	L mm	SW mm	Art. no.	4308 (304)	4408 (316)
2.1/2"	1"	65	25	45,0	81	TB60	○	●
2.1/2"	1.1/2"	65	40	45,0	81	TB60	○	●
2.1/2"	2"	65	50	45,0	81	TB60	○	●
3"	1.1/2"	80	40	47,0	95	TB60	○	●
3"	2"	80	50	47,0	95	TB60	○	●
3"	2.1/2"	80	65	47,0	95	TB60	○	●
4"	2"	100	50	52,0	120	TB60	○	●
4"	2.1/2"	100	65	52,0	120	TB60	○	●
4"	3"	100	80	52,0	120	TB60	○	●

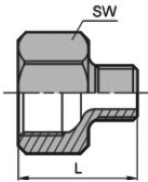

## 6 kt. Nippelmuff negativ I/U

Hexagon negative bushing M / F

ISO 228-1G / ISO 7-1R



Inch	Inch	DN	DN	L mm	SW mm	Art. no.	4308 (304)	4408 (316)
1/4"	1/8"	8	6	27,0	17	TB61	○	●
3/8"	1/8"	10	6	29,0	21	TB61	○	●
3/8"	1/4"	10	8	30,5	21	TB61	○	●
1/2"	1/8"	15	6	32,5	26	TB61	○	●
1/2"	1/4"	15	8	34,0	26	TB61	○	●
1/2"	3/8"	15	10	34,5	26	TB61	○	●
3/4"	1/8"	20	6	33,5	32	TB61	○	●
3/4"	1/4"	20	8	35,0	32	TB61	○	●
3/4"	3/8"	20	10	35,5	32	TB61	○	●
3/4"	1/2"	20	15	38,5	32	TB61	○	●
1"	1/8"	25	6	36,5	38	TB61	○	●
1"	1/4"	25	8	38,0	38	TB61	○	●
1"	3/8"	25	10	38,5	38	TB61	○	●
1"	1/2"	25	15	41,0	38	TB61	○	●
1"	3/4"	25	20	44,0	38	TB61	○	●
1.1/4"	1/4"	32	8	40,0	50	TB61	○	●
1.1/4"	3/8"	32	10	40,0	50	TB61	○	●
1.1/4"	1/2"	32	15	42,5	50	TB61	○	●
1.1/4"	3/4"	32	20	45,0	50	TB61	○	●
1.1/4"	1"	32	25	47,0	50	TB61	○	●
1.1/2"	1/4"	40	8	41,0	54	TB61	○	●
1.1/2"	3/8"	40	10	42,0	54	TB61	○	●
1.1/2"	1/2"	40	15	45,0	54	TB61	○	●
1.1/2"	3/4"	40	20	46,0	54	TB61	○	●
1.1/2"	1"	40	25	48,0	54	TB61	○	●
1.1/2"	1.1/4"	40	32	50,0	54	TB61	○	●

● = lager  
○ = ex works

● = stock  
○ = ex works

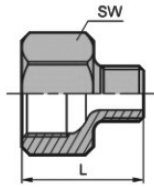

## 6 kt. Nippelmuff negativ I/U

Hexagon negative bushing M / F

ISO 228-1G / ISO 7-1R



Inch	Inch	DN	DN	L mm	SW mm	Art. no.	4308 (304)	4408 (316)
2"	1/4"	50	8	44,5	68	TB61	○	●
2"	3/8"	50	10	31,0	68	TB61	○	●
2"	1/2"	50	15	49,0	68	TB61	○	●
2"	3/4"	50	20	51,0	68	TB61	○	●
2"	1"	50	25	51,0	68	TB61	○	●
2"	1.1/4"	50	32	53,0	68	TB61	○	●
2"	1,1/2"	50	40	54,0	68	TB61	○	●

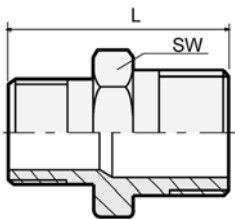

## Bussning, U/U, reducerad

Hexagon red nipple M / M

ISO 7-1R

EN ISO 4144



Inch	Inch	DN	DN	L mm	SW mm	Art. no.	4308 (304)	4408 (316)
1/4"	1/8"	8	6	34,0	18,0	TB62	●	●
3/8"	1/8"	10	6	35,0	21,0	TB62	○	●
3/8"	1/4"	10	8	34,0	21,0	TB62	●	●
1/2"	1/8"	15	6	34,0	26,0	TB62	○	●
1/2"	1/4"	15	8	34,0	26,0	TB62	●	●
1/2"	3/8"	15	10	41,0	26,0	TB62	●	●
3/4"	1/8"	20	6	37,0	30,0	TB62	○	●
3/4"	1/4"	20	8	37,0	30,0	TB62	●	●
3/4"	3/8"	20	10	37,0	30,0	TB62	●	●
3/4"	1/2"	20	15	45,0	30,0	TB62	●	●
1"	1/8"	25	6	39,0	35,0	TB62	○	●
1"	1/4"	25	8	39,0	35,0	TB62	○	●
1"	3/8"	25	10	40,0	35,0	TB62	●	●
1"	1/2"	25	15	43,2	35,0	TB62	●	●
1"	3/4"	25	20	50,0	37,0	TB62	●	●
1.1/4"	1/2"	32	15	48,0	46,0	TB62	○	●
1.1/4"	3/4"	32	20	52,0	46,0	TB62	○	●
1.1/4"	1"	32	25	54,0	46,0	TB62	●	●
1.1/2"	1/2"	40	15	49,0	50,0	TB62	○	●
1.1/2"	3/4"	40	20	53,0	50,0	TB62	○	●
1.1/2"	1"	40	25	53,0	50,0	TB62	●	●
1.1/2"	1.1/4"	40	32	59,0	50,0	TB62	●	●
2"	1/2"	50	15	52,0	63,0	TB62	○	●
2"	3/4"	50	20	56,0	63,0	TB62	○	●
2"	1"	50	25	57,0	63,0	TB62	●	●
2"	1.1/4"	50	32	58,0	63,0	TB62	●	●
2"	1,1/2"	50	40	65,4	64,0	TB62	●	●
2.1/2"	1"	65	25	63,0	80,0	TB62	○	●
2.1/2"	1.1/2"	65	40	66,0	80,0	TB62	○	●
2.1/2"	2"	65	50	77,0	76,3	TB62	○	●

● = lager

● = stock

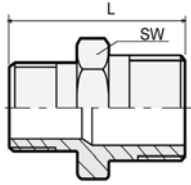

### Bussning, U/U, reducerad

Hexagon red nipple M / M

ISO 7-1R

EN ISO 4144



Inch	Inch	DN	DN	L mm	SW mm	Art. no.	4308 (304)	4408 (316)
3"	1.1/2"	80	40	72,0	95,0	TB62	○	●
3"	2"	80	50	74,0	95,0	TB62	○	●
3"	2.1/2"	80	65	84,0	95,0	TB62	○	●
4"	2"	100	50	82,0	125,0	TB62	○	●
4"	2.1/2"	100	65	82,0	125,0	TB62	○	●
4"	3"	100	80	94,0	117,4	TB62	○	●

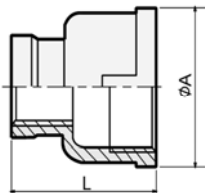

### Muff, I/I, reducerad

Reducing socket F / F

ISO 228-1G

EN ISO 4144



Inch	Inch	DN	DN	L mm	ØA	Art. no.	4308 (304)	4408 (316)
1/4"	1/8"	8	6	26,0	21,5	TB63	○	●
3/8"	1/8"	10	6	28,3	22,6	TB63	○	●
3/8"	1/4"	10	8	29,0	26,0	TB63	○	●
1/2"	1/8"	15	6	34,0	29,0	TB63	○	●
1/2"	1/4"	15	8	34,0	29,0	TB63	○	●
1/2"	3/8"	15	10	34,0	29,0	TB63	○	●
3/4"	1/4"	20	8	38,0	36,7	TB63	○	●
3/4"	3/8"	20	10	38,0	36,7	TB63	○	●
3/4"	1/2"	20	15	37,0	37,0	TB63	○	●
1"	1/4"	25	8	42,0	43,0	TB63	○	●
1"	3/8"	25	10	42,0	43,0	TB63	○	●
1"	1/2"	25	15	42,0	43,0	TB63	○	●
1"	3/4"	25	20	42,0	43,0	TB63	○	●
1.1/4"	1/2"	32	15	48,0	52,0	TB63	○	●
1.1/4"	3/4"	32	20	48,0	52,0	TB63	○	●
1.1/4"	1"	32	25	52,0	52,5	TB63	○	●
1.1/2"	1/2"	40	15	51,0	59,0	TB63	○	●
1.1/2"	3/4"	40	20	49,0	59,0	TB63	○	●
1.1/2"	1"	40	25	53,0	59,0	TB63	○	●
1.1/2"	1.1/4"	40	32	53,0	59,0	TB63	○	●
2"	1/2"	50	15	50,5	72,0	TB63	○	●
2"	3/4"	50	20	50,5	72,0	TB63	○	●
2"	1"	50	25	56,0	72,0	TB63	○	●
2"	1.1/4"	50	32	56,0	72,0	TB63	○	●
2"	1.1/2"	50	40	57,0	72,0	TB63	○	●
2.1/2"	1"	65	25	60,0	87,0	TB63	○	●
2.1/2"	1.1/2"	65	40	60,0	85,0	TB63	○	●
2.1/2"	2"	65	50	61,0	85,0	TB63	○	●
3"	1.1/2"	80	40	62,0	100,0	TB63	○	●
3"	2"	80	50	62,0	100,0	TB63	○	●
3"	2.1/2"	80	65	62,0	100,0	TB63	○	●
4"	2"	100	50	65,0	129,0	TB63	○	●
4"	2.1/2"	100	65	65,0	128,0	TB63	○	●
4"	3"	100	80	65,0	128,0	TB63	○	●

● = lager  
○ = ex works

● = stock  
○ = ex works

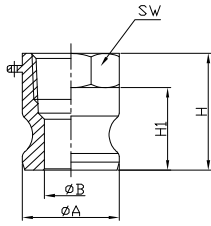

## A adapter Inv.gänga

A Adapter female thread

ISO 228-1G

MIL-C-27487 ASTM-F1122



Inch	DN	ØA mm	ØB mm	H mm	H1 mm	SW	Art. no.	CF8 (304)	316 (316)
1/2"	15	24,3	14,4	38,0	25,0	25,5	TQ10	○	●
3/4"	20	32,0	21,2	38,0	28,0	33,0	TQ10	○	●
1"	25	36,7	23,8	46,5	33,5	41,0	TQ10	○	●
1.1/4"	32	45,5	28,6	55,0	40,0	48,0	TQ10	○	●
1.1/2"	40	53,4	36,0	58,5	42,5	56,0	TQ10	○	●
2"	50	63,0	45,5	62,3	47,5	67,5	TQ10	○	●
2.1/2"	65	75,7	56,4	68,0	50,0	83,0	TQ10	○	●
3"	80	91,5	73,5	70,0	51,0	96,5	TQ10	○	●
4"	100	119,5	100,0	76,0	53,0	124,0	TQ10	○	●

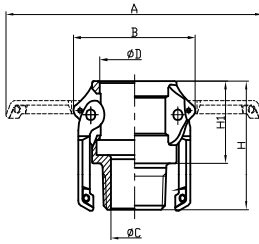

## B Koppling Utv. Gänga

B Coupler male thread

ISO 7-1R

MIL-C-27487 ASTM-F1122



Inch	DN	A mm	B mm	ØC mm	ØD mm	H1 mm	H mm	Art. no.	CF8 (304)	316 (316)
1/2"	15	107	48,7	14,8	25,1	31,0	48	TQ11	○	●
3/4"	20	115	57,0	21,2	32,4	30,0	49	TQ11	○	●
1"	25	137	65,6	25,0	37,3	39,0	61	TQ11	○	●
1.1/4"	32	183	77,0	28,0	46	46,0	68	TQ11	○	●
1.1/2"	40	191	85,0	39,0	54	48,0	70,5	TQ11	○	●
2"	50	201	96,0	50,0	63,7	53,0	78,7	TQ11	○	●
2.1/2"	65	213	110,4	58,0	76,5	58,0	86	TQ11	○	●
3"	80	267	133,0	73,2	92,2	58,0	89	TQ11	○	●
4"	100	296	166,0	97,0	120,2	63,0	97	TQ11	○	●

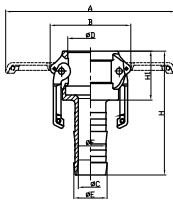

## C Koppling slangansl

C Coupler hose shank

MIL-C-27487 ASTM-F1122



Inch	DN	A mm	B mm	ØC mm	ØD mm	ØE mm	ØF mm	H1 mm	H mm	Art. no.	CF8 (304)	316 (316)
1/2"	15	107	48,7	8,0	25,1	15,0	13	31	72,0	TQ12	○	●
3/4"	20	115	57,0	13,6	32,4	20,7	19,4	30	80,0	TQ12	○	●
1"	25	137	65,6	20,0	37,3	27,0	25,8	39	99,0	TQ12	○	●
1.1/4"	32	183	77,0	25,8	46	33,9	32,9	46	110,0	TQ12	○	●
1.1/2"	40	191	85,0	31,3	54	40,5	38,6	48	114,0	TQ12	○	●
2"	50	201	96,0	43,8	63,7	52,0	51	53	129,0	TQ12	○	●
2.1/2"	65	213	110,4	55,7	76,5	66,8	-	58	151,0	TQ12	○	●
3"	80	267	133,0	68,0	92,2	79,0	-	58	160,0	TQ12	○	●
4"	100	296	166,0	92,0	120,2	104,8	-	63	176,0	TQ12	○	●

● = lager  
○ = ex works

● = stock  
○ = ex works

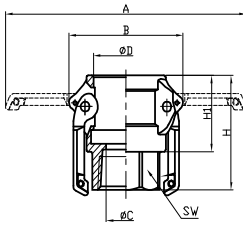

## D Koppling inv. gänga

D Coupler female thread

ISO 228-1G

MIL-C-27487 ASTM-F1122



Inch	DN	A mm	B mm	ØC mm	ØD mm	H1 mm	H mm	SW	Art. no.	CF8 (304)	316 (316)
1/2"	15	107	48,7	17,4	25,1	31,0	49	25,5	TQ13	○	●
3/4"	20	115	57,0	20,0	32,4	30,0	50	32,0	TQ13	○	●
1"	25	137	65,6	26,0	37,3	39,0	60	38,5	TQ13	○	●
1.1/4"	32	183	77,0	34,5	46	46,0	66	48,0	TQ13	○	●
1.1/2"	40	191	85,0	40,0	54	48,0	70,5	55,5	TQ13	○	●
2"	50	201	96,0	50,0	63,7	53,0	76	67,0	TQ13	○	●
2.1/2"	65	213	110,4	61,0	76,5	58,0	82	82,0	TQ13	○	●
3"	80	267	133,0	75,0	92,2	58,0	86	94,2	TQ13	○	●
4"	100	296	166,0	100,0	120,2	63,0	92	127,0	TQ13	○	●

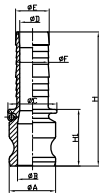

## E adapter slangansl

E Adapter hose shank

MIL-C-27487 ASTM-F1122



Inch	DN	ØA mm	ØB mm	ØC mm	ØD mm	ØE mm	ØF mm	H1	H mm	Art. no.	CF8 (304)	316 (316)
1/2"	15	24,3	14,4	30,0	8,0	15,0	13	35	76,0	TQ14	○	●
3/4"	20	32,0	21,2	33,0	13,6	20,7	19,4	37	87,0	TQ14	○	●
1"	25	36,7	23,8	39,0	20,0	27,0	25,8	44	104,0	TQ14	○	●
1.1/4"	32	45,5	28,6	48,0	25,8	33,9	32,9	51	115,0	TQ14	○	●
1.1/2"	40	53,4	36,0	56,0	31,3	40,5	38,6	52	118,0	TQ14	○	●
2"	50	63,0	45,5	66,0	43,8	52,0	51	56	132,0	TQ14	○	●
2.1/2"	65	75,7	55,7	80,0	55,7	66,8	-	64	156,0	TQ14	○	●
3"	80	91,5	73,2	101,0	68,0	79,0	-	66	169,0	TQ14	○	●
4"	100	119,5	91,0	130,0	92,0	104,8	-	68	180,0	TQ14	○	●

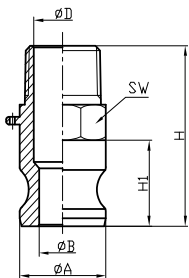

## F adapter Utv.gänga

F Adapter male thread

ISO 7-1R

MIL-C-27487 ASTM-F1122



Inch	DN	ØA mm	ØB mm	ØD mm	H1 mm	H mm	SW	Art. no.	CF8 (304)	316 (316)
1/2"	15	24,3	14,4	14,4	25	56	25,5	TQ15	○	●
3/4"	20	32,0	21,2	21,2	28	56	33,0	TQ15	○	●
1"	25	36,7	23,8	23,8	33,5	69	41,0	TQ15	○	●
1.1/4"	32	45,5	28,6	33,0	40	77	48,0	TQ15	○	●
1.1/2"	40	53,4	36,0	39,6	42,5	80	56,0	TQ15	○	●
2"	50	63,0	45,5	50,0	47,5	89	65,0	TQ15	○	●
2.1/2"	65	75,7	56,4	56,4	50	98	82,5	TQ15	○	●
3"	80	91,5	73,2	77,5	51	101	95,8	TQ15	○	●
4"	100	119,5	100,0	100,0	53	114	124,0	TQ15	○	●

● = lager  
○ = ex works

● = stock  
○ = ex works

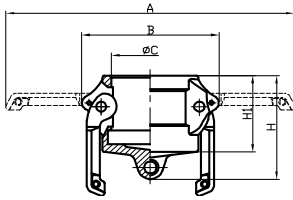

## DC Dammskyddslock

DC Dust cap

MIL-C-27487 ASTM-F1122



Inch	DN	A mm	B mm	ØC mm	H1 mm	H mm	Art. no.	CF8 (304)	316 (316)
1/2"	15	107,0	48,7	25,1	30	40	TQ16	○	●
3/4"	20	115,0	57,0	32,4	30	40	TQ16	○	●
1"	25	137,0	65,6	37,3	39	53	TQ16	○	●
1.1/4"	32	183,0	77,0	46,0	46	61	TQ16	○	●
1.1/2"	40	191,0	85,0	54,0	48	64	TQ16	○	●
2"	50	201,0	96,0	63,7	53	68	TQ16	○	●
2.1/2"	65	213,0	110,4	76,5	58	82	TQ16	○	●
3"	80	267,0	133,0	92,2	58	83	TQ16	○	●
4"	100	296,0	166,0	120,2	63	93	TQ16	○	●

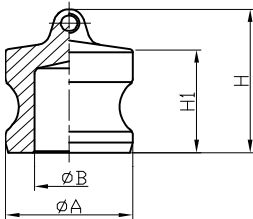

## DP Dammskyddsplugg

DP Dust Plug

MIL-C-27487 ASTM-F1122



Inch	DN	ØA mm	ØB mm	H1	H	Art. no.	CF8 (304)	316 (316)
1/2"	15	24,3	14,4	26,0	35,0	TQ17	○	●
3/4"	20	32,0	21,2	25,0	36,0	TQ17	○	●
1"	25	36,7	23,8	30,5	44,5	TQ17	○	●
1.1/4"	32	45,5	28,6	37,7	52,7	TQ17	○	●
1.1/2"	40	53,4	36,0	38,7	53,7	TQ17	○	●
2"	50	63,0	45,5	42,8	57,8	TQ17	○	●
2.1/2"	65	75,7	56,4	46,0	71,0	TQ17	○	●
3"	80	91,5	73,2	46,0	76,0	TQ17	○	●
4"	100	119,5	100,0	50,0	120,0	TQ17	○	●

● = lager  
○ = ex works

● = stock  
○ = ex works